



**Day-Brite® Lighting**

*Arioso®*



day-brite lighting



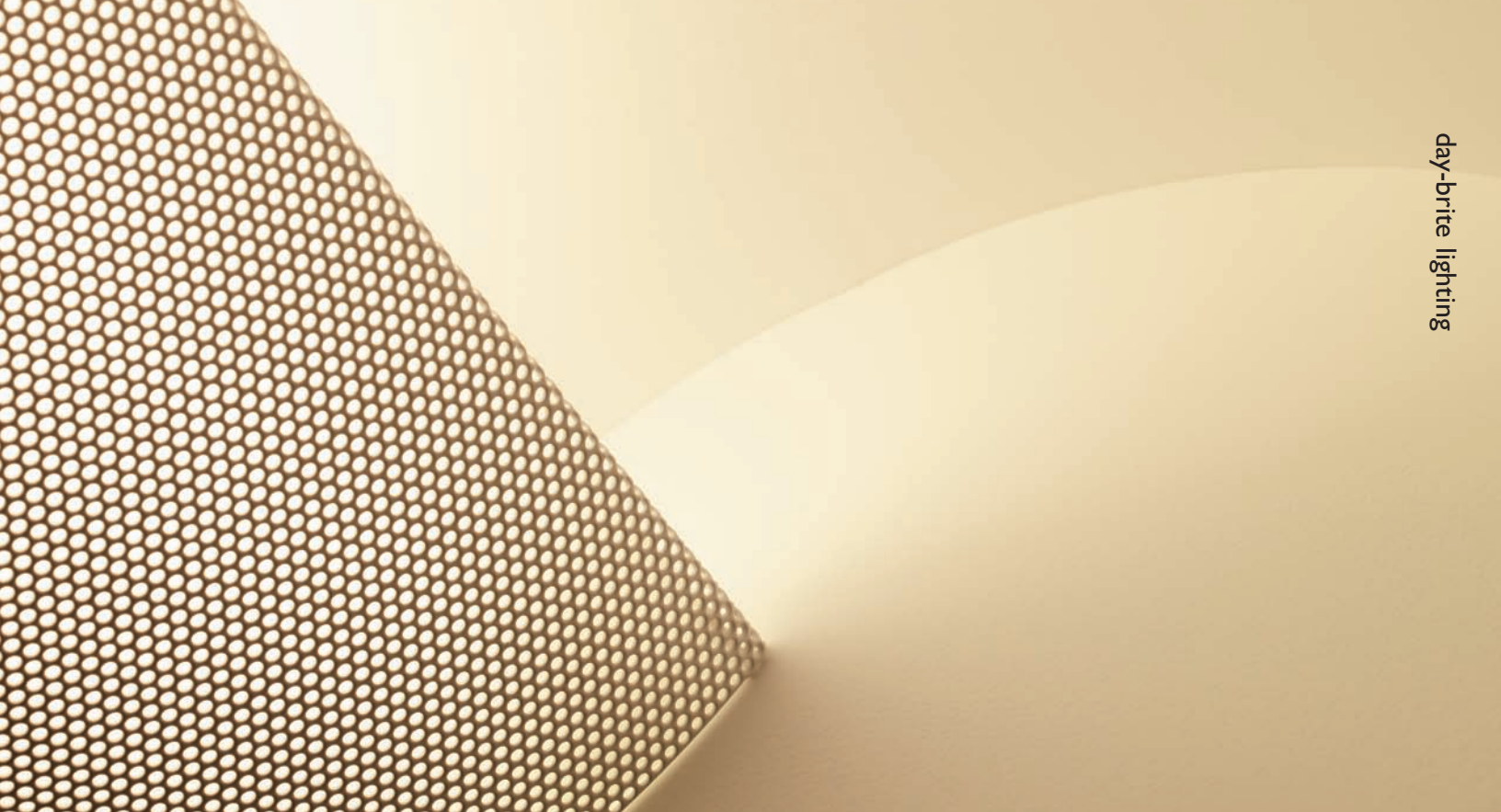

Today, interior lighting requires solutions that can enrich and enhance our lives in ways that are inspired by our natural environment. By offering soft, comfortable, visual appeal and rich details, textures and options, Arioso merges this organic quality of light with style and breadth of offering to create solutions that enhance our interior experience.

Arioso offers an array of features that create inspired solutions to enhance the quality of our indoor living.



Arioso creates a soft unassuming glow that emulates the qualities of natural lighting, significantly enriching our environment. By offering a broad range of lamping and shielding options, Arioso can be tailored to many different applications while keeping a cohesive holistic approach to the overall design.

Arioso is ideal for lobbies, open offices, classrooms, and corridors.

Arioso provides lighting solutions to enrich our lives, not complicate them.









day-brite lighting



Many of today's applications have more challenging requirements than the typical 9'-0" office application. Whether the space has a higher ceiling with strong vertical footcandle requirements such as studios or health clubs, or low or inaccessible ceilings common in older facilities, Ariosio has the lighting solution.

Ariosio offers the ideal lamp and louver combination to meet any application requirements.

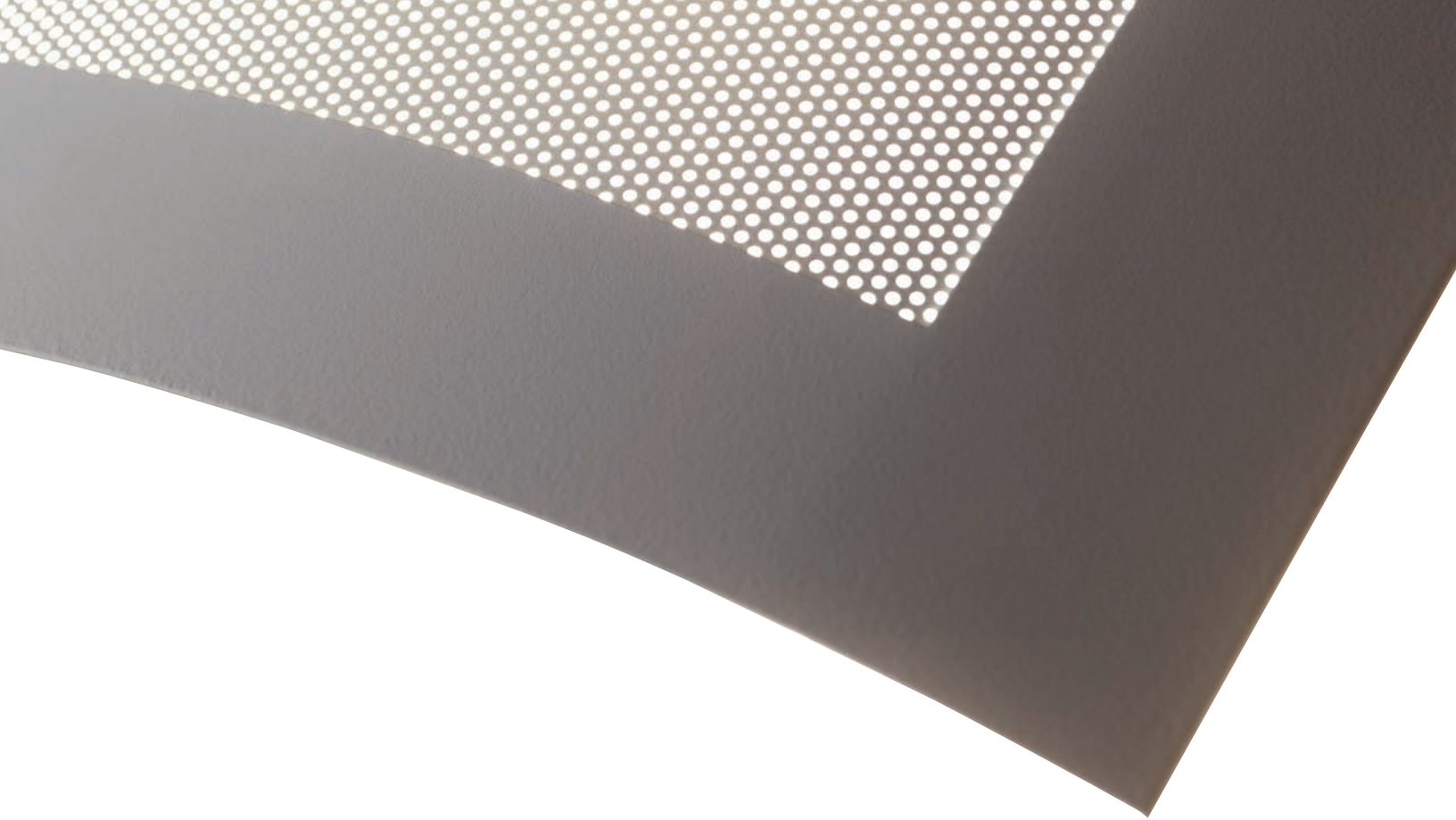

Arioso is a family of products offering a wide breadth of architectural features - multiple materials, enclosure, louvers, mounting configurations, etc. Stunning new textures and materials such as brushed metal, frosted glass, perforated steel, and opal acrylic provide creative solutions for a signature effect. Choose the appropriate product to contribute inspiring stylized details that advance the design concept and enhance the natural properties of the space.

With stunning new textures and materials, Arioso provides creative solutions for a signature effect.





Arioso Core . . . pages 14-28



Recessed 14



Side Basket 16



Split Basket 18



Acrylic 20

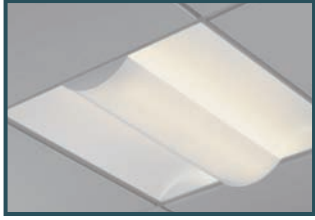

Semi-Recessed 22



Mid-Depth Semi-Recessed 24

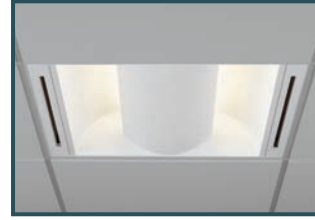

Air Handling 26



Asymmetric 28

Arioso Sensations . . . pages 32-42

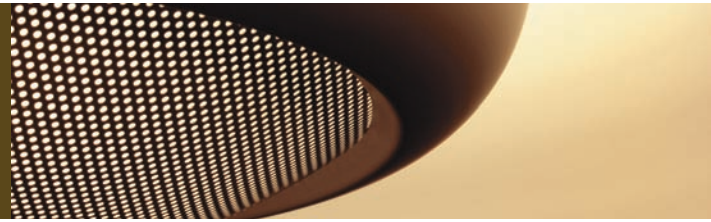

Louver 32



Metal 34



Metal Louver 36



Essence Perf 38



Essence Glass 38



Cloud 40



Orb 42

day-brite lighting



Arioso Reliefs . . . pages 46-60



Surface 46



Floating Frame 48



Sconce 50



Split Basket Sconce 52



Essence Sconce 54



Cloud Sconce 56



Square Sconce 58



Wall 60

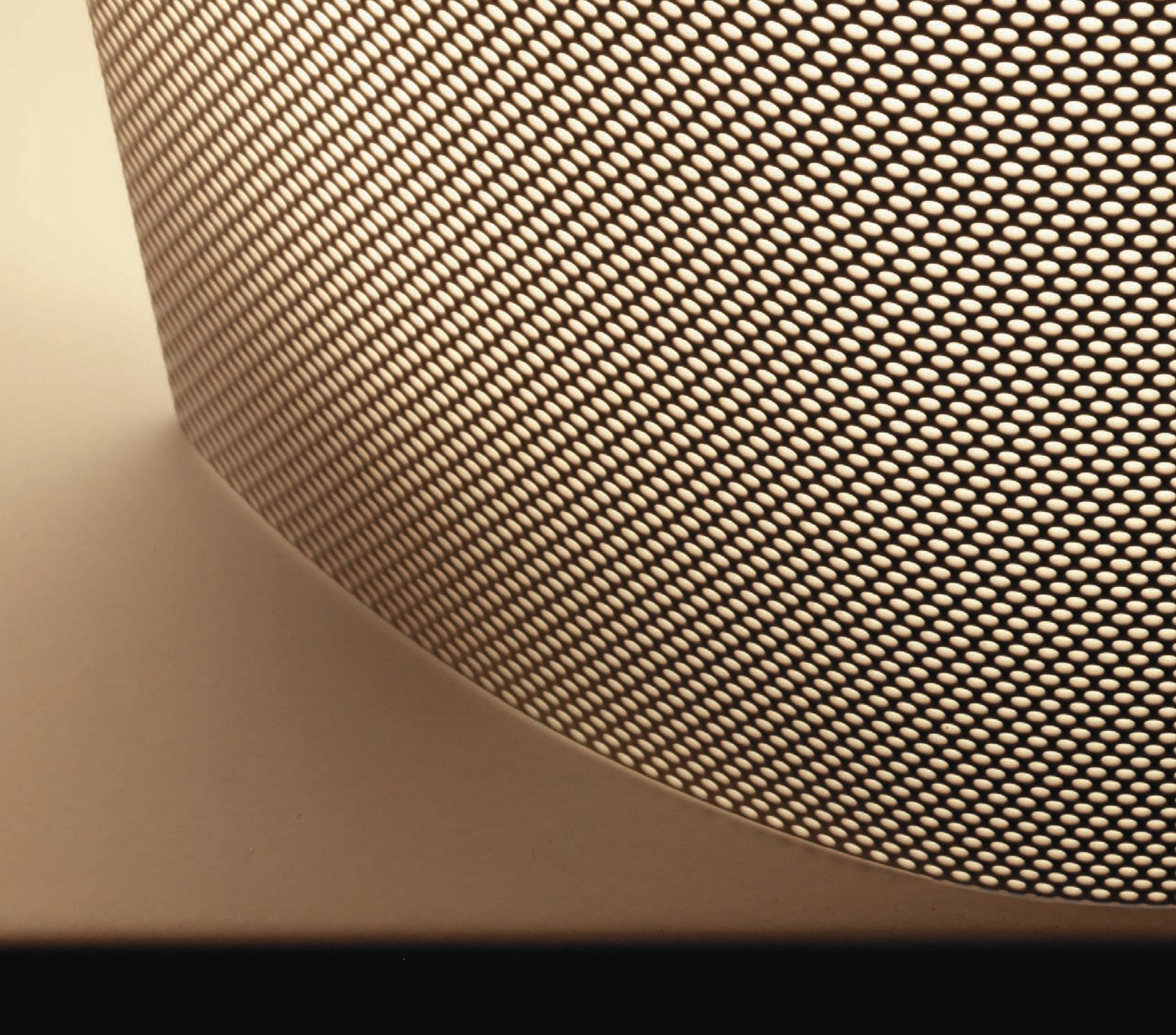

# Arioso Core



The Arioso Core series is composed of the luminaires which represent Arioso in its purest form. With micro-perforated baskets and contoured seamless reflectors, this series focuses on providing smooth comfortable lighting while subtly complementing the space.

# Arioso Core - Recessed

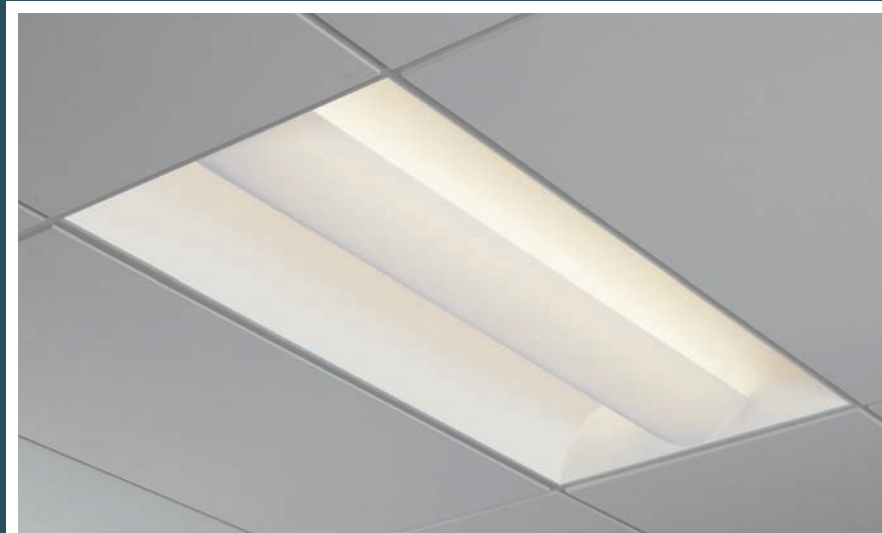

## photometry

2AVG232-PMW-1/2-EB - 2x4 perforated with white overlay, 2 lamp 32W T8

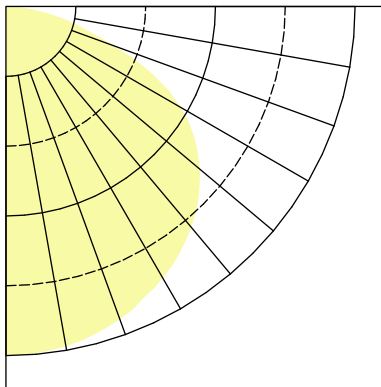

Maintained Illumination Table - Sq. Ft. / Luminaire

Room Width Room Height	2x4 2 Lamp T8				
	Approx. Area (sq. ft) per luminaire	30ft-c	50ft-c	70ft-c	100ft-c
5	102	61	44	31	
2	68	41	-	-	
1	49	-	-	-	

80-50-20 Reflectances (Ceiling-Wall-Floor)  
LLF = 0.75 2850 Lumens/Lamp very clean  
Room width divided by room height = 5 or more, 2 or 1

## Reference Information

Efficiency	68.6%
Spacing to Mounting Height	1.3

## Light Distribution

Degrees	Lumens	% Lamp	% Fixture
0-30	1011	17.7	25.9
0-40	1671	29.3	42.7
0-60	3042	53.4	77.8
0-90	3912	68.6	100.0

**EBSD80** - 2-lamp 54wT5HO Electronic step dimming ballast, .80 ballast factor

## ordering information

sample catalog number: 2AVG232-PMW-UNV-1/2-EB

**G**

WIDTH	CEILING TYPE	LAMP TYPE/WATTAGE	VOLTAGE	OPTIONS
1 - 1' 2 - 2'	<b>G</b> - Grid*  * Contact manufacturer's rep. for screw slot applications.	<b>14</b> - 14wT5 (22") <b>17</b> - 17wT8 (24") <b>24HO</b> - 24wT5HO (22") <b>28</b> - 28wT5 (46") <b>32</b> - 32wT8 (48") <b>54HO</b> - 54wT5HO (46") <b>CF40</b> - 40wT5 (24") <b>CF50</b> - 50wT5 (24") <b>CF55</b> - 55wT5 (24")	<b>120</b> <b>277</b> <b>347</b> <b>UNV</b> - Universal voltage, 120-277 volt	<b>1/2</b> - One 2-lamp ballast (electronic or non-standard) <b>1/3</b> - One 3-lamp ballast (electronic or non-standard) <b>1/21</b> - 2-lamp & 1-lamp ballasts (electronic or non-standard) <b>2/2</b> - Two 2-lamp ballasts (electronic or non-standard) <b>EB</b> - Electronic ballast, <20% THD <b>EB10I</b> - Electronic ballast, instant start, <10% THD <b>EB10R</b> - Electronic ballast, program rapid start, <10% THD <b>EBHE</b> - High efficiency T8 electronic ballast <b>EBSD</b> - T8 Electronic step dimming ballast <b>EBSD95</b> - T5 Electronic step dimming ballast, .95 ballast factor <b>EBSD115</b> - T5 Electronic step dimming ballast, 1.15 ballast factor <b>EBSD80</b> - 2-lamp 54wT5HO Electronic step dimming ballast, .80 ballast factor <b>EBD</b> - Electronic dimming ballast <b>E1</b> - DEB-1 emerg. ballast (T8 or CF only), 350-450 lumens (UL dry loc.) <b>E7</b> - DEB-7 emerg. ballast, 390-700 lumens (UL dry loc.) <b>E5</b> - DEB-5 emerg. ballast (T8 or CF only), 1100-1400 lumens (UL dry loc.) <b>ESST</b> - DEB-SST emerg. ballast with self test, 1100-1400 lumens (UL dry loc.) <b>F1</b> - Installed flex, 3/8" diameter, 18 gauge, 3 wire, 6' <b>F2</b> - Installed flex, 3/8" diameter, 18 gauge, 4 wire, 6' <b>GLR#</b> - Fusing, fast blow (# = number of ballasts) <b>LPT735</b> - Installed lamps, 70+ CRI, 3500K (T8 only) <b>LPT835</b> - Installed lamps, 80+ CRI, 3500K
FAMILY	NO. OF LAMPS	SHIELDING		
<b>AV</b> - Arioso <b>AVCP</b> - Chicago Plenum Model	(not included) <b>1</b> <b>2</b> <b>3</b> <b>4</b>	<b>PMW</b> - Perforated metal with white overlay		

Job pack stretch wrapped w/out cartons  
Master/Satellite wiring

day-brite lighting



## product highlights

Arioso Recessed offers simple clean lines in combination with soft natural illumination. Flexible enough to integrate with any architectural design, Arioso Recessed provides a soft unassuming glow with comfortable illumination to optimize work and recreational activities. The perforated center basket offers visual interest and detailing to complement any space.

- Microperforated basket backed with smooth white acrylic eliminates lamp image.
- Creates soft even illumination on the work-plane as well as on the vertical wall surfaces.
- Single-piece captive center enclosure swings open to provide easy relamping and ballast access.
- High efficiency lamp/ballast, bi-level switching, dimming and emergency ballasts are offered as standard options.
- Companion wall sconce available.

## cross sections

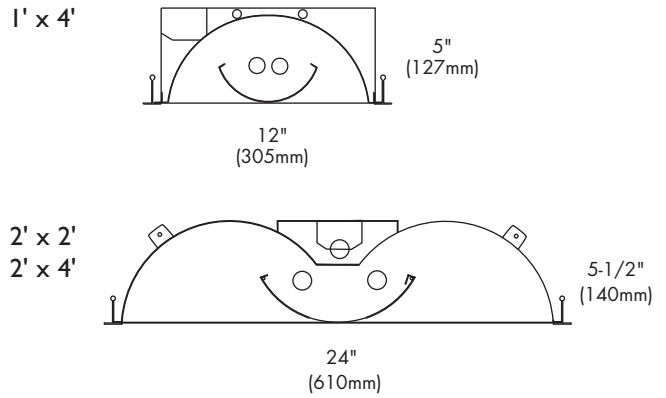

## product availability

Size	Number of Lamps	Lamp Type
1'x4'	1, 2	28, 54HO
	2	32
2'x2'	2, 3	14, 17, 24HO
	1, 2, 3	CF40, CF50, CF55
2'x4'	2, 3	28, 32, 54HO
	4	CF40, CF50, CF55

Contact manufacturer's rep. for 1'x1' applications.



# Arioso Core - Side Basket



## photometry

2AVSG232-PMW-1/2-EB - 2x4 perforated with white overlay, 2 lamp 32W T8

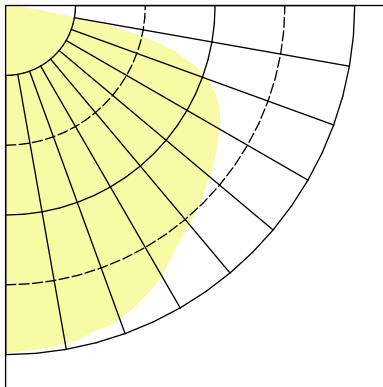

Maintained Illumination Table - Sq. Ft. / Luminaire

Room Width Room Height	2x4 2 Lamp T8			
	Approx. Area (sq. ft) per luminaire 30ft-c	50ft-c	70ft-c	100ft-c
5	82	49	35	-
2	54	32	-	-
1	115	38	-	-

80-50-20 Reflectances (Ceiling-Wall-Floor)  
LLF = 0.75 2850 Lumens/Lamp very clean  
Room width divided by room height = 5 or more, 2 or 1

### Reference Information

Efficiency	56.3%
Spacing to Mounting Height	1.3

### Light Distribution

Degrees	Lumens	% Lamp	% Fixture
0-30	742	13.0	23.1
0-40	1229	21.6	38.3
0-60	2279	40.0	71.0
0-90	3208	56.3	100.0

## ordering information

sample catalog number: 2AVSG232-PMW-UNV-1/2-EB

2	AVS	G	- PMW -		
WIDTH	FAMILY	CEILING TYPE	LAMP TYPE/WATTAGE	VOLTAGE	OPTIONS
2 - 2'	AVS - Arioso Side Basket	G - Grid* * Contact manufacturer's rep. for screw slot applications.	14 - 14wT5 (22") 17 - 17wT8 (24") 24HO - 24wT5HO (22") 28 - 28wT5 (46") 32 - 32wT8 (48") 54HO - 54wT5HO (46") CF40 - 40wTT5 (24") CF50 - 50wTT5 (24") CF55 - 55wTT5 (24")	120 277 347 UNV - Universal voltage, 120-277 volt	1/2 - One 2-lamp ballast (electronic or non-standard) 1/4 - One 4-lamp ballast (electronic or non-standard) 2/2 - Two 2-lamp ballasts (electronic or non-standard) EB - Electronic ballast, <20% THD EB10I - Electronic ballast, instant start, <10% THD EB10R - Electronic ballast, program rapid start, <10% THD EBHE - High efficiency T8 electronic ballast EBSD - T8 Electronic step dimming ballast EBSD95 - T5 Electronic step dimming ballast, .95 ballast factor EBSD115 - T5 Electronic step dimming ballast, 1.15 ballast factor EBSD80 - 2-lamp 54wT5HO Electronic step dimming ballast, .80 ballast factor EBD - Electronic dimming ballast E1 - DEB-1 emerg. ballast (T8 or CF only), 350-450 lumens (UL dry loc.) E7 - DEB-7 emerg. ballast, 390-700 lumens (UL dry loc.) E5 - DEB-5 emerg. ballast (T8 or CF only), 1100-1400 lumens (UL dry loc.) ES5T - DEB-5ST emerg. ballast with self test, 1100-1400 lumens (UL dry loc.) F1 - Installed flex, 3/8" diameter, 18 gauge, 3 wire, 6' F2 - Installed flex, 3/8" diameter, 18 gauge, 4 wire, 6' GLR# - Fusing, fast blow (# = number of ballasts) LPT735 - Installed lamps, 70+ CRI, 3500K (T8 only) LPT835 - Installed lamps, 80+ CRI, 3500K
			NO. OF LAMPS (not included) 2 4	SHIELDING PMW - Perforated metal with white overlay	

Job pack stretch wrapped w/out cartons  
Master/Satellite wiring

day-brite lighting



## product highlights

Arioso Side Basket offers a distinctive approach with the emphasis on the overall integrated look of the ceiling rather than on the luminaire itself. Increasing the perceived volume of a space, Arioso Side Basket is ideal for lower ceilings & smaller spaces such as private offices & break out areas. It provides balanced illumination to work within any architectural style.

- Microperforated basket backed with smooth white acrylic eliminates lamp image.
- Creates soft even illumination on the work-plane as well as on the vertical wall surfaces.
- Easy relamping and ballast access.
- High efficiency lamp/ballast, bi-level switching, dimming and emergency ballasts are offered as standard options.

## cross sections

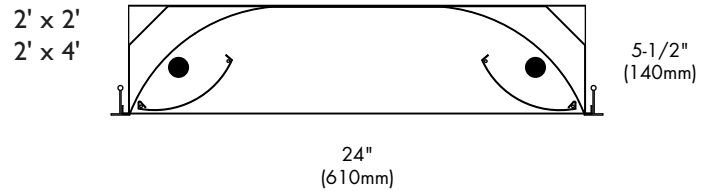

day-brite lighting

## product availability

Size	Lamps/ Cross Section	Lamps/ Fixture	Lamp Type
2'x2'	2 2, 4	2 2, 4	CF40, CF50, CF55 14, 17, 24HO
2'x4'	2, 4	2, 4	28, 32, 54HO

# Arioso Core - Split Basket

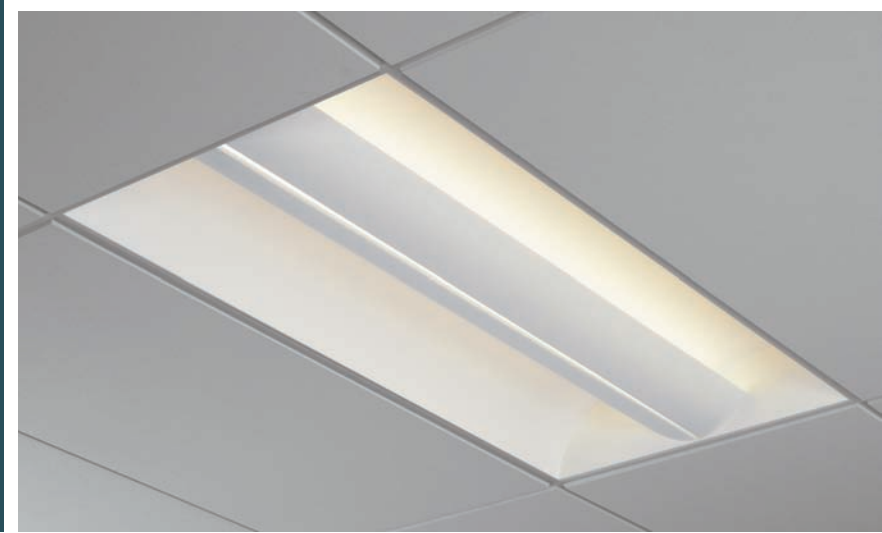
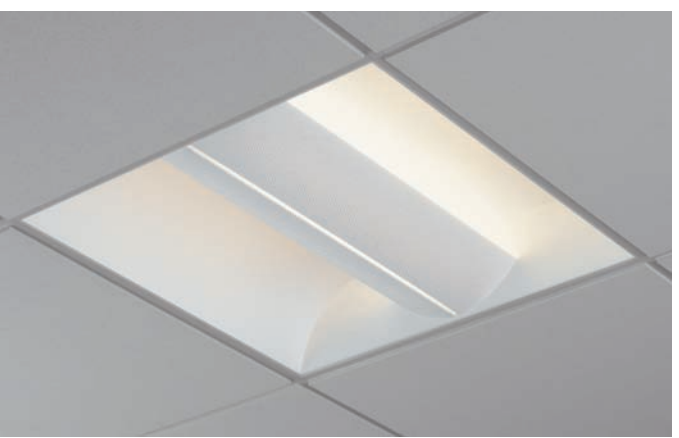

## photometry

2AVG232-SPMW-1/2-EB - 2x4 perforated with white overlay, 2 lamp 32W T8

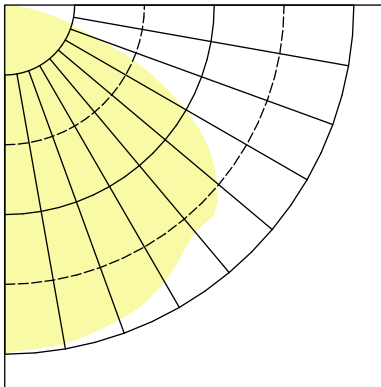

Maintained Illumination Table - Sq. Ft. / Luminaire

Room Width Room Height	2x4 2 Lamp T8				
	Approx. Area (sq. ft) per luminaire	30ft-c	50ft-c	70ft-c	100ft-c
5	86	52	37	-	-
2	57	34	-	-	-
1	41	-	-	-	-

80-50-20 Reflectances (Ceiling-Wall-Floor)  
LLF = 0.75 2850 Lumens/Lamp very clean  
Room width divided by room height = 5 or more, 2 or 1

### Reference Information

Efficiency	58.0%
Spacing to Mounting Height	1.4

### Light Distribution

Degrees	Lumens	% Lamp	% Fixture
0-30	819	14.4	24.8
0-40	1362	23.9	41.2
0-60	2547	44.7	77.1
0-90	3304	58.0	100.0

## ordering information

sample catalog number: 2AVG232-SPMW-UNV-1/2-EB

**G**

**- SPMW -**

### WIDTH

- 1 - 1'
- 2 - 2'

### CEILING TYPE

- G** - Grid\*
- \* Contact manufacturer's rep. for screw slot applications.

### LAMP TYPE/WATTAGE

- 14** - 14wT5 (22")
- 17** - 17wT8 (24")
- 24HO** - 24wT5HO (22")
- 28** - 28wT5 (46")
- 32** - 32wT8 (48")
- 54HO** - 54wT5HO (46")
- CF40** - 40wTT5 (24")
- CF50** - 50wTT5 (24")
- CF55** - 55wTT5 (24")

### VOLTAGE

- 120**
- 277**
- 347**
- UNV** - Universal voltage, 120-277 volt

### OPTIONS

- 1/2** - One 2-lamp ballast (electronic or non-standard)
- 1/3** - One 3-lamp ballast (electronic or non-standard)
- 1/21** - 2-lamp & 1-lamp ballasts (electronic or non-standard)
- 2/2** - Two 2-lamp ballasts (electronic or non-standard)
- EB** - Electronic ballast, <20% THD
- EB10I** - Electronic ballast, instant start, <10% THD
- EB10R** - Electronic ballast, program rapid start, <10% THD
- EBHE** - High efficiency T8 electronic ballast
- EBSD** - T8 Electronic step dimming ballast
- EBSD95** - T5 Electronic step dimming ballast, .95 ballast factor
- EBSD115** - T5 Electronic step dimming ballast, 1.15 ballast factor
- EBSD80** - 2-lamp 54wT5HO Electronic step dimming ballast, .80 ballast factor
- EBD** - Electronic dimming ballast
- E1** - DEB-1 emerg. ballast (T8 or CF only), 350-450 lumens (UL dry loc.)
- E7** - DEB-7 emerg. ballast, 390-700 lumens (UL dry loc.)
- E5** - DEB-5 emerg. ballast (T8 or CF only), 1100-1400 lumens (UL dry loc.)
- ESST** - DEB-SST emerg. ballast with self test, 1100-1400 lumens (UL dry loc.)
- F1** - Installed flex, 3/8" diameter, 18 gauge, 3 wire, 6'
- F2** - Installed flex, 3/8" diameter, 18 gauge, 4 wire, 6'
- GLR#** - Fusing, fast blow (# = number of ballasts)
- LPT735** - Installed lamps, 70+ CRI, 3500K (T8 only)
- LPT835** - Installed lamps, 80+ CRI, 3500K

### FAMILY

- AV** - Arioso
- AVCP** - Chicago Plenum Model

### NO. OF LAMPS

- (not included)
- 1**
- 2**
- 3**
- 4**

### SHIELDING

- SPMW** - Two-piece perforated metal with white overlays

day-brite lighting

Job pack stretch wrapped w/out cartons  
Master/Satellite wiring



## product highlights

For that added visual appeal, Arioso Split Basket adds fresh style & detailing to the standard Arioso basket. Used alone or as an accent in combination with the standard recessed basket, Arioso Split Basket highlights the individuality of the space, both in function and design without creating distracting glare or unnecessary contrast.

- Microperforated basket backed with smooth white acrylic eliminates lamp image.
- Creates soft even illumination on the work-plane as well as on the vertical wall surfaces.
- Captive center enclosures swing open to provide easy relamping and ballast access.
- High efficiency lamp/ballast, bi-level switching, dimming and emergency ballasts are offered as standard options.
- Companion wall sconce available.

## cross sections

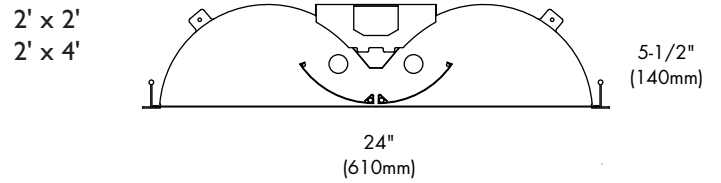
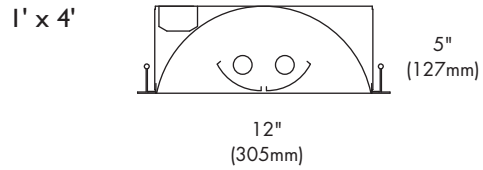

## product availability

Size	Number of Lamps	Lamp Type
1'x4'	1, 2	28, 54HO
	2	32
2'x2'	2, 3	14, 17, 24HO
	1, 2, 3	CF40, CF50, CF55
2'x4'	2, 3	28, 32, 54HO
	4	CF40, CF50, CF55



# Arioso Core - Acrylic

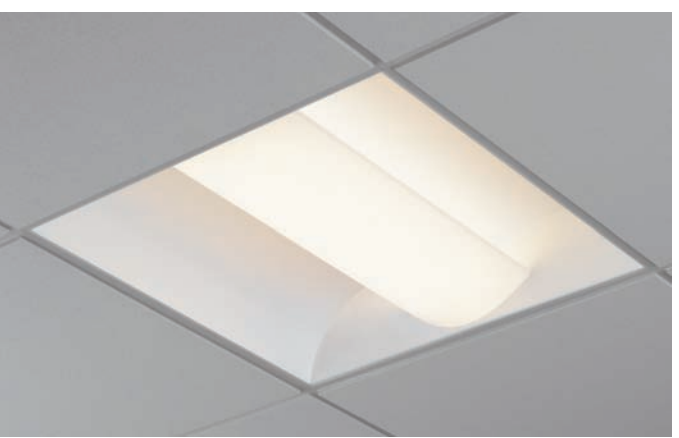

## photometry

2AVG232-ACR-1/2-EB - 2x4 with white opal acrylic diffuser, 2 lamp 32W T8

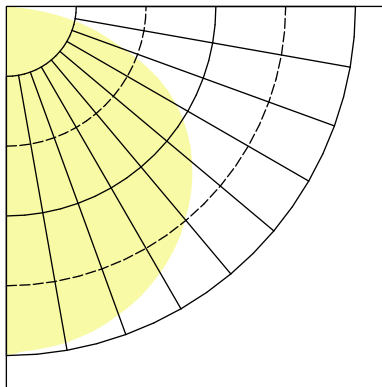

Maintained Illumination Table - Sq. Ft. / Luminaire

Room Width Room Height	2x4 2 Lamp T8			
	Approx. Area (sq. ft) per luminaire 30ft-c	50ft-c	70ft-c	100ft-c
5	118	71	50	35
2	78	47	34	-
1	57	34	-	-

80-50-20 Reflectances (Ceiling-Wall-Floor)  
LLF = 0.75 2850 Lumens/Lamp very clean  
Room width divided by room height = 5 or more, 2 or 1

### Reference Information

Efficiency	80.0%
Spacing to Mounting Height	1.3

### Light Distribution

Degrees	Lumens	% Lamp	% Fixture
0-30	1130	19.8	24.8
0-40	1874	32.9	41.1
0-60	3437	60.3	75.4
0-90	4559	80.0	100.0

## ordering information

sample catalog number: 2AVG232-ACR-UNV-1/2-EB

**G**

WIDTH	CEILING TYPE	LAMP TYPE/WATTAGE	VOLTAGE	OPTIONS
1 - 1' 2 - 2'	<b>G</b> - Grid*  * Contact manufacturer's rep. for screw slot applications.	<b>14</b> - 14wT5 (22") <b>17</b> - 17wT8 (24") <b>24HO</b> - 24wT5HO (22") <b>28</b> - 28wT5 (46") <b>32</b> - 32wT8 (48") <b>54HO</b> - 54wT5HO (46") <b>CF40</b> - 40wTT5 (24") <b>CF50</b> - 50wTT5 (24") <b>CF55</b> - 55wTT5 (24")	<b>120</b> <b>277</b> <b>347</b> <b>UNV</b> - Universal voltage, 120-277 volt	<b>1/2</b> - One 2-lamp ballast (electronic or non-standard) <b>1/3</b> - One 3-lamp ballast (electronic or non-standard) <b>1/21</b> - 2-lamp & 1-lamp ballasts (electronic or non-standard) <b>2/2</b> - Two 2-lamp ballasts (electronic or non-standard) <b>EB</b> - Electronic ballast, <20% THD <b>EB10I</b> - Electronic ballast, instant start, <10% THD <b>EB10R</b> - Electronic ballast, program rapid start, <10% THD <b>EBHE</b> - High efficiency T8 electronic ballast <b>EBSD</b> - T8 Electronic step dimming ballast <b>EBSD95</b> - T5 Electronic step dimming ballast, .95 ballast factor <b>EBSD115</b> - T5 Electronic step dimming ballast, 1.15 ballast factor <b>EBSD80</b> - 2-lamp 54wT5HO Electronic step dimming ballast, .80 ballast factor <b>EBD</b> - Electronic dimming ballast <b>E1</b> - DEB-1 emerg. ballast (T8 or CF only), 350-450 lumens (UL dry loc.) <b>E7</b> - DEB-7 emerg. ballast, 390-700 lumens (UL dry loc.) <b>E5</b> - DEB-5 emerg. ballast (T8 or CF only), 1100-1400 lumens (UL dry loc.) <b>ES5T</b> - DEB-SST emerg. ballast with self test, 1100-1400 lumens (UL dry loc.) <b>F1</b> - Installed flex, 3/8" diameter, 18 gauge, 3 wire, 6' <b>F2</b> - Installed flex, 3/8" diameter, 18 gauge, 4 wire, 6' <b>GLR#</b> - Fusing, fast blow (# = number of ballasts) <b>LPT735</b> - Installed lamps, 70+ CRI, 3500K (T8 only) <b>LPT835</b> - Installed lamps, 80+ CRI, 3500K
FAMILY	NO. OF LAMPS	SHIELDING		
<b>AV</b> - Arioso <b>AVCP</b> - Chicago Plenum Model	(not included) <b>1</b> <b>2</b> <b>3</b> <b>4</b>	<b>ACR</b> - White opal acrylic diffuser		

day-brite lighting

Job pack stretch wrapped w/out cartons  
Master/Satellite wiring



## product highlights

With true clarity of design, Arioso Acrylic strips the Arioso down to its purest form where only light & shape are displayed. With these clean crisp lines and soft illumination, Arioso Acrylic emulates the qualities of natural lighting.

- White opal acrylic with high transmission combines a soft glow with high efficiency.
- Creates soft even illumination on the work-plane as well as on the vertical wall surfaces.
- Single-piece captive center enclosure swings open to provide easy relamping and ballast access.
- High efficiency lamp/ballast, bi-level switching, dimming and emergency ballasts are offered as standard options.

## cross sections

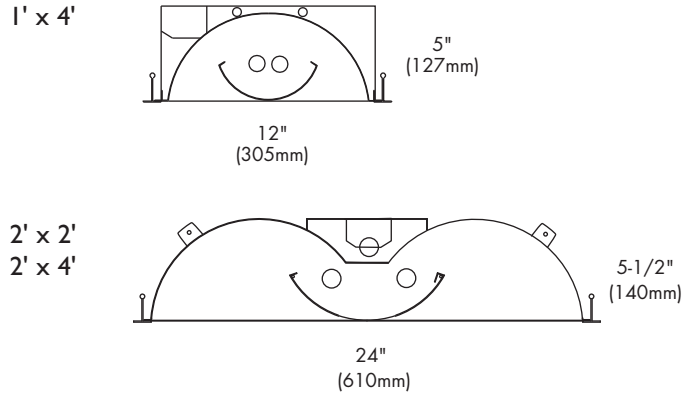

## product availability

Size	Number of Lamps	Lamp Type
1'x4'	1, 2 2	28, 54HO 32
2'x2'	2, 3 1, 2, 3	14, 17, 24HO CF40, CF50, CF55
2'x4'	2, 3 4	28, 32, 54HO CF40, CF50, CF55

# Arioso Core - Semi-Recessed

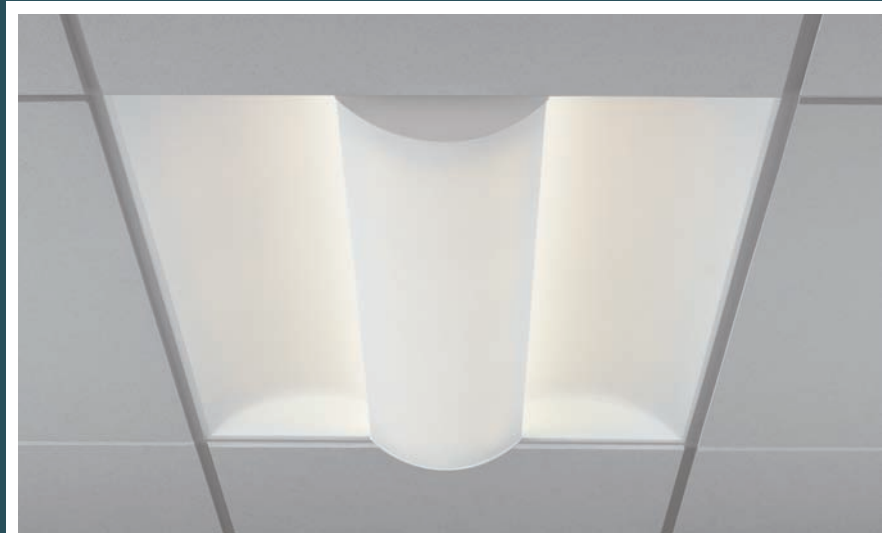

## photometry

2AVLG254HO-PMW-1/2-EB - 2x2 perforated with white overlay, 2 lamp 54W T5HO

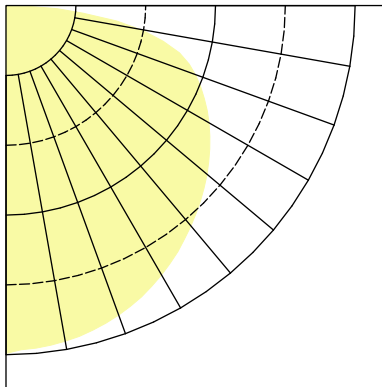

Maintained Illumination Table - Sq. Ft. / Luminaire

Room Width Room Height	2x2 2 Lamp T5HO				
	Approx. Area (sq. ft) per luminaire	30ft-c	50ft-c	70ft-c	100ft-c
5	-	97	70	49	
2	106	64	46	32	
1	77	46	33	-	

80-50-20 Reflectances (Ceiling-Wall-Floor)  
LLF = 0.89 4400 Lumens/Lamp very clean  
Room width divided by room height = 5 or more, 2 or 1

### Reference Information

Efficiency	61.6%
Spacing to Mounting Height	1.3

### Light Distribution

Degrees	Lumens	% Lamp	% Fixture
0-30	1245	14.1	22.9
0-40	2059	23.4	38.0
0-60	3787	43.0	69.8
0-90	5424	61.6	100.0

## ordering information

sample catalog number: 2AVLG2CF40-PMW-UNV-1/2-EB

<b>G</b>		<b>- PMW -</b>		<b>-</b>	
<u>WIDTH</u>	<u>CEILING TYPE</u>	<u>LAMP TYPE/WATTAGE</u>	<u>VOLTAGE</u>	<u>OPTIONS</u>	
1 - 1' 2 - 2'	<b>G</b> - Grid	<b>14</b> - 14wT5 (22") <b>24HO</b> - 24wT5HO (22") <b>28</b> - 28wT5 (46") <b>54HO</b> - 54wT5HO (46") <b>CF40</b> - 40wT5 (24") <b>CF50</b> - 50wT5 (24") <b>CF55</b> - 55wT5 (24")	<b>120</b> <b>277</b> <b>347</b> <b>UNV</b> - Universal voltage, 120-277 volt	<b>1/2</b> - One 2-lamp ballast (electronic or non-standard) <b>1/3</b> - One 3-lamp ballast (electronic or non-standard) <b>1/21</b> - 2-lamp & 1-lamp ballasts (electronic or non-standard) <b>2/2</b> - Two 2-lamp ballasts (electronic or non-standard) <b>EB</b> - Electronic ballast, <20% THD <b>EB10I</b> - Electronic ballast, instant start, <10% THD <b>EB10R</b> - Electronic ballast, program rapid start, <10% THD <b>EBSD95</b> - T5 Electronic step dimming ballast, .95 ballast factor <b>EBSD115</b> - T5 Electronic step dimming ballast, 1.15 ballast factor <b>EBSD80</b> - 2-lamp 54wT5HO Electronic step dimming ballast, .80 ballast factor <b>EBD</b> - Electronic dimming ballast <b>E1</b> - DEB-1 emerg. ballast, CF only, 350-450 lumens (UL dry loc.) <b>E7</b> - DEB-7 emerg. ballast, 390-700 lumens (UL dry loc.) <b>E5</b> - DEB-5 emerg. ballast, CF only, 900 lumens (UL dry loc.) <b>E5ST</b> - DEB-5ST emerg. ballast with self test, CF only, 1100-1400 lumens (UL dry loc.) <b>F1</b> - Installed flex, 3/8" diameter, 18 gauge, 3 wire, 6' <b>F2</b> - Installed flex, 3/8" diameter, 18 gauge, 4 wire, 6' <b>GLR#</b> - Fusing, fast blow (# = number of ballasts) <b>LPT835</b> - Installed lamps, 80+ CRI, 3500K	
<u>FAMILY</u>	<u>NO. OF LAMPS</u>	<u>SHIELDING</u>			
<b>AVL</b> - Arioso Low Profile <b>AVLCP</b> - Chicago Plenum Model	(not included) 1 2 3 4	<b>PMW</b> - Perforated metal with white overlay			

day-brite lighting



## product highlights

Arioso Semi-Recessed offers an ideal choice for spaces with low plenum clearance. Keeping the look & feel of a recessed luminaire, Arioso Semi-Recessed maintains quality illumination while minimizing clutter and protrusions from the ceiling plane.

- 2-1/4" housing depth is ideal for shallow plenum applications [1x4 model is 3-1/2" deep].
- Low profile design extends less than 2" below the ceiling plane.
- Microperforated basket backed by smooth white acrylic eliminates lamp image.
- Creates soft even illumination on the work-plane as well as on the vertical wall surfaces.
- Single-piece captive center enclosure swings open to provide easy relamping and ballast access.
- High efficiency lamp/ballast, bi-level switching, dimming and emergency ballasts are offered as standard options.
- Companion wall sconce available.

## cross sections

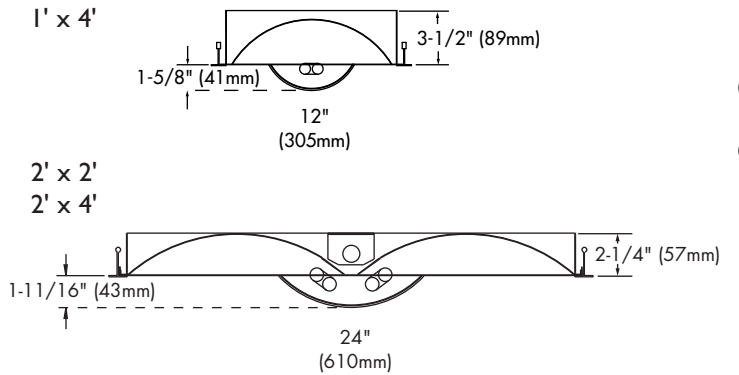

## product availability

Size	Lamps/ Cross Section	Lamps/ Fixture	Lamp Type
1'x4'	1, 2 1	1, 2 2	28, 54HO CF40, CF50, CF55
2'x2'	2, 3 1, 2	2, 3 1, 2	14, 24HO CF40, CF50, CF55
2'x4'	2, 3 1, 2	2, 3 2, 4	28, 54HO CF40, CF50, CF55

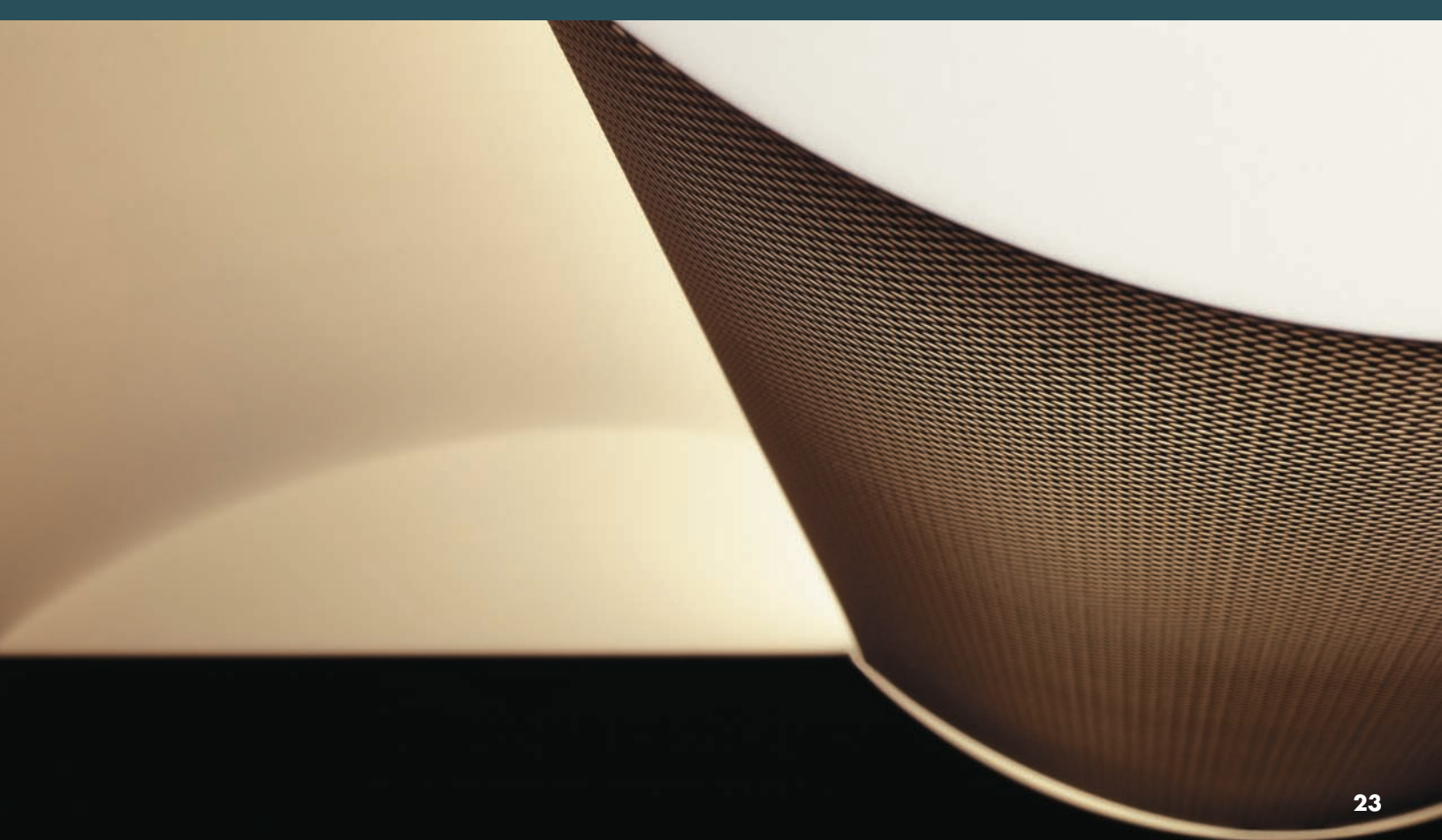

# Arioso Core - Mid-Depth Semi-Recessed

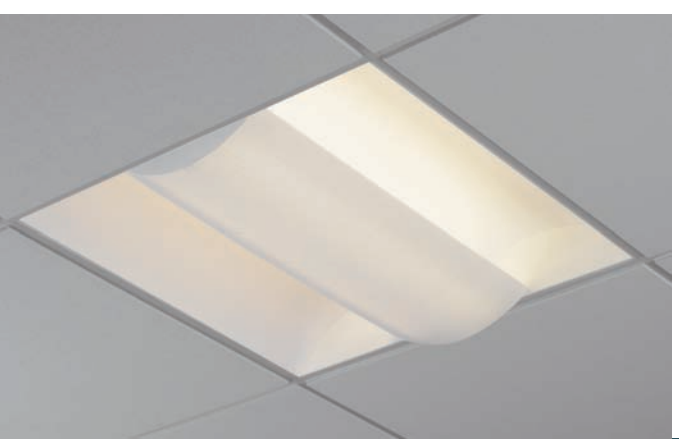

## photometry

2AVDG228-PMW-1/2-EB - 2x4 perforated with white overlay, 2 lamp 28W T5

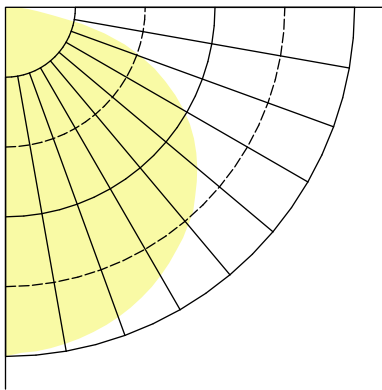

Maintained Illumination Table - Sq. Ft. / Luminaire

Room Width Room Height	2x2 2 Lamp T5			
	Approx. Area (sq. ft) per luminaire 30ft-c	50ft-c	70ft-c	100ft-c
5	126	76	54	38
2	84	50	36	-
1	61	36	-	-

80-50-20 Reflectances (Ceiling-Wall-Floor)  
LLF = 0.89 2600 Lumens/Lamp very clean  
Room width divided by room height = 5 or more, 2 or 1

### Reference Information

Efficiency	79.3%
Spacing to Mounting Height	1.3

### Light Distribution

Degrees	Lumens	% Lamp	% Fixture
0-30	1033	19.9	25.1
0-40	1709	32.9	41.5
0-60	3120	60.0	75.7
0-90)	4121	79.3	100.0

## ordering information

sample catalog number: 2AVDG228-PMW-UNV-1/2-EB

2	AVD	G	- PMW -		
WIDTH		CEILING TYPE	LAMP TYPE/WATTAGE	VOLTAGE	OPTIONS
2 - 2'		G - Grid	<b>14</b> - 14wT5 (22") <b>24HO</b> - 24wT5HO (22") <b>28</b> - 28wT5 (46") <b>54HO</b> - 54wT5HO (46") <b>CF40</b> - 40wTT5 (24") <b>CF50</b> - 50wTT5 (24") <b>CF55</b> - 55wTT5 (24")	<b>120</b> <b>277</b> <b>347</b> UNV - Universal voltage, 120-277 volt	<b>1/2</b> - One 2-lamp ballast (electronic or non-standard) <b>1/3</b> - One 3-lamp ballast (electronic or non-standard) <b>1/21</b> - 2-lamp & 1-lamp ballasts (electronic or non-standard) <b>EB</b> - Electronic ballast, <20% THD <b>EB10I</b> - Electronic ballast, instant start, <10% THD <b>EB10R</b> - Electronic ballast, program rapid start, <10% THD <b>EBSD95</b> - T5 Electronic step dimming ballast, .95 ballast factor <b>EBSD115</b> - T5 Electronic step dimming ballast, 1.15 ballast factor <b>EBSD80</b> - 2-lamp 54wT5HO Electronic step dimming ballast, .80 ballast factor <b>EBD</b> - Electronic dimming ballast <b>E1</b> - DEB-1 emerg. ballast, CF only, 350-450 lumens (UL dry loc.) <b>E7</b> - DEB-7 emerg. ballast, 390-700 lumens (UL dry loc.) <b>E5</b> - DEB-5 emerg. ballast, CF only, 900 lumens (UL dry loc.) <b>ESST</b> - DEB-5ST emerg. ballast with self test, CF only, 1100-1400 lumens (UL dry loc.) <b>F1</b> - Installed flex, 3/8" diameter, 18 gauge, 3 wire, 6' <b>F2</b> - Installed flex, 3/8" diameter, 18 gauge, 4 wire, 6' <b>GLR#</b> - Fusing, fast blow (# = number of ballasts) <b>LPT835</b> - Installed lamps, 80+ CRI, 3500K
			NO. OF LAMPS (not included) <b>2</b> <b>3</b>	SHIELDING <b>PMW</b> - Perforated metal with white overlay	
	FAMILY <b>AVD</b> - Arioso Mid-Depth Semi-Recessed				

day-brite lighting



## product highlights

Arioso Mid-Depth Semi-Recessed offers an ideal version for spaces with reduced plenum clearance. Keeping the look & feel of a recessed luminaire, this semi-recessed version combines a shallow reflector with a sleek basket shape while maintaining quality illumination and minimizing protrusions below the ceiling plane.

- 3-1/2" housing depth is ideal for reduced plenum applications.
- Basket extends less than 1-1/2" below the ceiling plane.
- Housing edge design locates the bottom of the luminaire flush with the ceiling plane in standard (NEMA G) grid or screw slot (NEMA SS) applications.
- NOT suitable for use in narrow face grid (NEMA NFG) applications.
- Microperforated basket backed with smooth white acrylic eliminates any lamp image.
- Creates soft even illumination on the workplane as well as on the vertical wall surfaces.
- Single-piece captive center enclosure swings open to provide easy relamping and ballast access.
- High efficiency lamp/ballast, bi-level switching, dimming and emergency ballasts are offered as standard options.
- Companion wall sconce available.

## cross sections

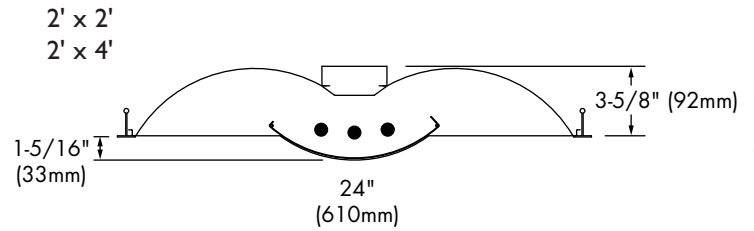

day-brite lighting

## product availability

Size	Number of Lamps	Lamp Type
2'x2'	2 2	CF40, CF50, CF55 14, 24HO
2'x4'	2, 3	28, 54HO

# Arioso Core - Air

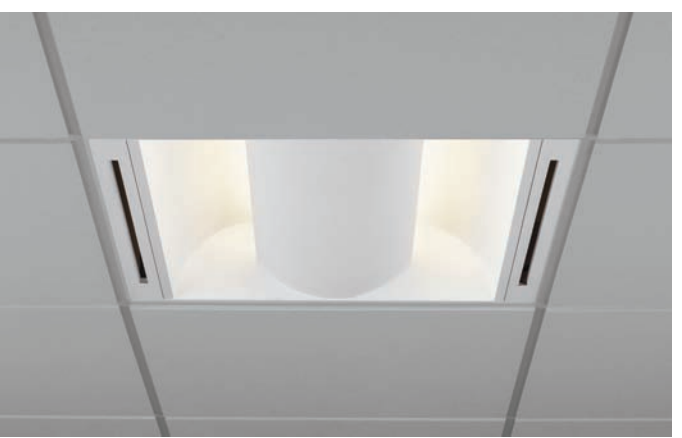

## photometry

2AVGA232-PMW-1/2-EB - 2x4 perforated with white overlay, 2 lamp 32W T8

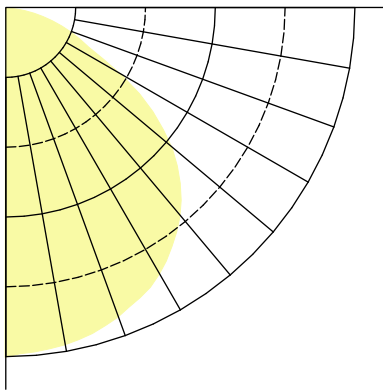

Maintained Illumination Table - Sq. Ft. / Luminaire

Room Width Room Height	2x2 2 Lamp T8			
	Approx. Area (sq. ft) per luminaire 30ft-c	50ft-c	70ft-c	100ft-c
5	86	52	37	-
2	59	35	-	-
1	43	-	-	-

80-50-20 Reflectances (Ceiling-Wall-Floor)  
LLF = 0.75 2850 Lumens/Lamp very clean  
Room width divided by room height = 5 or more, 2 or 1

## Reference Information

Efficiency	57.8%
Spacing to Mounting Height	1.3

## Light Distribution

Degrees	Lumens	% Lamp	% Fixture
0-30	911	16.0	27.6
0-40	1502	26.4	45.6
0-60	2667	46.8	80.9
0-90	3296	57.8	100.0

## ordering information

sample catalog number: 2AVGA232-PMW-UNV-1/2-EB

2	G	A		- PMW -		
WIDTH	CEILING TYPE	NO. OF LAMPS		SHIELDING	VOLTAGE	OPTIONS
2 - 2'	G - Grid	(not included) 1 2 3 4		PMW - Perforated metal with white overlay	120 277 347 UNV - Universal voltage, 120-277 volt	<b>1/2</b> - One 2-lamp ballast (electronic or non-standard) <b>1/3</b> - One 3-lamp ballast (electronic or non-standard) <b>1/21</b> - 2-lamp & 1-lamp ballasts (electronic or non-standard) <b>2/2</b> - Two 2-lamp ballasts (electronic or non-standard) <b>DOB</b> - Drop out basket <b>EB</b> - Electronic ballast, <20% THD <b>EB10I</b> - Electronic ballast, instant start, <10% THD <b>EB10R</b> - Electronic ballast, program rapid start, <10% THD <b>EBHE</b> - High efficiency T8 electronic ballast <b>EBSD</b> - T8 Electronic step dimming ballast <b>EBSD95</b> - T5 Electronic step dimming ballast, .95 ballast factor <b>EBSD115</b> - T5 Electronic step dimming ballast, 1.15 ballast factor <b>EBSD80</b> - 2-lamp 54wT5HO Electronic step dimming ballast, .80 ballast factor <b>EBD</b> - Electronic dimming ballast <b>E1</b> - DEB-1 emerg. ballast (T8 or CF only), 350-450 lumens (UL dry loc.) <b>E7</b> - DEB-7 emerg. ballast, 390-700 lumens (UL dry loc.) <b>E5</b> - DEB-5 emerg. ballast (T8 or CF only), 1100-1400 lumens (UL dry loc.) <b>E5ST</b> - DEB-5ST emerg. ballast with self test, 1100-1400 lumens (UL dry loc.) <b>F1</b> - Installed flex, 3/8" diameter, 18 gauge, 3 wire, 6' <b>F2</b> - Installed flex, 3/8" diameter, 18 gauge, 4 wire, 6' <b>GLR#</b> - Fusing, fast blow (# = number of ballasts) <b>LPT735</b> - Installed lamps, 70+ CRI, 3500K (T8 only) <b>LPT835</b> - Installed lamps, 80+ CRI, 3500K
FAMILY	AIR FUNCTION	LAMP TYPE/WATTAGE				
AV - Arioso AVCP - Chicago Plenum Model	A - Air Handling	14 - 14wT5 (22") 17 - 17wT8 (24") 24HO - 24wT5HO (22") 28 - 28wT5 (46") 32 - 32wT8 (48") 54HO - 54wT5HO (46") CF40 - 40wTT5 (24") CF50 - 50wTT5 (24") CF55 - 55wTT5 (24")				

day-brite lighting



## product highlights

Arioso Air offers air handling capabilities along with all the benefits of the Arioso Recessed series. Through integrated side slots, Arioso Air incorporates this air handling feature without disturbing the simple clean lines & soft natural illumination that is the foundation of the Arioso series. Flexible enough to integrate with any architectural design, Arioso Air provides a soft unassuming glow with comfortable illumination to optimize work and recreational activities.

- Air handling feature offered through integrated side slots.
- Microperforated basket backed with smooth white acrylic eliminates lamp image.
- Creates soft even illumination on the work-plane as well as on the vertical wall surfaces.
- Single-piece captive center enclosure swings open to provide easy relamping and ballast access.
- High efficiency lamp/ballast, bi-level switching, dimming and emergency ballasts are offered as standard options.
- Companion wall sconce available.

## cross sections

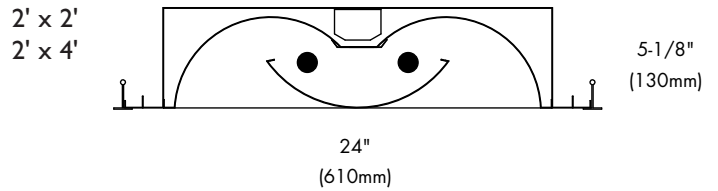

day-brite lighting

## product availability

Size	Number of Lamps	Lamp Type
2'x2'	2, 3	14, 17, 24HO
	1, 2	CF40, CF50, CF55
2'x4'	2, 3	28, 32, 54HO
	4	CF40, CF50, CF55

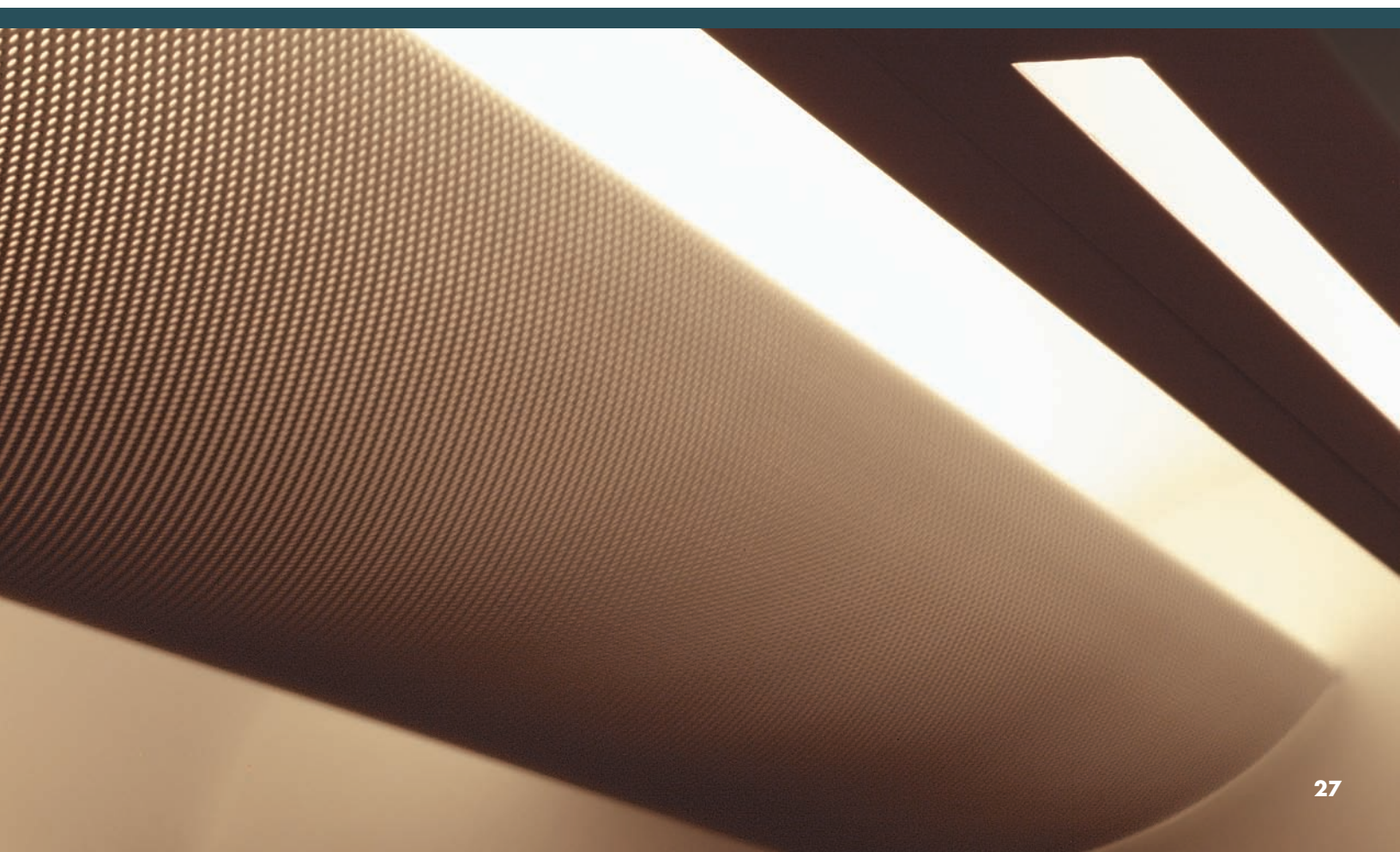

# Arioso Core - Asymmetric



## photometry

IAVAG232-PMW-1/2-EB - 1x4 perforated with white overlay, 2 lamp 32W T8

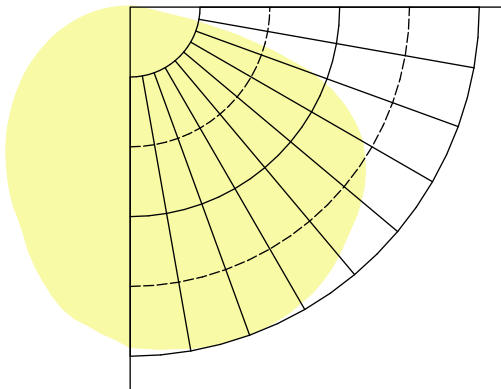

Maintained Illumination Table - Sq. Ft. / Luminaire

Room Width Room Height	2x2 2 Lamp T8			
	Approx. Area (sq. ft) per luminaire 30ft-c	50ft-c	70ft-c	100ft-c
5	85	51	37	-
2	57	34	-	-
1	41	-	-	-

Reference Information

Efficiency	57.8%
Spacing to Mounting Height	1.5

Light Distribution

Degrees	Lumens	% Lamp	% Fixture
0-30	832	14.6	25.2
0-40	1370	24.0	41.6
0-60	2493	43.7	75.6
0-90	3296	57.8	100.0

80-50-20 Reflectances (Ceiling-Wall-Floor)  
LLF = 0.75 2850 Lumens/Lamp very clean  
Room width divided by room height = 5 or more, 2 or 1

## ordering information

sample catalog number: IAVAG132-PMW-UNV-1/1-EB

1	G	- PMW -			
WIDTH	CEILING TYPE	LAMP TYPE/WATTAGE	VOLTAGE	OPTIONS	
1 - 1'	G - Grid	<b>28</b> - 28wT5 (46") <b>32</b> - 32wT8 (48") <b>54HO</b> - 54wT5HO (46") <b>CF40</b> - 40wTT5 (24") <b>CF50</b> - 50wTT5 (24") <b>CF55</b> - 55wTT5 (24")	<b>120</b> <b>277</b> <b>347</b> UNV - Universal voltage, 120-277 volt	<b>1/1</b> - One 1-lamp ballast (electronic or non-standard) <b>1/2</b> - One 2-lamp ballast (electronic or non-standard) <b>2/1</b> - Two 1-lamp ballasts (electronic or non-standard) <b>EB</b> - Electronic ballast, <20% THD <b>EB10I</b> - Electronic ballast, instant start, <10% THD <b>EB10R</b> - Electronic ballast, program rapid start, <10%THD <b>EBHE</b> - High efficiency T8 electronic ballast <b>EBSD</b> - T8 Electronic step dimming ballast <b>EBSD95</b> - T5 Electronic step dimming ballast, .95 ballast factor <b>EBSD115</b> - T5 Electronic step dimming ballast, 1.15 ballast factor <b>EBSD80</b> - 2-lamp 54wT5HO Electronic step dimming ballast, .80 ballast factor <b>EBD</b> - Electronic dimming ballast <b>E1</b> - DEB-1 emerg. ballast, T8 or CF, 350-450 lumens (UL dry loc.) <b>E7</b> - DEB-7 emerg. ballast, 390-700 lumens (UL dry loc.) <b>E5</b> - DEB-5 emerg. ballast, T8 or CF, 1100-1400 lumens (UL dry loc.) <b>ESST</b> - DEB-5ST emerg. ballast with self test, T8 or CF, 1100-1400 lumens (UL dry loc.) <b>E6</b> - DEB-6 emergency ballast, 600-1325 lumens <b>F1</b> - Installed flex, 3/8" diameter, 18 gauge, 3 wire, 6' <b>F2</b> - Installed flex, 3/8" diameter, 18 gauge, 4 wire, 6' <b>GLR#</b> - Fusing, fast blow (# = number of ballasts) <b>LPT735</b> - Installed lamps, 70+ CRI, 3500K (T8 only) <b>LPT835</b> - Installed lamps, 80+ CRI, 3500K	
	FAMILY	NO. OF LAMPS	SHIELDING		
	AVA - Arioso Asymmetric AVACP - Chicago Plenum Model	(not included) 1 2	PMW - Perforated metal with white overlay		

day-brite lighting



## product highlights

Used alone or in conjunction with symmetrical Arioso luminaires, Arioso Asymmetric evenly illuminates vertical wall surfaces. This makes the series ideal for illuminating demonstration boards in teaching facilities, vertical merchandise in retail applications and accent walls with artwork or other collectibles.

- 1x2 & 1x4 sizes available with 1 or 2 lamp configurations.
- Suitable for individual or row mounting.
- Microperforated panel backed with smooth white acrylic eliminates lamp image.
- Creates soft even illumination on the vertical wall surfaces.
- Single-piece captive enclosure swings open to provide easy relamping and ballast access.
- High efficiency lamp/ballast, bi-level switching, dimming and emergency ballasts are offered as standard options.

## cross sections

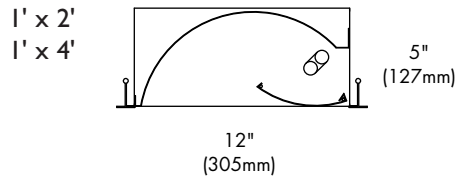

## product availability

Size	Lamps/ Cross Section	Lamps/ Fixture	Lamp Type
1'x2'	1	1	CF40, CF50, CF55
1'x4'	1, 2 1	1, 2 2	28, 32, 54HO CF40, CF50, CF55

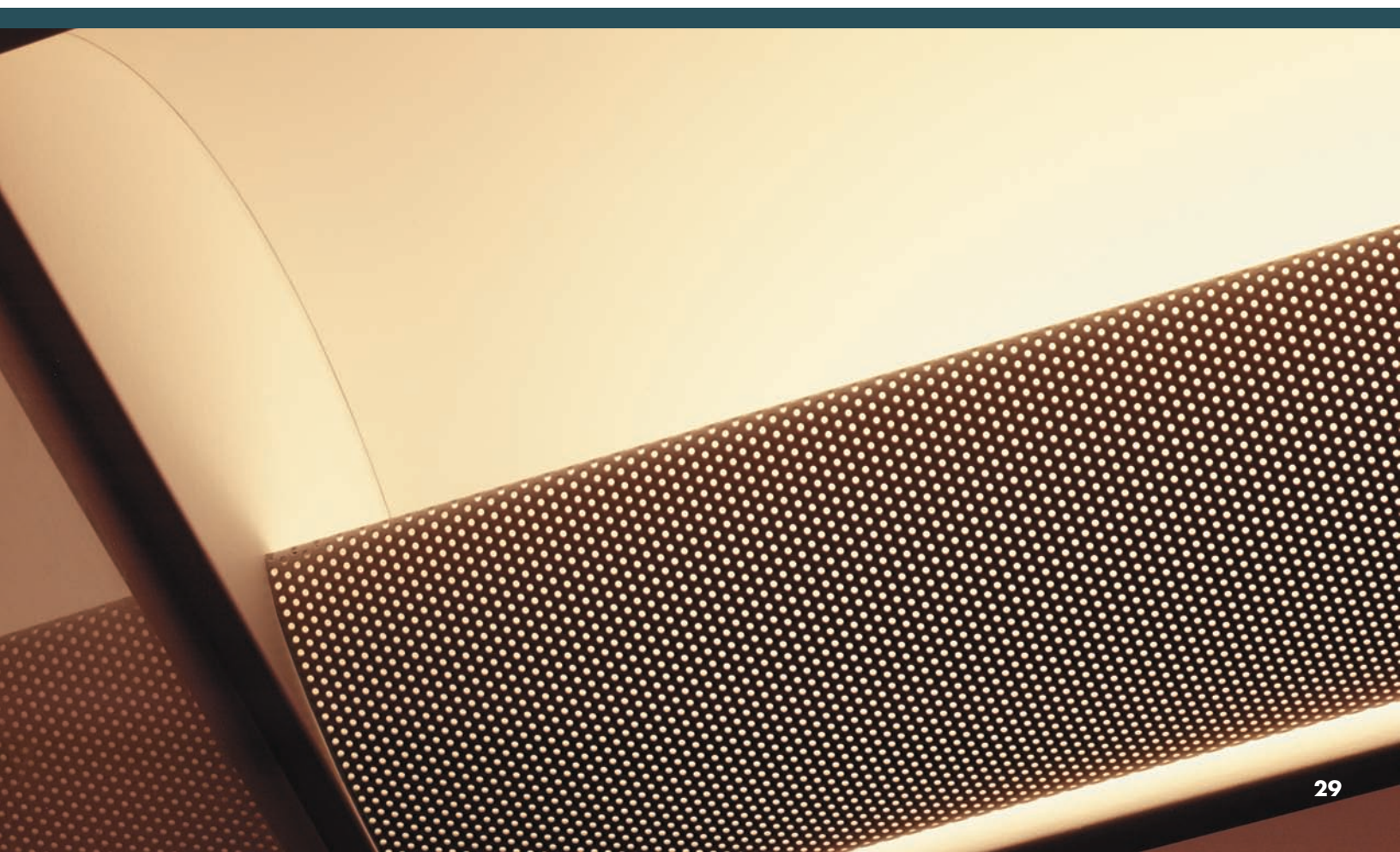



# Arioso Sensations



Arioso Sensations features those luminaires that stimulate the senses. With metallic textures, perforated louvers, and ridged glass elements, they evoke both visual and tactile sensations. These luminaires not only provide soft comfortable lighting, they make a dramatic statement as well.

# Arioso Sensations - Louver



## photometry

2AVG332-LMWS-1/21-EB - 2x4 perforated with solid louver blades, 3 lamp 32W T8

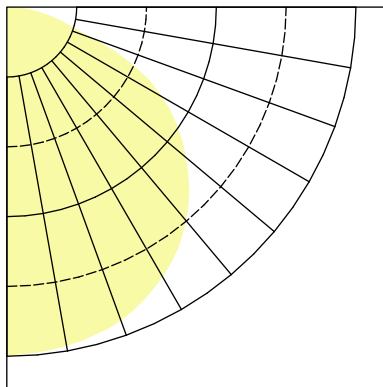

Maintained Illumination Table - Sq. Ft. / Luminaire

Room Width Room Height	2x4 3 Lamp T8			
	Approx. Area (sq. ft) per luminaire 30ft-c	50ft-c	70ft-c	100ft-c
5	134	80	57	40
2	90	54	39	-
1	66	39	-	-

80-50-20 Reflectances (Ceiling-Wall-Floor)  
LLF = 0.75 2850 Lumens/Lamp very clean  
Room width divided by room height = 5 or more, 2 or 1

### Reference Information

Efficiency	59.8%
Spacing to Mounting Height	1.3

### Light Distribution

Degrees	Lumens	% Lamp	% Fixture
0-30	1394	16.3	27.3
0-40	2283	26.7	44.7
0-60	4044	47.3	79.1
0-90	5111	59.8	100.0

## ordering information

sample catalog number: 2AVG232-LMWS-UNV-1/2-EB

**G**

WIDTH	CEILING TYPE	LAMP TYPE/WATTAGE	VOLTAGE	OPTIONS
1 - 1' 2 - 2'	<b>G</b> - Grid*  * Contact manufacturer's rep. for screw slot applications.	<b>14</b> - 14wT5 (22") <b>17</b> - 17wT8 (24") <b>24HO</b> - 24wT5HO (22") <b>28</b> - 28wT5 (46") <b>32</b> - 32wT8 (48") <b>54HO</b> - 54wT5HO (46") <b>CF40</b> - 40wTT5 (24") <b>CF50</b> - 50wTT5 (24") <b>CF55</b> - 55wTT5 (24")	<b>120</b> <b>277</b> <b>347</b> <b>UNV</b> - Universal voltage, 120-277 volt	<b>1/2</b> - One 2-lamp ballast (electronic or non-standard) <b>1/3</b> - One 3-lamp ballast (electronic or non-standard) <b>1/21</b> - 2-lamp & 1-lamp ballasts (electronic or non-standard) <b>2/2</b> - Two 2-lamp ballasts (electronic or non-standard) <b>EB</b> - Electronic ballast, <20% THD <b>EB10I</b> - Electronic ballast, instant start, <10% THD <b>EB10R</b> - Electronic ballast, program rapid start, <10% THD <b>EBHE</b> - High efficiency T8 electronic ballast <b>EBSD</b> - T8 Electronic step dimming ballast <b>EBSD95</b> - T5 Electronic step dimming ballast, .95 ballast factor <b>EBSD115</b> - T5 Electronic step dimming ballast, 1.15 ballast factor <b>EBSD80</b> - 2-lamp 54wT5HO Electronic step dimming ballast, .80 ballast factor <b>EBD</b> - Electronic dimming ballast <b>E1</b> - DEB-1 emerg. ballast (T8 or CF only), 350-450 lumens (UL dry loc.) <b>E7</b> - DEB-7 emerg. ballast, 390-700 lumens (UL dry loc.) <b>E5</b> - DEB-5 emerg. ballast (T8 or CF only), 1100-1400 lumens (UL dry loc.) <b>E5ST</b> - DEB-5ST emerg. ballast with self test, 1100-1400 lumens (UL dry loc.) <b>F1</b> - Installed flex, 3/8" diameter, 18 gauge, 3 wire, 6' <b>F2</b> - Installed flex, 3/8" diameter, 18 gauge, 4 wire, 6' <b>GLR#</b> - Fusing, fast blow (# = number of ballasts) <b>LPT735</b> - Installed lamps, 70+ CRI, 3500K (T8 only) <b>LPT835</b> - Installed lamps, 80+ CRI, 3500K
FAMILY	NO. OF LAMPS	SHIELDING		
<b>AV</b> - Arioso <b>AVCP</b> - Chicago Plenum Model	(not included) <b>2</b> <b>3</b> <b>4</b>	<b>LMWS</b> - Perf. basket with solid louver blades, matte white <b>LMWP</b> - Perf. basket with perf. blades, matte white <b>LMWG</b> - White perf. basket with grey solid louver blades		

day-brite lighting



## product highlights

Arioso Louver begins with the clean lines of the standard Arioso and adds longitudinal shielding and a larger downlight component. Through the use of louvers and stylish details, Arioso Louver creates a dynamic space without distracting glare, contrast or shadows. It balances quality uniform illumination with a larger direct component making it ideal for more active spaces such as conference rooms, break rooms, lobbies, classrooms, etc.

- Louver assembly incorporates side perforated element that easily integrates this unit with the standard Arioso family.
- Louvers are available in several options - solid matte white blades, perforated matte white blades and grey solid louver blades.
- Balanced illumination with larger direct component supports more active applications with higher ceiling or higher light level requirements.
- Design aids in the superior modeling of vertical space and people.
- Single-piece captive center enclosure swings open to provide easy relamping and ballast access.
- High efficiency lamp/ballast, bi-level switching, dimming and emergency ballasts are offered as standard options.

## cross sections

1' x 4'

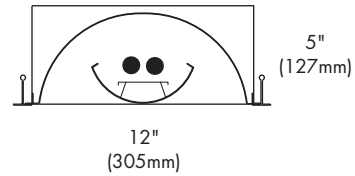

2' x 2'  
2' x 4'

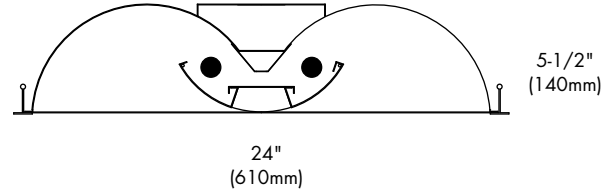

day-brite lighting

## product availability

Size	Number of Lamps	Lamp Type
1'x4'	2	28, 32, 54HO
2'x2'	2, 3 2, 3	14, 17, 24HO CF40, CF50, CF55
2'x4'	2, 3 4	28, 32, 54HO CF40, CF50, CF55

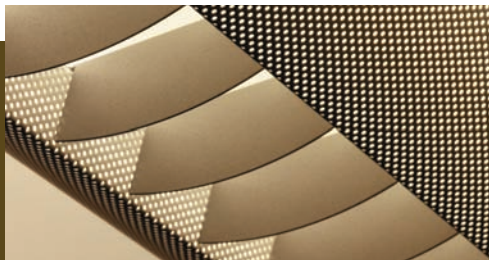

grey baffle



white baffle



perforated baffle



# Arioso Sensations - Metal



## photometry

2AVMG232-PMW-1/2-EB - 2x4 perforated with white overlay, 2 lamp 32W T8

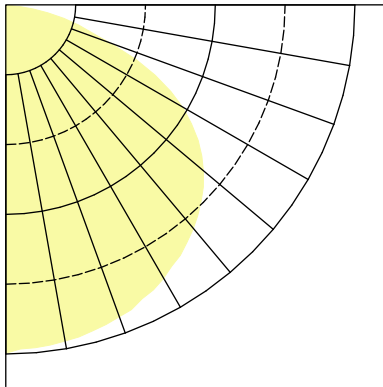

Maintained Illumination Table - Sq. Ft. / Luminaire

Room Width Room Height	2x4 2 Lamp T8			
	Approx. Area (sq. ft) per luminaire 30ft-c	50ft-c	70ft-c	100ft-c
5	80	48	34	-
2	54	32	-	-
1	39	-	-	-

80-50-20 Reflectances (Ceiling-Wall-Floor)  
LLF = 0.75 2850 Lumens/Lamp very clean  
Room width divided by room height = 5 or more, 2 or 1

### Reference Information

Efficiency	53.8%
Spacing to Mounting Height	1.4

### Light Distribution

Degrees	Lumens	% Lamp	% Fixture
0-30	816	14.3	26.6
0-40	1340	23.5	43.7
0-60	2406	42.2	78.5
0-90	3065	53.8	100.0

## ordering information

sample catalog number: 2AVMG232-PMW-UNV-1/2-EB

day-brite lighting

<b>2</b>	<b>G</b>	<b>- PMW -</b>	<b>-</b>	<b>-</b>
<u>WIDTH</u> 2 - 2'	<u>CEILING TYPE</u> G - Grid	<u>LAMP TYPE/WATTAGE</u> 14 - 14wT5 (22") 17 - 17wT8 (24") 24HO - 24wT5HO (22") 28 - 28wT5 (46") 32 - 32wT8 (48") 54HO - 54wT5HO (46") CF40 - 40wTT5 (24") CF50 - 50wTT5 (24") CF55 - 55wTT5 (24")	<u>VOLTAGE</u> 120 277 347 UNV - Universal voltage, 120-277 volt	<u>OPTIONS</u> 1/2 - One 2-lamp ballast (electronic or non-standard) 1/3 - One 3-lamp ballast (electronic or non-standard) 1/21 - 2-lamp & 1-lamp ballasts (electronic or non-standard) 2/2 - Two 2-lamp ballasts (electronic or non-standard) EB - Electronic ballast, <20% THD EB10I - Electronic ballast, instant start, <10% THD EB10R - Electronic ballast, program rapid start, <10% THD EBHE - High efficiency T8 electronic ballast EBSD - T8 Electronic step dimming ballast EBSD95 - T5 Electronic step dimming ballast, .95 ballast factor EBSD115 - T5 Electronic step dimming ballast, 1.15 ballast factor EBSD80 - 2-lamp 54wT5HO Electronic step dimming ballast, .80 ballast factor EBD - Electronic dimming ballast E1 - DEB-1 emerg. ballast (T8 or CF only), 350-450 lumens (UL dry loc.) E7 - DEB-7 emerg. ballast, 390-700 lumens (UL dry loc.) E5 - DEB-5 emerg. ballast (T8 or CF only), 1100-1400 lumens (UL dry loc.) ES5T - DEB-5ST emerg. ballast with self test, 1100-1400 lumens (UL dry loc.) F1 - Installed flex, 3/8" diameter, 18 gauge, 3 wire, 6' F2 - Installed flex, 3/8" diameter, 18 gauge, 4 wire, 6' GLR# - Fusing, fast blow (# = number of ballasts) LPT735 - Installed lamps, 70+ CRI, 3500K (T8 only) LPT835 - Installed lamps, 80+ CRI, 3500K
<u>FAMILY</u> AVM - Arioso Metal AVMCP - Chicago Plenum Model	<u>NO. OF LAMPS</u> (not included) 1 2 3 4	<u>SHIELDING</u> PMW - Perforated metal with white overlay		



## product highlights

For a distinctive space, Arioso Metal offers a ribbed semi-specular metal reflector material that instantly adds texture and interest. Arioso Metal offers two distinct effects. If the luminaire is not energized, the contrast of materials is well-defined & pronounced. When illuminated, Arioso Metal renders the space and the face of the luminaire evenly and consistently.

- Seamless semi-specular ribbed aluminum reflector.
- Microperforated basket backed with smooth white acrylic eliminates lamp image.
- Low level illumination on the workplane as well as on the vertical wall surfaces.
- Single-piece captive center enclosure swings open to provide easy relamping and ballast access.
- High efficiency lamp/ballast, bi-level switching, dimming and emergency ballasts are offered as standard options.

## cross sections

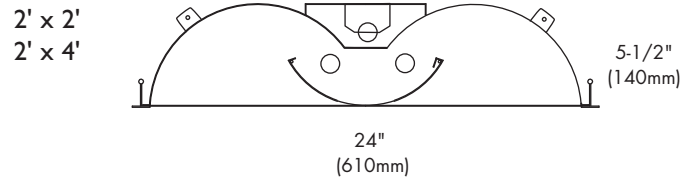

day-brite lighting

## product availability

Size	Number of Lamps	Lamp Type
2'x2'	2, 3	14, 17, 24HO
	1, 2	CF40, CF50, CF55
2'x4'	2, 3	28, 32, 54HO
	4	CF40, CF50, CF55

# Arioso Sensations - Metal Louver

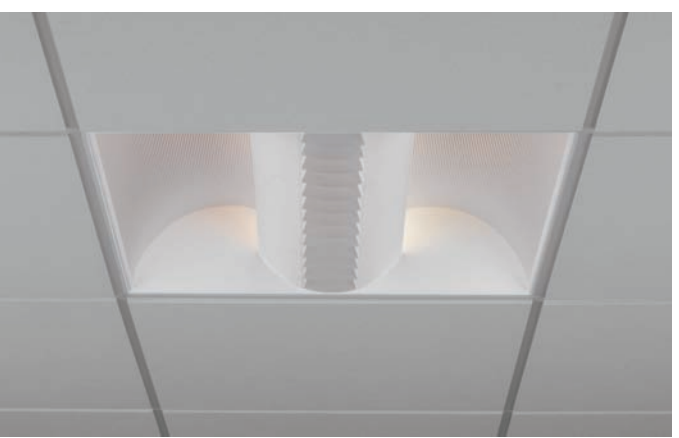

## photometry

2AVMG232-LMWG-1/2-EB - 2x4 perforated with solid grey louver blades, 2 lamp 32W T8

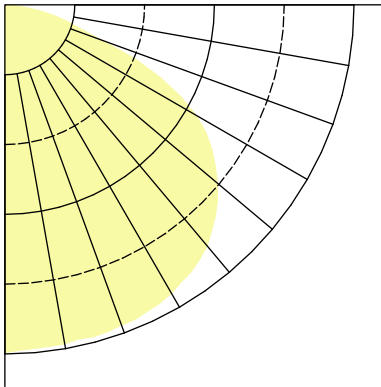

Maintained Illumination Table - Sq. Ft. / Luminaire

Room Width Room Height	2x4 2 Lamp T8			
	Approx. Area (sq. ft) per luminaire 30ft-c	50ft-c	70ft-c	100ft-c
5	62	37	-	-
2	42	-	-	-
1	30	-	-	-

80-50-20 Reflectances (Ceiling-Wall-Floor)  
LLF = 0.75 2850 Lumens/Lamp very clean  
Room width divided by room height = 5 or more, 2 or 1

## Reference Information

Efficiency	41.6%
Spacing to Mounting Height	1.4

## Light Distribution

Degrees	Lumens	% Lamp	% Fixture
0-30	635	11.1	26.8
0-40	1047	18.4	44.1
0-60	1878	33.0	79.2
0-90	2372	41.6	100.0

## ordering information

sample catalog number: 2AVMG232-LMWG-UNV-1/2-EB

day-brite lighting

<b>2</b>	<b>G</b>	-	-	-
<u>WIDTH</u> 2 - 2'	<u>CEILING TYPE</u> G - Grid	<u>LAMP TYPE/WATTAGE</u> 14 - 14wT5 (22") 17 - 17wT8 (24") 24HO - 24wT5HO (22") 28 - 28wT5 (46") 32 - 32wT8 (48") 54HO - 54wT5HO (46") CF40 - 40wTT5 (24") CF50 - 50wTT5 (24") CF55 - 55wTT5 (24")	<u>VOLTAGE</u> 120 277 347 UNV - Universal voltage, 120-277 volt	<u>OPTIONS</u> 1/2 - One 2-lamp ballast (electronic or non-standard) 1/3 - One 3-lamp ballast (electronic or non-standard) 1/21 - 2-lamp & 1-lamp ballasts (electronic or non-standard) EB - Electronic ballast, <20% THD EB10I - Electronic ballast, instant start, <10% THD EB10R - Electronic ballast, program rapid start, <10% THD EBHE - High efficiency T8 electronic ballast EBS - T8 Electronic step dimming ballast EBSD95 - T5 Electronic step dimming ballast, .95 ballast factor EBSD115 - T5 Electronic step dimming ballast, 1.15 ballast factor EBSD80 - 2-lamp 54wT5HO Electronic step dimming ballast, 80 ballast factor EBD - Electronic dimming ballast E1 - DEB-1 emerg. ballast (T8 or CF only), 350-450 lumens (UL dry loc.) E7 - DEB-7 emerg. ballast, 390-700 lumens (UL dry loc.) E5 - DEB-5 emerg. ballast (T8 or CF only), 1100-1400 lumens (UL dry loc.) ESST - DEB-5ST emerg. ballast with self test, 1100-1400 lumens (UL dry loc.) F1 - Installed flex, 3/8" diameter, 18 gauge, 3 wire, 6' F2 - Installed flex, 3/8" diameter, 18 gauge, 4 wire, 6' GLR# - Fusing, fast blow (# = number of ballasts) LPT735 - Installed lamps, 70+ CRI, 3500K (T8 only) LPT835 - Installed lamps, 80+ CRI, 3500K
<u>FAMILY</u> AVM - Arioso Metal AVMCP - Chicago Plenum Model	<u>NO. OF LAMPS</u> (not included) 2 3	<u>SHIELDING</u> LMWS - Perf. basket with solid louver blades, matte white LMWP - Perf. basket with perf. blades, matte white LMWG - White perf. basket with grey solid louver blades		

Job pack stretch wrapped w/out cartons  
Master/Satellite wiring



## product highlights

For a distinctive space, Arioso Metal Louver starts with a ribbed semi-specular metal reflector that instantly adds texture and interest. Coupling this with a louver for longitudinal shielding and a larger downlighting component, this series succeeds in creating a more dynamic space without distracting glare, contrast or shadows. Arioso Metal Louver provides unique solutions by combining signature aesthetics with quality performance.

- Seamless semi-specular ribbed aluminum reflector.
- Side perforated element on the louver assembly and the ribbed metal reflector easily integrates this model within the Arioso Metal series.
- Louvers are available in several options - solid matte white blades, perforated matte white blades and grey solid louver blades.
- Single-piece captive center enclosure swings open to provide easy relamping and ballast access.
- High efficiency lamp/ballast, bi-level switching, dimming and emergency ballasts are offered as standard options.

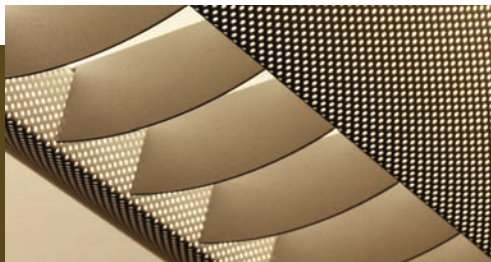

grey baffle



white baffle



perforated baffle

## cross sections

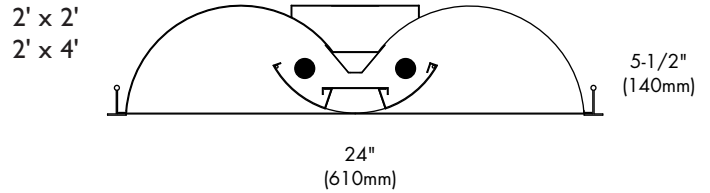

day-brite lighting

## product availability

Size	Number of Lamps	Lamp Type
2'x2'	2, 3	14, 17, 24HO, CF40, CF50, CF55
2'x4'	2, 3	28, 32, 54HO

# Arioso Sensations - Essence



## photometry

2AVEG228-PMW-1/2-EB - 2x4 perforated with white overlay, 2 lamp 28W T5

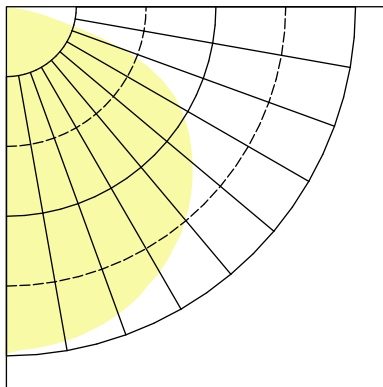

Maintained Illumination Table - Sq. Ft. / Luminaire

Room Width Room Height	2x2 2 Lamp T5			
	Approx. Area (sq. ft) per luminaire 30ft-c	50ft-c	70ft-c	100ft-c
5	117	70	50	35
2	79	47	34	-
1	57	34	-	-

80-50-20 Reflectances (Ceiling-Wall-Floor)  
LLF = 0.89 2600 Lumens/Lamp very clean  
Room width divided by room height = 5 or more, 2 or 1

### Reference Information

Efficiency	73.3%
Spacing to Mounting Height	1.3

### Light Distribution

Degrees	Lumens	% Lamp	% Fixture
0-30	983	18.9	25.8
0-40	1625	31.2	42.6
0-60	2948	56.7	77.3
0-90	3812	73.3	100.0

## ordering information

sample catalog number: 2AVEG2CF40-FGL-UNV-1/2-EB

2	AVE	G	-	-	-	-
WIDTH	FAMILY	CEILING TYPE	LAMP TYPE/WATTAGE	VOLTAGE	SHIELDING	OPTIONS
2 - 2'	AVE - Arioso Essence	G - Grid	<b>14</b> - 14wT5 (22") <b>24HO</b> - 24wT5HO (22") <b>28</b> - 28wT5 (46") <b>54HO</b> - 54wT5HO (46") <b>CF40</b> - 40wTT5 (24") <b>CF50</b> - 50wTT5 (24") <b>CF55</b> - 55wTT5 (24")	<b>120</b> <b>277</b> <b>347</b> UNV - Universal voltage, 120-277 volt	<b>PMW</b> - Perforated metal with white overlay <b>FGL</b> - Two-piece frosted ridged glass (2x2 only)	<b>1/2</b> - One 2-lamp ballast (electronic or non-standard) <b>1/21</b> - 2-lamp & 1-lamp ballasts (electronic or non-standard) <b>1/3</b> - One 3-lamp ballast (electronic or non-standard) <b>EB</b> - Electronic ballast, <20% THD <b>EB10I</b> - Electronic ballast, instant start, <10% THD <b>EB10R</b> - Electronic ballast, program rapid start, <10% THD <b>EBSD95</b> - T5 Electronic step dimming ballast, .95 ballast factor <b>EBSD115</b> - T5 Electronic step dimming ballast, 1.15 ballast factor <b>EBSD80</b> - 2-lamp 54wT5HO Electronic step dimming ballast, .80 ballast factor <b>EBD</b> - Electronic dimming ballast <b>E1</b> - DEB-1 emerg. ballast, CF only, 350-450 lumens (UL dry loc.) <b>E7</b> - DEB-7 emerg. ballast, 390-700 lumens (UL dry loc.) <b>E5</b> - DEB-5 emerg. ballast, CF only, 900 lumens (UL dry loc.) <b>E5ST</b> - DEB-5ST emerg. ballast with self test, CF only, 1100-1400 lumens (UL dry loc.) <b>F1</b> - Installed flex, 3/8" diameter, 18 gauge, 3 wire, 6' <b>F2</b> - Installed flex, 3/8" diameter, 18 gauge, 4 wire, 6' <b>GLR#</b> - Fusing, fast blow (# = number of ballasts) <b>LPT835</b> - Installed lamps, 80+ CRI, 3500K
			(not included) <b>2</b> <b>3</b>			

day-brite lighting



## product highlights

Arioso Essence offers a stunning visual effect with a sleek reflector shape and (2) converging glass panels or a micro-perforated curved basket to softly illuminate a signature space. The available glass diffusers combine frosted, ridged glass with satin-finished natural metal to incorporate premium textures and finishes. Whether this series is the focal point of the design or an integral element to advance the design concept, Arioso Essence is uniquely inspiring.

- Ideal for shallow ceiling applications with 3-1/2" deep housing.
- Housing edge design locates the bottom of the luminaire flush with the ceiling plane in standard (NEMA G) grid or screw slot (NEMA SS) applications.
- NOT suitable for use in narrow face grid (NEMA NFG) applications.
- Creates soft even illumination on the work-plane as well as on the vertical wall surfaces.
- Easy relamping and ballast access.
- High efficiency lamp/ballast, bi-level switching, dimming and emergency ballasts are offered as standard options.

## cross sections

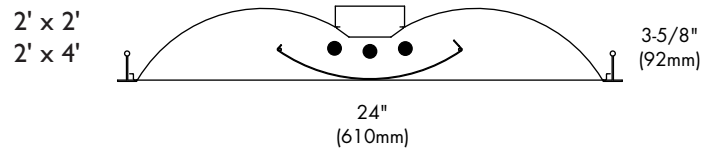

day-brite lighting

## product availability

Size	Shielding	Number of Lamps	Lamp Type
2'x2'	PMW	2	14, 24HO, CF40, CF50, CF55
2'x2'	FGL	2	14, 24HO, CF40, CF50, CF55
2'x4'	PMW	2, 3	28, 54HO

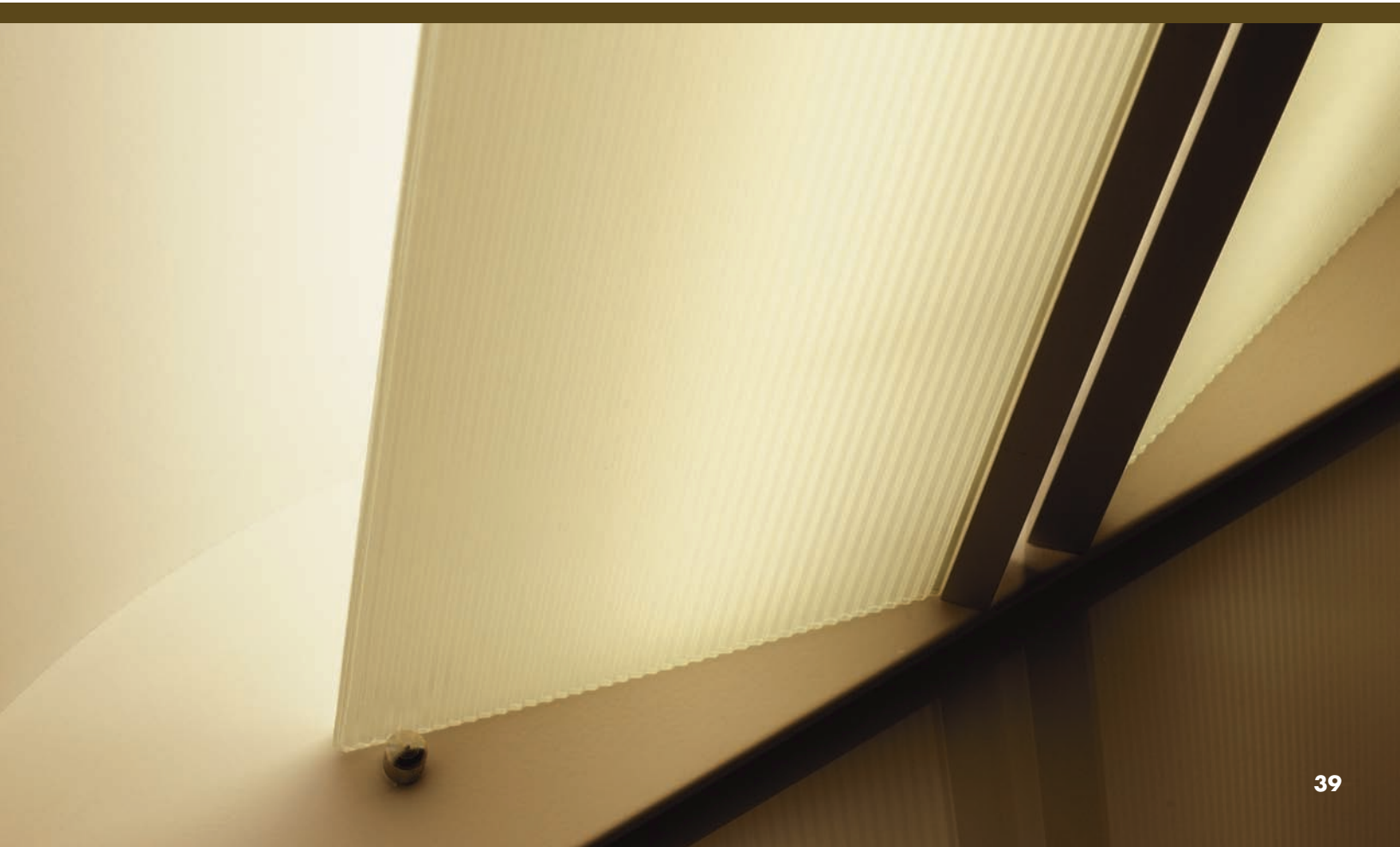

# Arioso Sensations - Cloud



## photometry

2AVCG2CF42-PMW-1/2-EB - 2x2 perforated with white overlay, 2 lamp 42W TTT

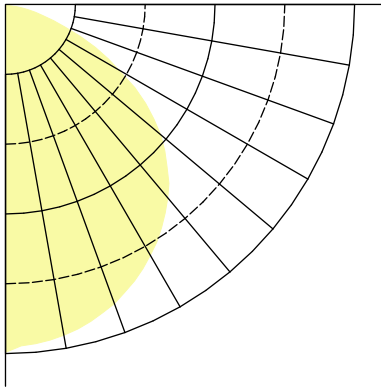

Maintained Illumination Table - Sq. Ft. / Luminaire

Room Width Room Height	2x2 2 Lamp CF42			
	Approx. Area (sq. ft) per luminaire 30ft-c	50ft-c	70ft-c	100ft-c
5	102	61	44	31
2	70	42	-	-
1	51	31	-	-

80-50-20 Reflectances (Ceiling-Wall-Floor)  
LLF = 0.78 3200 Lumens/Lamp very clean  
Room width divided by room height = 5 or more, 2 or 1

### Reference Information

Efficiency	58.0%
Spacing to Mounting Height	1.2

### Light Distribution

Degrees	Lumens	% Lamp	% Fixture
0-30	1059	16.5	28.5
0-40	1742	27.2	46.9
0-60	3091	48.3	83.2
0-90	3713	58.0	100.0

## ordering information

sample catalog number: 2AVCG2CF42-PMW-UNV-1/2-EB

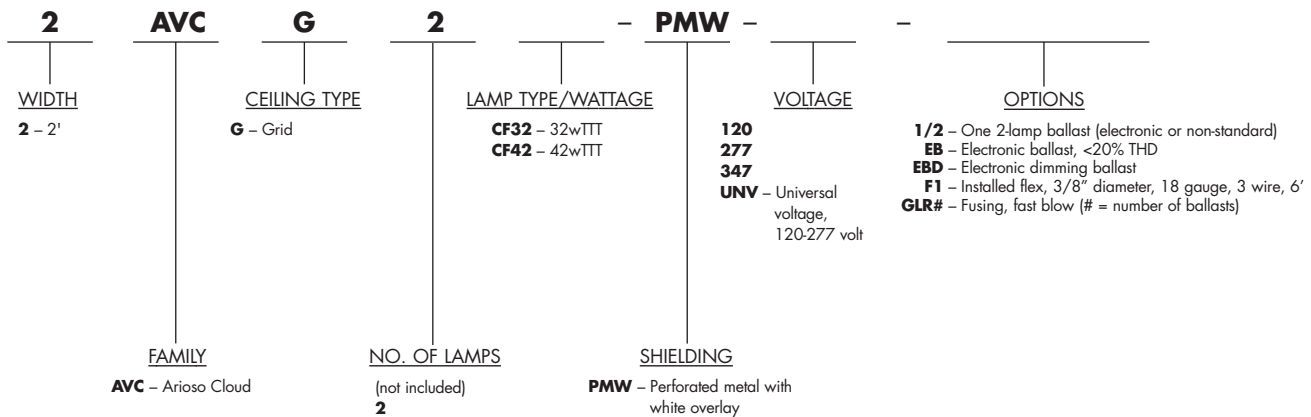

day-brite lighting



## product highlights

Arioso Cloud offers all the performance of the Arioso series with a shape that is simple and yet distinctive. The circular shape provides non-directional uniform illumination that integrates the design elements and creates a harmonious environment. These characteristics make Arioso Cloud ideal for open circulation areas such as lobbies, assembly halls, corridor intersections, etc.

- Available in 2 lamp 2x2 configurations.
- Seamless microperforated face backed with smooth white acrylic eliminates lamp image.
- Non-directional illumination creates uniformity in the horizontal and vertical planes.
- Easy relamping access from below.
- Companion wall sconce available.
- Dimming is offered as a standard option.

## cross sections

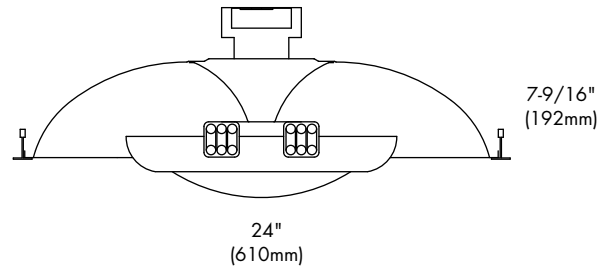

day-brite lighting

## product availability

Size	Number of Lamps	Lamp Type
2'x2'	2	CF32, CF42

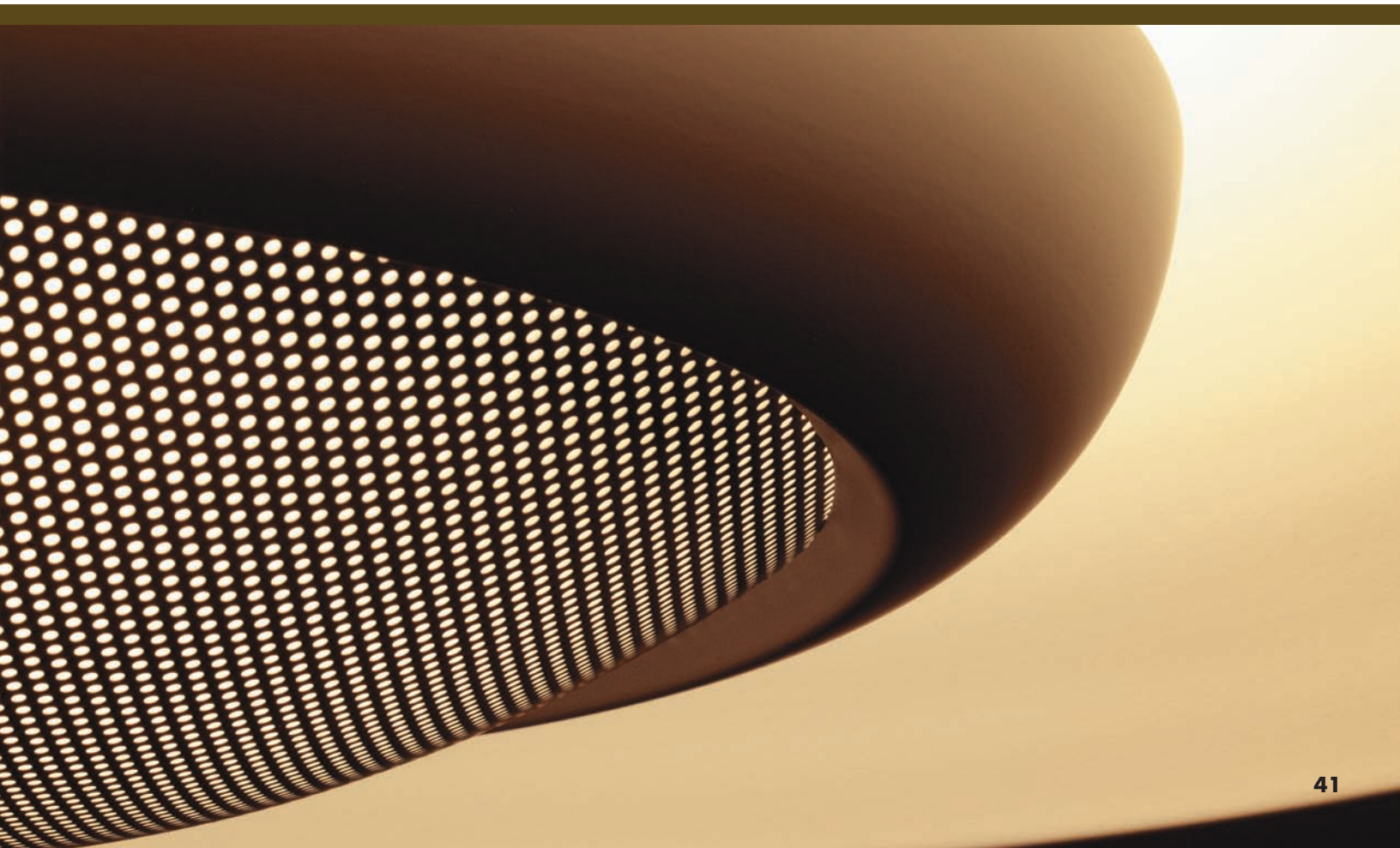

# Arioso Sensations - Orb



## photometry

2AVRG1CF40-PMW-1/1-EB - 2x2 perforated with white overlay, 1 lamp 40W TT5

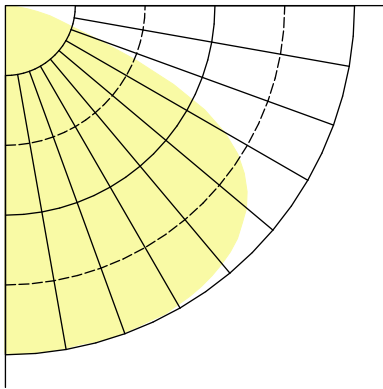

Maintained Illumination Table - Sq. Ft. / Luminaire

Room Width Room Height	2x2 1 Lamp CF40			
	Approx. Area (sq. ft) per luminaire 30ft-c	50ft-c	70ft-c	100ft-c
5	58	35	-	-
2	39	-	-	-
1	-	-	-	-

80-50-20 Reflectances (Ceiling-Wall-Floor)  
LLF = 0.86 3150 Lumens/Lamp very clean  
Room width divided by room height = 5 or more, 2 or 1

### Reference Information

Efficiency	61.9%
Spacing to Mounting Height	1.5

### Light Distribution

Degrees	Lumens	% Lamp	% Fixture
0-30	474	15.0	24.3
0-40	801	25.4	41.1
0-60	1523	48.3	78.1
0-90	1949	61.9	100.0

## ordering information

sample catalog number: 2AVRG1CF40-PMW-UNV-1/1-EB

<b>2</b>	<b>G</b>	<b>1</b>	<b>- PMW -</b>	<b>-</b>
<u>WIDTH</u> 2 - 2'	<u>CEILING TYPE</u> G - Grid	<u>LAMP TYPE/WATTAGE</u> CF40 - 40wTT5 (24") CF50 - 50wTT5 (24") CF55 - 55wTT5 (24")	<u>VOLTAGE</u> 120 277 347 UNV - Universal voltage, 120-277 volt	<u>OPTIONS</u> CM - Canadian Market 1/1 - One 1-lamp ballast (electronic or non-standard) EB - Electronic ballast, <20% THD EBD - Electronic dimming ballast F1 - Installed flex, 3/8" diameter, 18 gauge, 3 wire, 6' GLR# - Fusing, fast blow (# = number of ballasts)
	<u>FAMILY</u> AVR - Arioso Orb AVRCP - Chicago Plenum Model	<u>NO. OF LAMPS</u> (not included) 1	<u>SHIELDING</u> PMW - Perforated metal with white overlay	Job pack stretch wrapped w/out cartons Master/Satellite wiring

day-brite lighting

## product highlights

Arioso Orb combines 2 strong geometric shapes to give this luminaire a strong presence in any space. Reinforcing design elements in the space or being the feature element itself, Arioso Orb combines balanced illumination with distinctive visual appeal.

- Available in 1 lamp 2x2 configurations.
- Microperforated basket backed with smooth white acrylic eliminates lamp image.
- Narrow split basket detail provides visual interest.
- Creates soft even illumination on the workplane.
- Easy relamping access from below, ballast access from top.
- Dimming is offered as a standard option.
- Can be used in conjunction with the Arioso Cloud, recessed and wall sconce models.

## cross sections

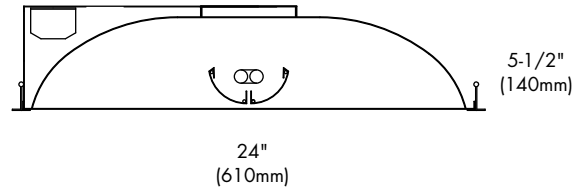

day-brite lighting

## product availability

Size	Lamps/ Cross Section	Lamps/ Fixture	Lamp Type
2'x2'	1	1	CF40, CF50, CF55



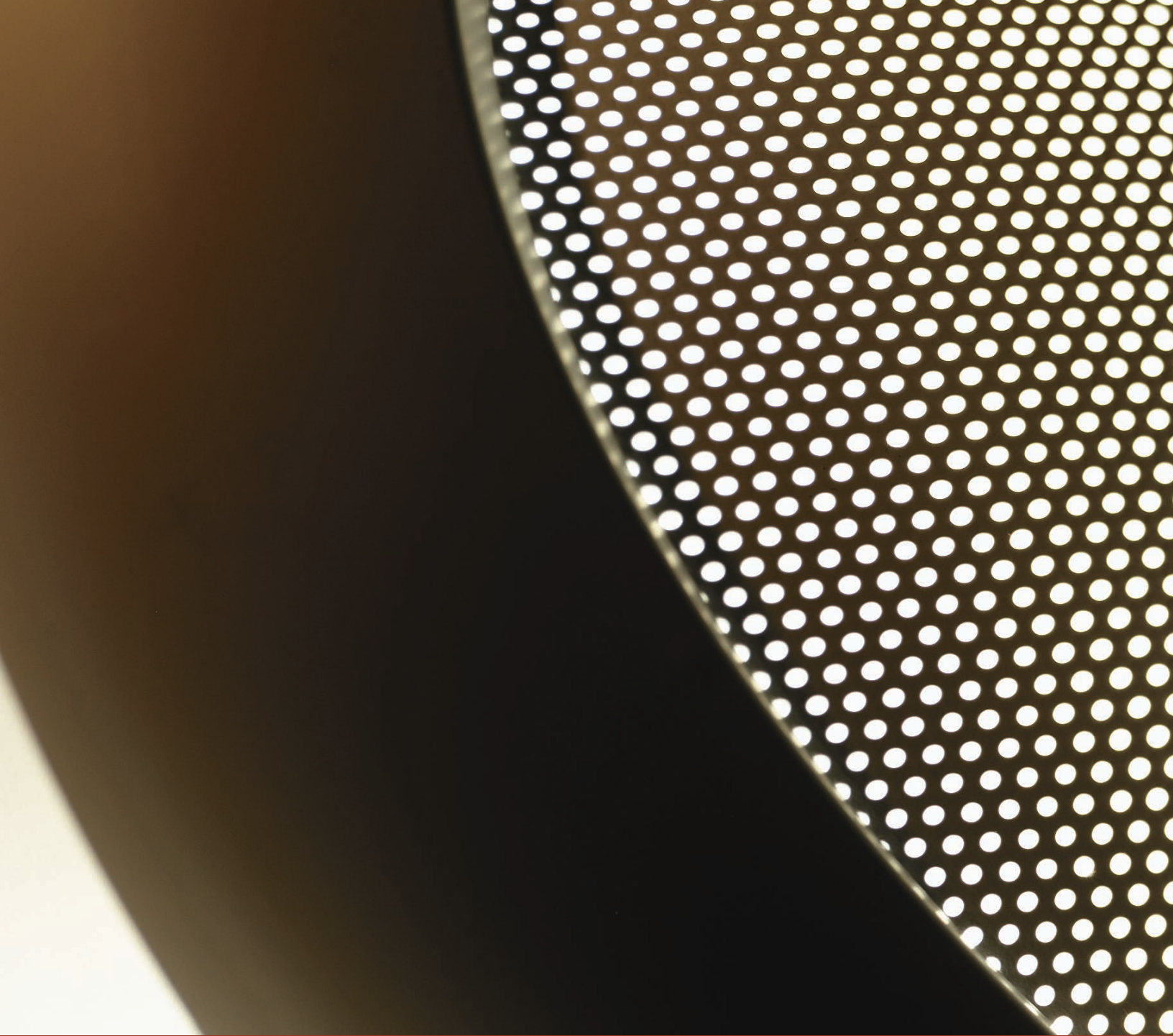

## Arioso Reliefs



In the art realm, a relief is defined as the projection of a figure or part from the plane on which it is formed, as in a sculpture. The Arioso Reliefs Series is comprised of surface units and wall sconces which function as sculptural elements within your design pallet, thus completing and enhancing it. Complementing the other products, this series adds detail and interest while maintaining the flow of the space. These unique luminaires can be tailored to a specific space and design concept inspiring elements like vitality, elegance, and tranquility.



# Arioso Reliefs - Surface



## photometry

2SAVC2CF40-PMW-1/2-EB - 2x2 perforated with white overlay, 2 lamp 40W TT5

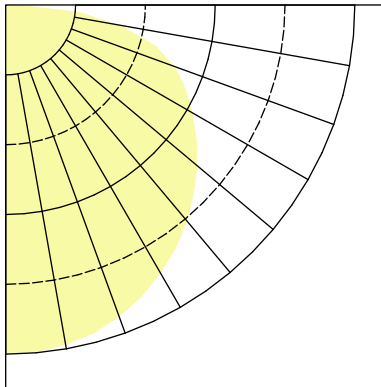

Maintained Illumination Table - Sq. Ft. / Luminaire

Room Width Room Height	2x2 2 Lamp CF40			
	Approx. Area (sq. ft) per luminaire 30ft-c	50ft-c	70ft-c	100ft-c
5	97	58	41	-
2	64	38	-	-
1	46	-	-	-

80-50-20 Reflectances (Ceiling-Wall-Floor)  
LLF = 0.84 3150 Lumens/Lamp very clean  
Room width divided by room height = 5 or more, 2 or 1

### Reference Information

Efficiency	60.9%
Spacing to Mounting Height	1.3

### Light Distribution

Degrees	Lumens	% Lamp	% Fixture
0-30	927	14.7	24.2
0-40	1525	24.2	39.8
0-60	2753	43.7	71.8
0-90	3825	60.7	99.7
90-180	10	0.2	0.3
0-180	3835	60.9	100.0

## ordering information

sample catalog number: 2SAVC2CF40-PMW-UNV-1/2-EB

<b>2</b>	<b>SAVC</b>	<b>NO. OF LAMPS</b>	<b>PMW</b>	<b>OPTIONS</b>
WIDTH 2 - 2'	FAMILY SAVC - Surface Arioso Ceiling Mount	(not included) 2 3 4	SHIELDING PMW - Perforated metal with white overlay	<b>1/2</b> - One 2-lamp ballast (electronic or non-standard) <b>1/3</b> - One 3-lamp ballast (electronic or non-standard) <b>1/21</b> - 2-lamp & 1-lamp ballasts (electronic or non-standard) <b>2/2</b> - Two 2-lamp ballasts (electronic or non-standard) <b>EB</b> - Electronic ballast, <20% THD <b>EB10I</b> - Electronic ballast, instant start, <10% THD <b>EB10R</b> - Electronic ballast, program rapid start, <10% THD <b>EBSD95</b> - T5 Electronic step dimming ballast, .95 ballast factor <b>EBSD115</b> - T5 Electronic step dimming ballast, 1.15 ballast factor <b>EBSD80</b> - 2-lamp 54wT5HO Electronic step dimming ballast, .80 ballast factor <b>EBD</b> - Electronic dimming ballast <b>GLR#</b> - Fusing, fast blow (# = number of ballasts) <b>LPT835</b> - Installed lamps, 80+ CRI, 3500K
		<b>LAMP TYPE/WATTAGE</b>	<b>VOLTAGE</b>	
		<b>28</b> - 28wT5 (46") <b>54HO</b> - 54wT5HO (46") <b>CF40</b> - 40wTT5 (24") <b>CF50</b> - 50wTT5 (24") <b>CF55</b> - 55wTT5 (24")	<b>120</b> <b>277</b> <b>347</b> <b>UNV</b> - Universal voltage, 120-277 volt	

day-bright lighting



## product highlights

Utilizing all the features & benefits of the Arioso family, Arioso Surface adds the critical third dimension. Whether surface mounting is due to construction constraints or a desire to create style and intimacy, this series offers the solution for ceiling mounting. Arioso Surface continues the look and performance of the Arioso family in a slim low profile beautifully contoured model.

- Low profile model extends less than 4" below the ceiling plane.
- Softly contoured edges are only 2-1/4" deep and create a diminished shape that makes the luminaire appear even shallower.
- Microperforated basket backed with smooth white acrylic eliminates lamp image.
- Creates soft even illumination on the workplane.
- Single-piece captive center enclosure swings open to provide easy relamping and ballast access.
- High efficiency lamp/ballast, bi-level switching, dimming and emergency ballasts are offered as standard options.
- Companion wall sconce available.

## cross sections

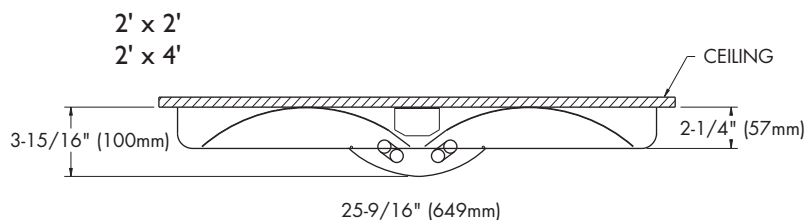

## product availability

Size	Lamps/ Cross Section	Lamps/ Fixture	Lamp Type
2'x2'	2	2	CF40, CF50, CF55
2'x4'	2, 3 2	2, 3 4	28, 54HO CF40, CF50, CF55



# Arioso Reliefs - Floating Frame



## photometry

2SAVF2CF40-PMW-1/2-EB - 2x2 perforated with white overlay, 2 lamp 40W TT5

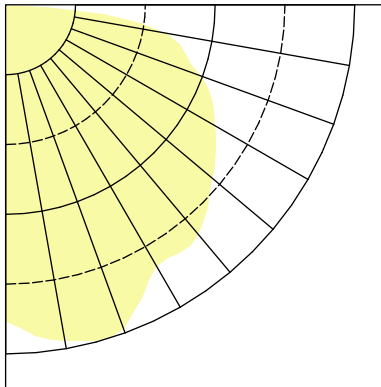

### Maintained Illumination Table - Sq. Ft. / Luminaire

Room Width Room Height	2x2 2 Lamp CF40			
	Approx. Area (sq. ft) per luminaire 30ft-c	50ft-c	70ft-c	100ft-c
5	91	55	39	-
2	59	35	-	-
1	42	-	-	-

80-50-20 Reflectances (Ceiling-Wall-Floor)  
LLF = 0.75 3150 Lumens/Lamp very clean  
Room width divided by room height = 5 or more, 2 or 1

### Reference Information

Efficiency	57.8%
Spacing to Mounting Height	1.5

### Light Distribution

Degrees	Lumens	% Lamp	% Fixture
0-30	810	12.9	22.2
0-40	1343	21.3	36.9
0-60	2494	39.6	68.5
0-90	3643	57.8	100.0

## ordering information

sample catalog number: 2SAVF2CF40-PMW-UNV-1/2-EB

<b>2</b>	<b>SAVF</b>	<b>2</b>	-	<b>PMW</b>	-	-	-
<u>WIDTH</u> 2 - 2'	<u>FAMILY</u> SAVF - Arioso Floating Frame	<u>NO. OF LAMPS</u> (not included) 2	<u>LAMP TYPE/WATTAGE</u> CF40 - 40wTT5 (24") CF50 - 50wTT5 (24") CF55 - 55wTT5 (24")	<u>SHIELDING</u> PMW - Perforated metal with white overlay	<u>VOLTAGE</u> 120 277 347 UNV - Universal voltage, 120-277 volt	<u>OPTIONS</u> CM - Canadian Market 1/2 - One 2-lamp ballast (electronic or non-standard) EB - Electronic ballast, <20% THD EB10I - Electronic ballast, instant start, <10% THD EB10R - Electronic ballast, program rapid start, <10% THD EBD - Electronic dimming ballast GLR# - Fusing, fast blow (# = number of ballasts) LPT835 - Installed lamps, 80+ CRI, 3500K	

## product highlights

Not satisfied to subtly blend away into the ceiling, Arioso Floating Frame heightens its impact by introducing a metal frame around the surface trim. With the split basket detailing and a bold stepped profile, Arioso Floating Frame adds depth of dimension and a significant decorative element to any space.

- Available in a 2 lamp 2x2 configuration.
- Low profile model extends 4" below the ceiling plane and is only 2-5/16" deep at luminaire edges.
- Microperforated split basket backed with smooth white acrylic eliminates lamp image.
- Stepped profile creates dimension and scale, producing a floating effect close to the ceiling.

## cross sections

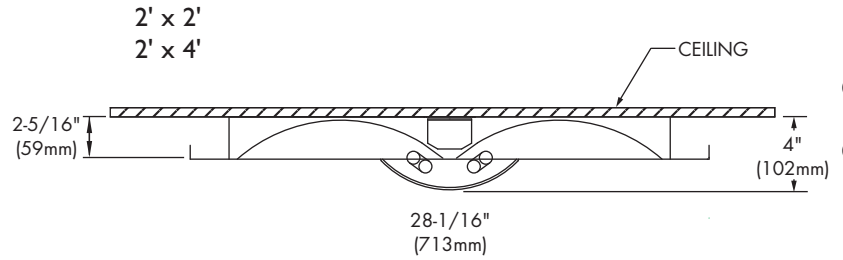

day-brite lighting

## product availability

Size	Lamps/ Cross Section	Lamps/ Fixture	Lamp Type
2'x2'	2	2	CF40, CF50, CF55

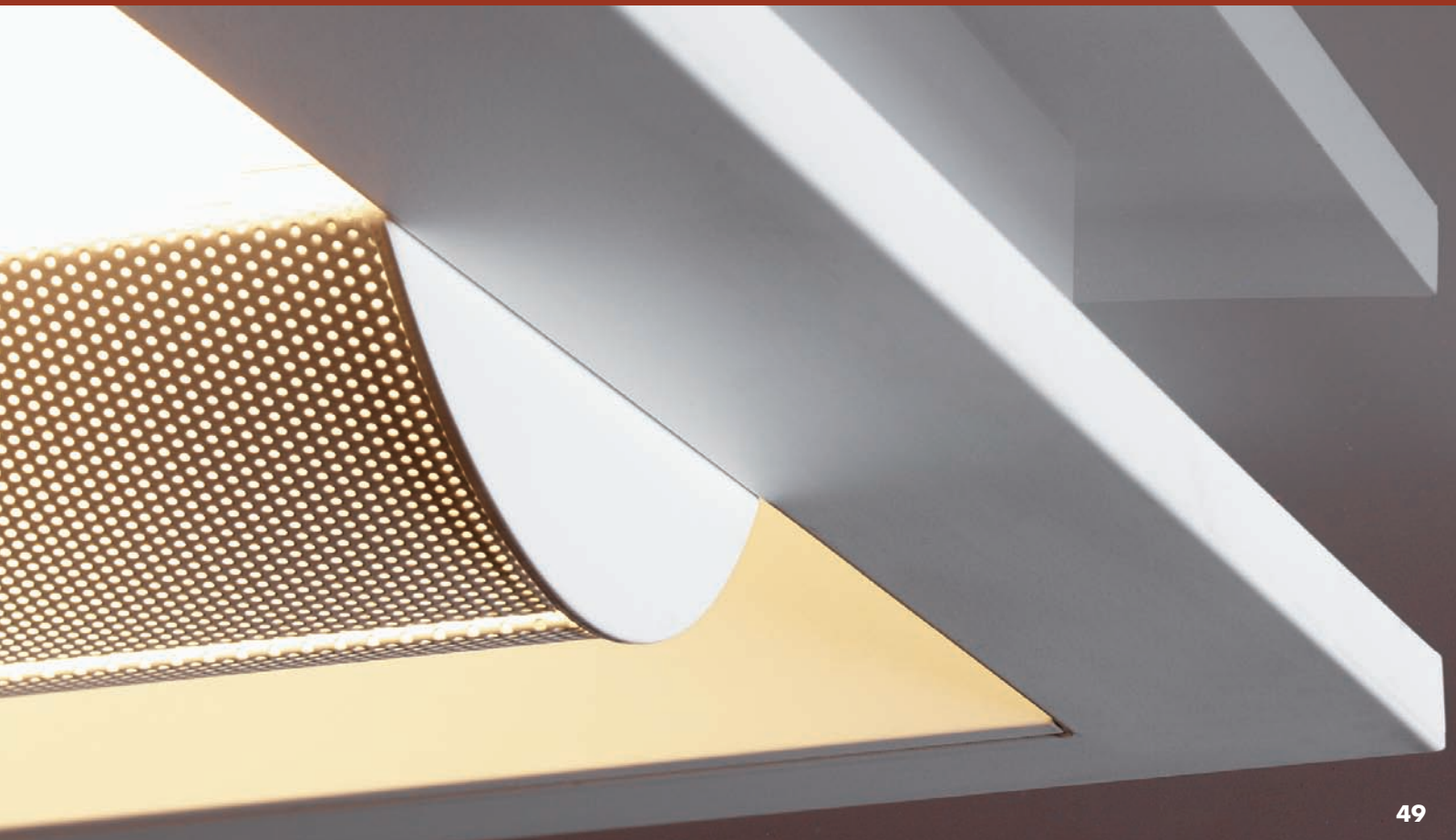



# Arioso Reliefs - Sconce



## photometry

AVS2CF40-PMW-1/2-EB - 2' sconce, perforated with white overlay, 2 lamp 40W TT5

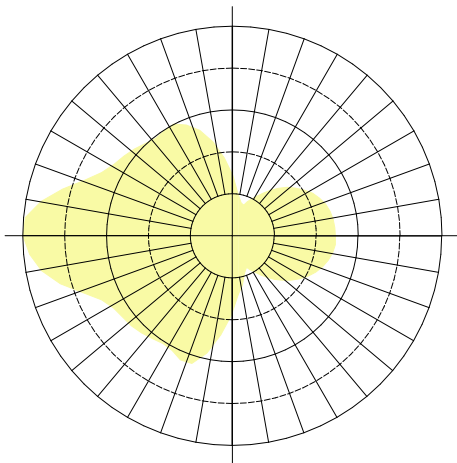

### Reference Information

Efficiency 81.5%

### Light Distribution

Degrees	Lumens	% Lamp	% Fixture
0-30	320	5.1	6.2
0-40	575	9.1	11.2
0-60	1253	19.9	24.4
0-90	2675	42.5	52.1
90-180	2458	39.0	47.9
0-180	5134	81.5	100.0

## ordering information

sample catalog number: AVS2CF40-PMW-UNV-1/2-EB

<p><b>AVS</b></p> <p><u>FAMILY</u></p> <p>AVS – Arioso Sconce</p>	<p><b>PMW</b></p> <p><u>LAMP TYPE/WATTAGE</u></p> <p>CF18 – 18wTT5 (12")                  28 – 28wT5 (46")                  32 – 32wT8 (48")                  54HO – 54wT5HO (46")                  CF40 – 40wTT5 (24")                  CF50 – 50wTT5 (24")                  CF55 – 55wTT5 (24")</p>	<p><b>UNV</b></p> <p><u>VOLTAGE</u></p> <p>120                  277                  347                  UNV – Universal voltage, 120-277 volt</p>	<p><b>1/2</b></p> <p><u>NO. OF LAMPS</u></p> <p>(not included)                  2                  4</p>	<p><b>PMW</b></p> <p><u>SHIELDING</u></p> <p>PMW – Perforated metal with white overlay</p>	<p><b>1/2</b></p> <p><u>OPTIONS</u></p> <p>1/2 – One 2-lamp ballast (electronic or non-standard)                  2/2 – Two 2-lamp ballasts (electronic or non-standard)                  EB – Electronic ballast, &lt;20% THD                  EB10I – Electronic ballast, instant start, &lt;10% THD                  EB10R – Electronic ballast, program rapid start, &lt;10% THD                  EBD – Electronic dimming ballast                  E1 – DEB-1 emerg. ballast, T8 or CF, 350-450 lumens (UL dry loc.)                  E7 – DEB-7 emerg. ballast, 390-700 lumens (UL dry loc.)                  E5 – DEB-5 emerg. ballast, T8 or CF, 1100-1400 lumens (UL dry loc.)                  ESST – DEB-5ST emerg. ballast with self test, T8 or CF, 1100-1400 lumens (UL dry loc.)                  GLR# – Fusing, fast blow (# = number of ballasts)</p>
---	---	---	--	--	--

day-brite lighting

## product highlights

Arioso Sconce can provide a specific architectural detail or simply complement a cohesive lighting scheme. In addition, Arioso Sconce brings the lighting to a more intimate level and can provide a secondary layer of lighting to support different functions and atmospheres. Arioso Sconce provides the perfect companion for the recessed Arioso products.

- Slim 9" wide low profile housing is available as 1', 2' & 4' modules.
- Model can be wall or ceiling mounted.
- 4" depth meets ADA requirements when wall mounted.
- Microperforated basket backed with smooth white acrylic eliminates lamp image.
- Companion to Arioso Recessed series.

## cross sections

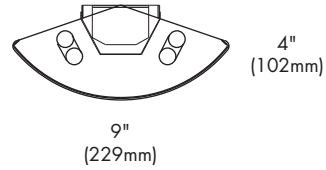

## product availability

Family	Lamps/ Cross Section	Lamps/ Fixture	Lamp Type	Length in. (mm)
AVS	2	2	CF18	12-1/4" (311)
AVS	2	2	CF40, CF50, CF55	23-3/8" (594)
AVS	2 2	2 4	28, 32, 54HO CF40, CF50, CF55	48-1/2" (1232)

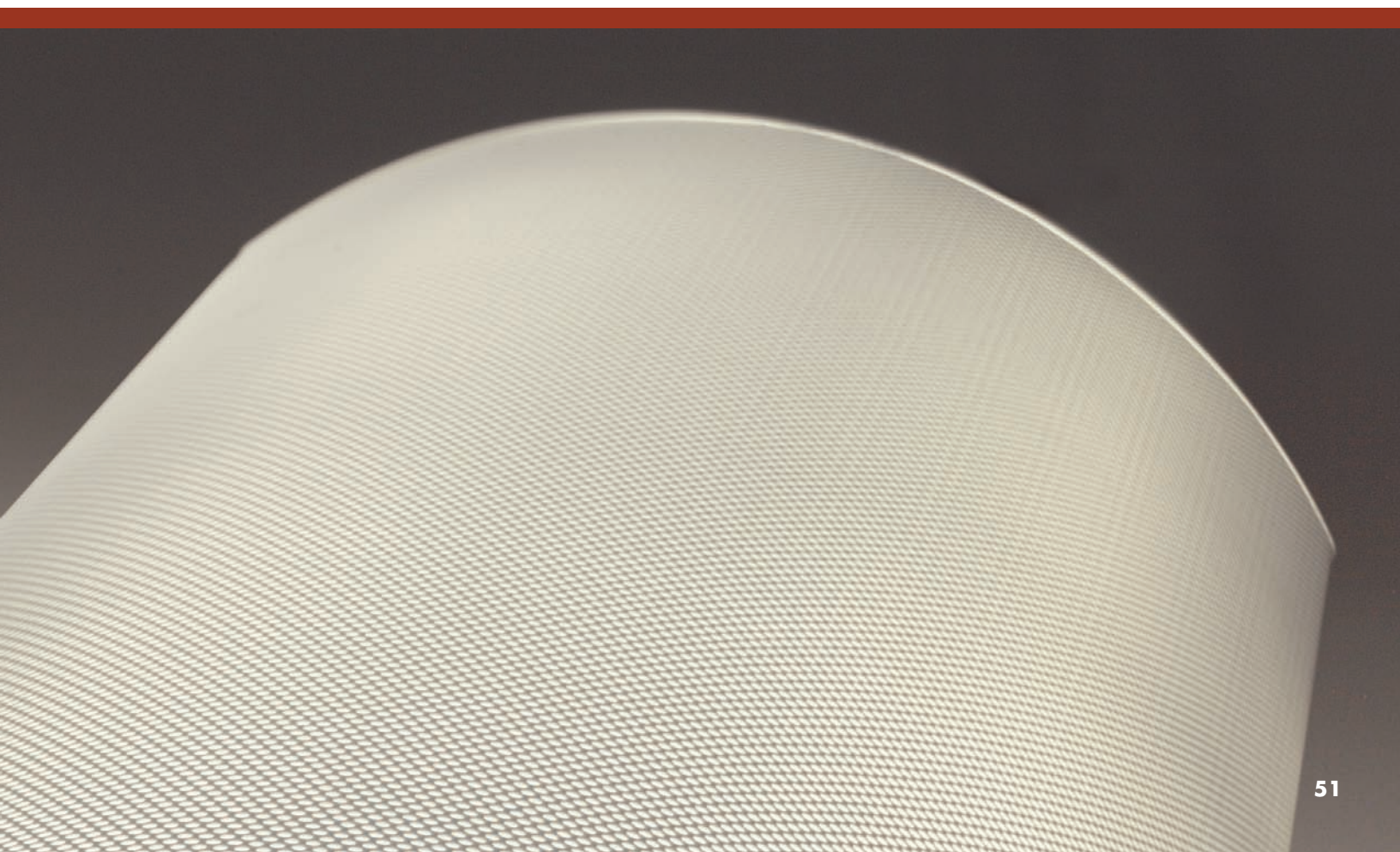

# Arioso Reliefs - Split Basket Sconce



## photometry

AVS2CF40-SPMW-1/2-EB - 2' sconce, perforated with white overlay, 2 lamp 40W TT5

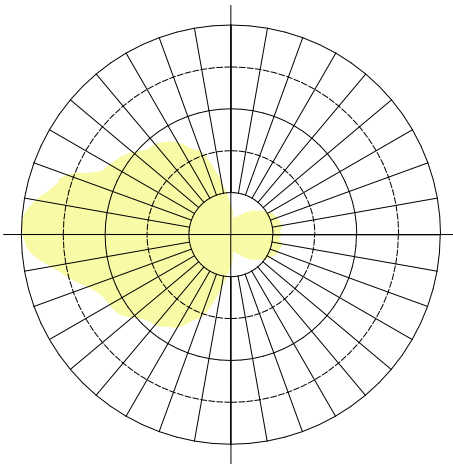

### Reference Information

Efficiency 77.7%

### Light Distribution

Degrees	Lumens	% Lamp	% Fixture
0-30	234	3.7	4.8
0-40	447	7.1	9.1
0-60	1058	16.8	21.6
0-90	2398	38.1	49.0
90-180	2499	39.7	51.0
0-180	4897	77.7	100.0

## ordering information

sample catalog number: AVS2CF40-SPMW-UNV-1/2-EB

<b>AVS</b>	-	<b>SPMW</b>	-	-	-
<u>FAMILY</u>		<u>LAMP TYPE/WATTAGE</u>		<u>VOLTAGE</u>	
AVS - Arioso Sconce		CF18 - 18wTT5 (12") 28 - 28wT5 (46") 32 - 32wT8 (48") 54HO - 54wT5HO (46") CF40 - 40wTT5 (24") CF50 - 50wTT5 (24") CF55 - 55wTT5 (24")		120 277 347 UNV - Universal voltage, 120-277 volt	
	<u>NO. OF LAMPS</u>		<u>SHIELDING</u>		<u>OPTIONS</u>
	(not included) 2 4		SPMW - Two-piece perforated metal with white overlays		1/2 - One 2-lamp ballast (electronic or non-standard) 2/2 - Two 2-lamp ballasts (electronic or non-standard) EB - Electronic ballast, <20% THD EB10I - Electronic ballast, instant start, <10% THD EB10R - Electronic ballast, program rapid start, <10% THD EBD - Electronic dimming ballast E1 - DEB-1 emerg. ballast, T8 or CF, 350-450 lumens (UL dry loc.) E7 - DEB-7 emerg. ballast, 390-700 lumens (UL dry loc.) E5 - DEB-5 emerg. ballast, T8 or CF, 1100-1400 lumens (UL dry loc.) E5ST - DEB-5ST emerg. ballast with self test, T8 or CF, 1100-1400 lumens (UL dry loc.) GLR# - Fusing, fast blow (# = number of ballasts)

day-brite lighting



## product highlights

Arioso Split Basket Sconce adds fresh style while providing a specific architectural detail or complementing a cohesive lighting scheme. In addition, it brings the lighting to a more intimate level and can provide a secondary layer of lighting to support different functions and atmospheres. Arioso Split Basket Sconce provides the perfect companion for the recessed split basket models.

- Slim 9" wide low profile housing is available as 1', 2' & 4' modules.
- Model can be wall or ceiling mounted.
- 4" depth meets ADA requirements when wall mounted.
- Microperforated split basket backed with smooth white acrylic eliminates lamp image.
- Companion to Arioso Split Basket series.

## cross sections

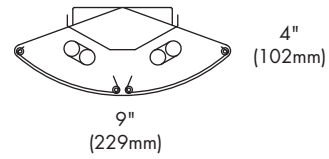

## product availability

Family	Lamps/ Cross Section	Lamps/ Fixture	Lamp Type	Length in. (mm)
AVS	2	2	CF18	12-1/4" (311)
AVS	2	2	CF40, CF50, CF55	23-3/8" (594)
AVS	2 2	2 4	28, 32, 54HO CF40, CF50, CF55	48-1/2" (1232)

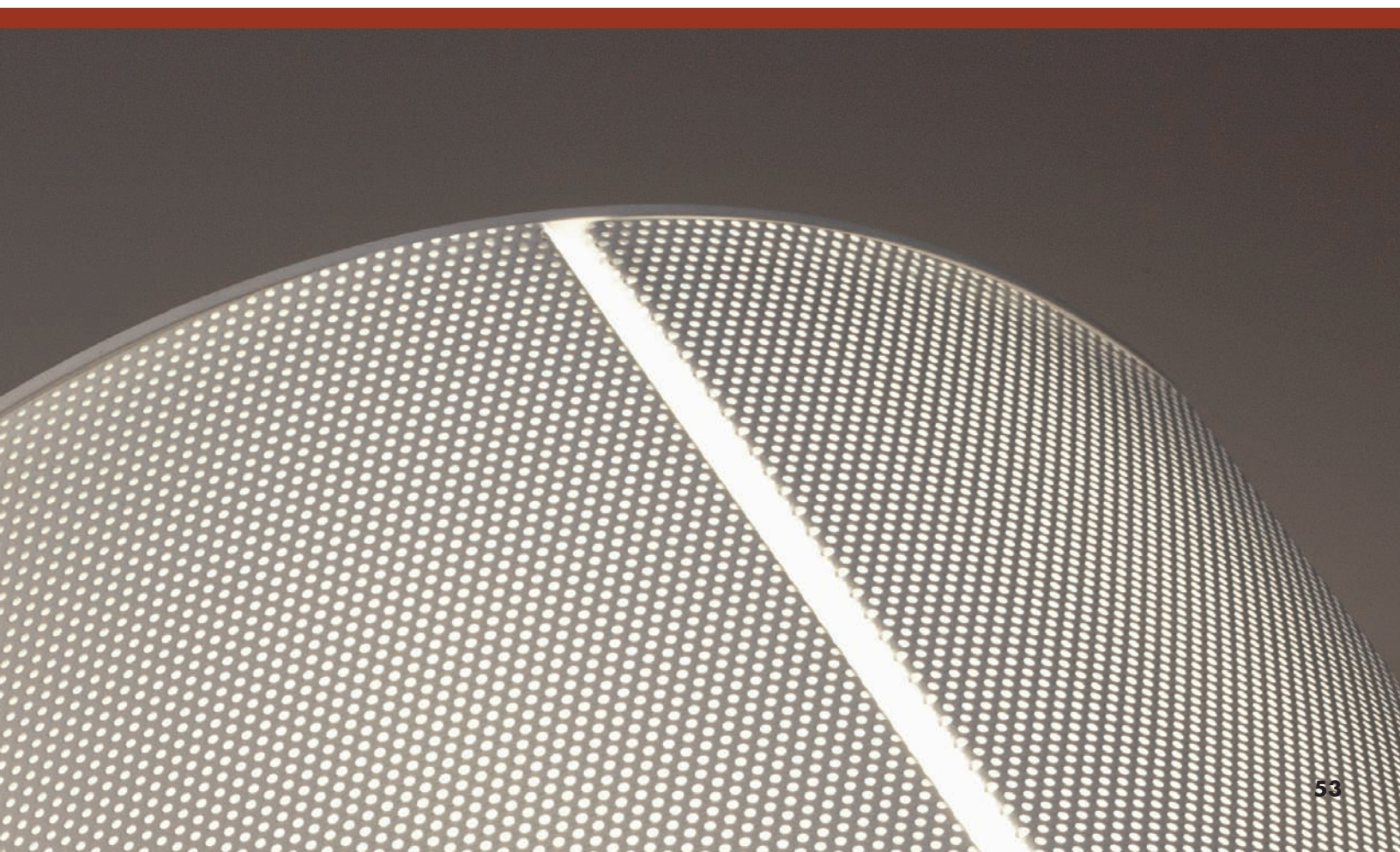

# Arioso Reliefs - Essence Sconce



## photometry

AVSE2CF40-FGL-1/2-EB - 2' sconce, two-piece frosted ribbed glass, 2 lamp 40W TT5

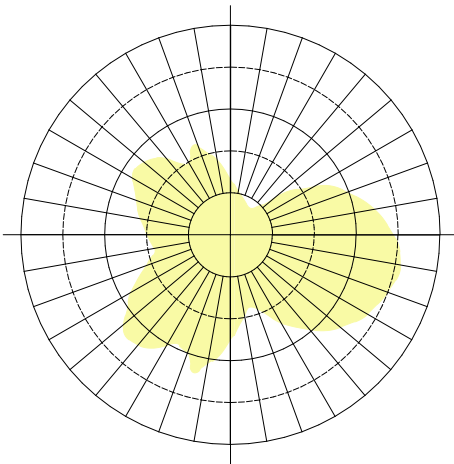

### Reference Information

Efficiency	66.4%
------------	-------

### Light Distribution

Degrees	Lumens	% Lamp	% Fixture
0-30	268	4.3	6.4
0-40	468	7.4	11.2
0-60	1050	16.7	25.1
0-90	2102	33.4	50.3
90-180	2079	33.0	49.7
0-180	4181	66.4	100.0

## ordering information

sample catalog number: AVSE2CF40-FGL-UNV-1/2-EB

<b>AVSE</b>	<b>2</b>	-	<b>FGL</b>	-	-	-
<u>FAMILY</u>	<u>NO. OF LAMPS</u>		<u>LAMP TYPE/WATTAGE</u>		<u>VOLTAGE</u>	<u>OPTIONS</u>
AVSE - Arioso Essence Sconce	(not included) <b>2</b>		CF18 - 18wTT5 (12") CF40 - 40wTT5 (24") CF50 - 50wTT5 (24") CF55 - 55wTT5 (24")		<b>120</b> <b>277</b> <b>347</b> UNV - Universal voltage, 120-277 volt	<b>1/2</b> - One 2-lamp ballast (electronic or non-standard) <b>2/2</b> - Two 2-lamp ballasts (electronic or non-standard) <b>EB</b> - Electronic ballast, <20% THD <b>EB10I</b> - Electronic ballast, instant start, <10% THD <b>EB10R</b> - Electronic ballast, program rapid start, <10% THD <b>EBC</b> - Electronic dimming ballast <b>E1</b> - DEB-1 emerg. ballast, T8 or CF, 350-450 lumens (UL dry loc.) <b>E7</b> - DEB-7 emerg. ballast, 390-700 lumens (UL dry loc.) <b>E5</b> - DEB-5 emerg. ballast, T8 or CF, 1100-1400 lumens (UL dry loc.) <b>E5ST</b> - DEB-5ST emerg. ballast with self test, T8 or CF, 1100-1400 lumens (UL dry loc.) <b>GLR#</b> - Fusing, fast blow (# = number of ballasts)
			<u>SHIELDING</u>			
			FGL - Two-piece frosted ribbed glass			



## product highlights

Arioso Essence Sconce adds stunning architectural detail to create sophistication and intimacy while providing a secondary layer of lighting to support different functions and atmospheres. The diffusers combine frosted, ridged glass with satin-finished natural metal to incorporate premium textures and finishes. Arioso Essence Sconce provides the perfect companion for the recessed Essence series.

- Slim 9-3/4" wide low profile housing is available as 1' & 2' modules.
- 4" depth meets ADA requirements
- Frosted, ridged glass diffusers diffuse lamp image.
- Companion to Arioso Essence series.

## cross sections

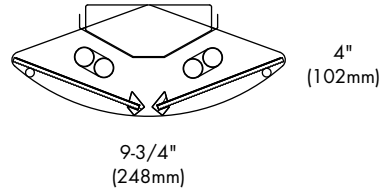

## product availability

Family	Lamps/ Fixture	Lamp Type	Length w/end caps in. (mm)
AVSE	2	CF18	12-1/4" (311)
AVSE	2	CF40, CF50, CF55	24-1/2" (622)

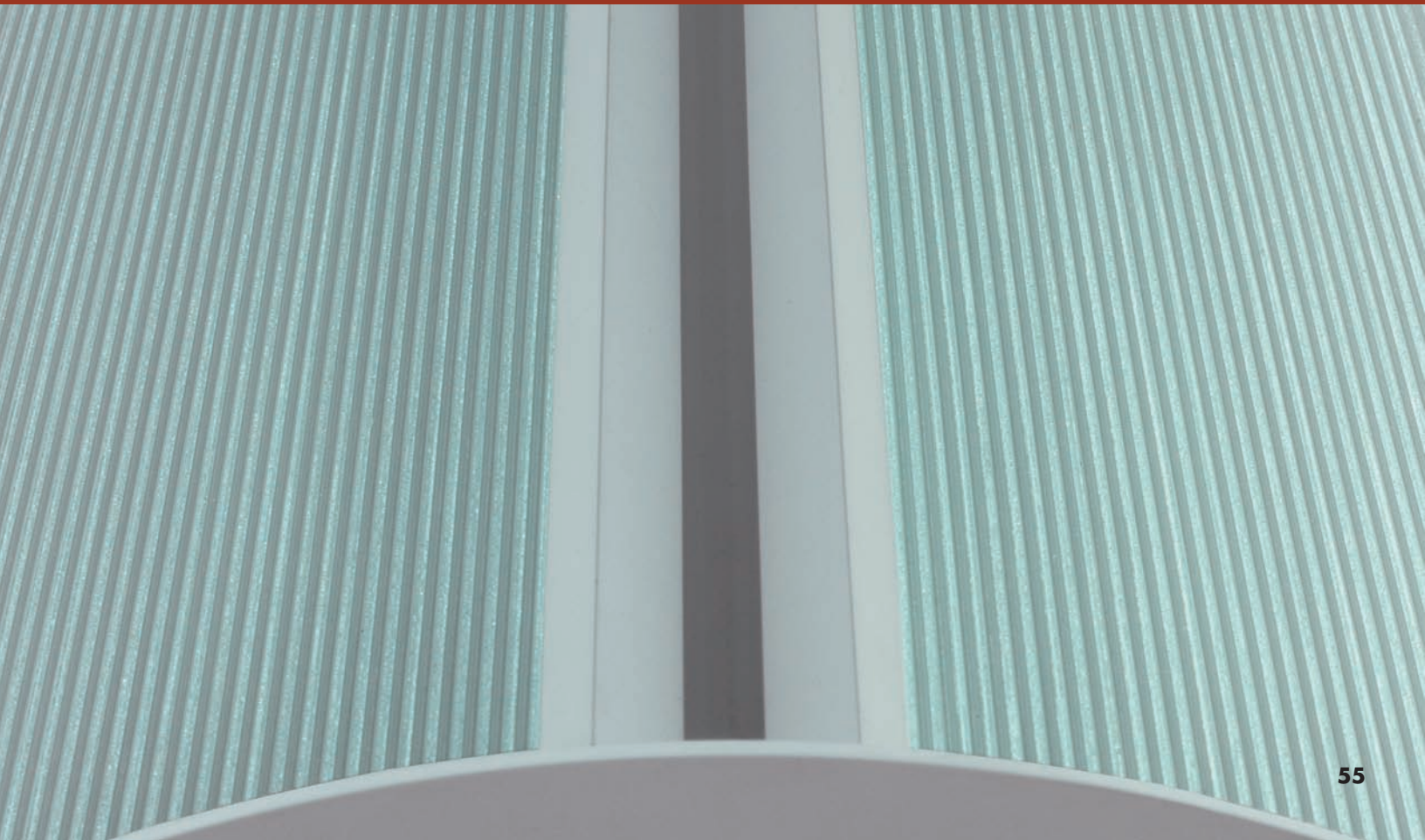



# Arioso Reliefs - Cloud Sconce



## photometry

AVSC2CF18-PMW-1/2-EB - cloud sconce, perforated with white overlay, 2 lamp 18W QT

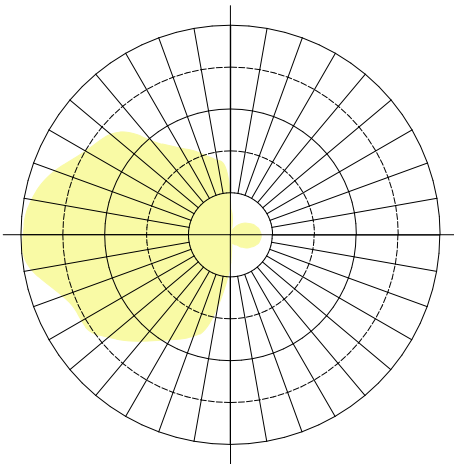

### Reference Information

Efficiency 64.0%

### Light Distribution

Degrees	Lumens	% Lamp	% Fixture
0-30	78	3.1	4.8
0-40	148	5.9	9.3
0-60	357	14.3	22.3
0-90	789	31.6	49.3
90-180	812	32.5	50.7
0-180	1601	64.0	100.0

## ordering information

sample catalog number: AVSC2CF18-PMW-120-1/2-EB

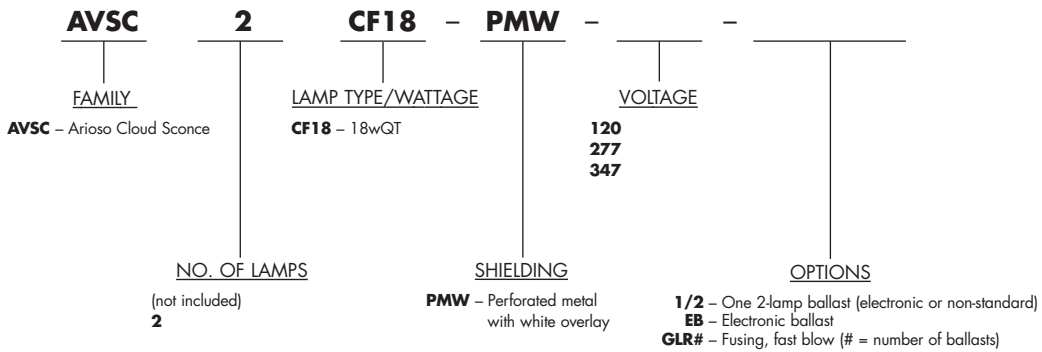

day-brite lighting

## product highlights

Utilizing backlighting to emphasize the shape and to provide soft indirect illumination within the space, Arioso Cloud Sconce is a dramatic choice to make an architectural statement. Like the other sconce choices, this model can reinforce a specific architectural detail or simply complement a cohesive lighting scheme. It can bring the lighting to a more intimate level and provide a secondary layer of lighting to support different functions and atmospheres. Its rounded profile is the perfect companion for the Recessed Cloud or Orb models.

- 13-3/4" round housing accommodates (2) 18 watt QT lamps.
- Microperforated face backed with smooth white acrylic eliminates lamp image.
- Provides soft frontal glow for awareness of the light source.
- Backlighting emphasizes the shape & provides soft indirect illumination.
- 4" depth meets ADA requirements when wall mounted.
- Complements the Arioso Cloud & Orb series for a consistent cohesive appearance throughout the space.

## cross sections

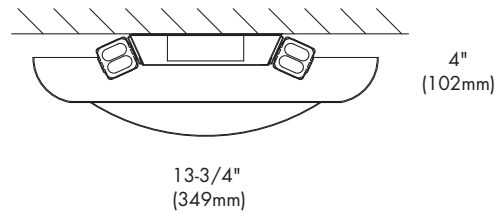

## product availability

Family	Lamps/ Fixture	Lamp Type	Length in. (mm)
AVSC	2	CF18	13-3/4" (349)

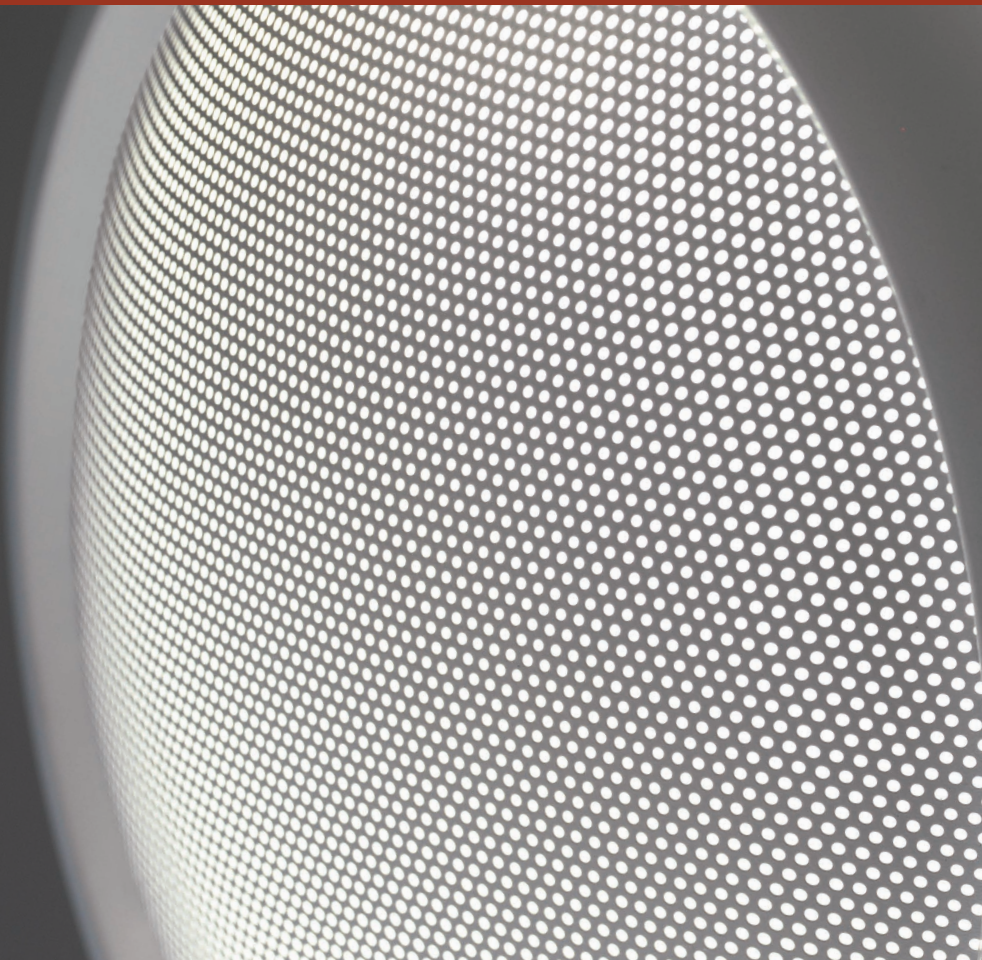

# Arioso Reliefs - Square Sconce



## photometry

AVSQ2CF18-PMW-1/2-EB - cloud sconce, perforated with white overlay, 2 lamp 18W QT

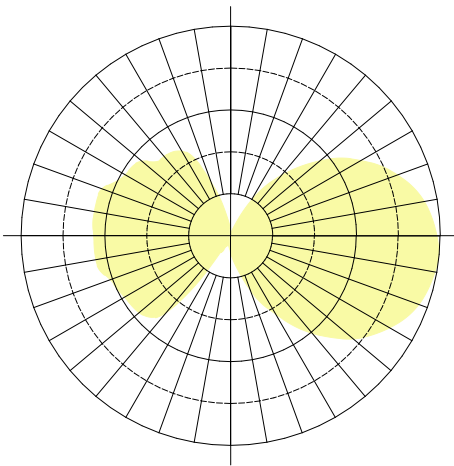

### Reference Information

Efficiency	27.0%
------------	-------

### Light Distribution

Degrees	Lumens	% Lamp	% Fixture
0-30	15	0.6	2.2
0-40	36	1.4	5.3
0-60	126	5.0	18.7
0-90	338	13.5	50.1
90-180	336	13.4	49.9
0-180	674	27.0	100.0

## ordering information

sample catalog number: AVSQ2CF18-PMW-120-1/2-EB

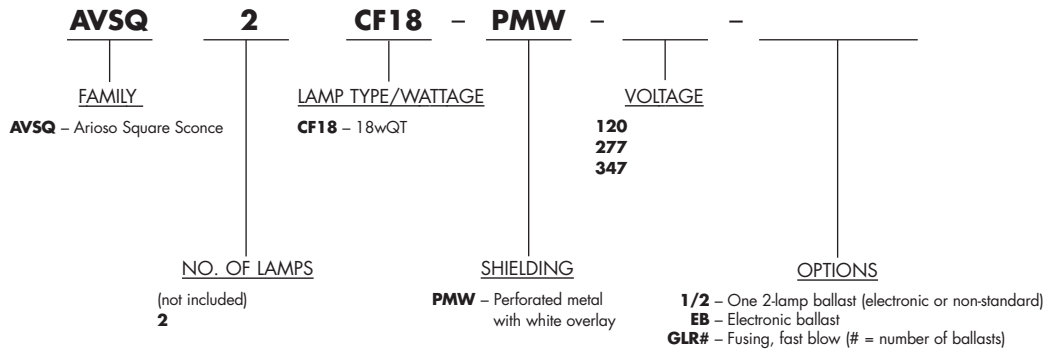

day-brite lighting



## product highlights

Arioso Square Sconce is a dramatic choice to make an architectural statement, utilizing backlighting to emphasize the shape and to provide soft indirect illumination within the space. This model, like the other sconce options, can reinforce a specific architectural detail or simply complement a cohesive lighting scheme. Arioso Square Sconce brings the lighting to a more intimate level and provides a secondary layer of lighting to support different functions and atmospheres. Its square profile is the perfect companion for several models within the Arioso family including the Side Basket, Surface and Floating Frame.

- 13-1/2" square housing accommodates (2) 18 watt QT lamps.
- Microperforated face backed with smooth white acrylic eliminates lamp image.
- Provides soft frontal glow for awareness of the light source.
- Backlighting emphasizes the shape & provides soft indirect illumination.
- 4" depth meets ADA requirements when wall mounted.
- Complements several models within the Arioso family including the Side Basket, the Surface and the Floating Frame for a consistent cohesive appearance throughout the space.

## cross sections

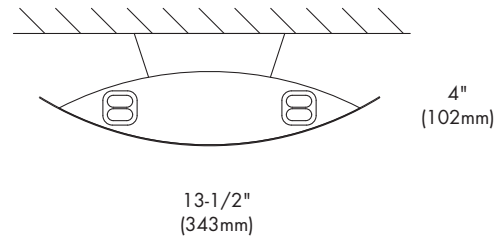

## product availability

Family	Lamps/ Fixture	Lamp Type	Length in. (mm)
AVSQ	2	CF18	13-1/2" (343)



# Arioso Reliefs - Wall



## photometry

AVW232-PMW-1/2-EB-LENS - wall unit, perforated with white overlay with optional top lens, 2 lamp T8

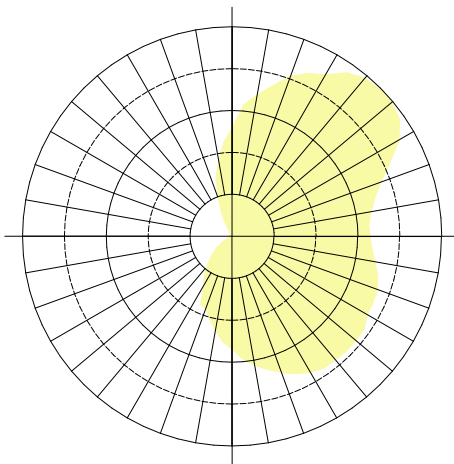

Maintained Illumination Table - Sq. Ft. / Luminaire

Room Width Room Height	4' 2 Lamp T8 w/uplight			
	Approx. Area (sq. ft) per luminaire 30ft-c	50ft-c	70ft-c	100ft-c
5	66	40	-	-
2	44	-	-	-
1	31	-	-	-

80-50-20 Reflectances (Ceiling-Wall-Floor)  
LLF = 0.75 2850 Lumens/Lamp very clean  
Room width divided by room height = 5 or more, 2 or 1

Reference Information

Efficiency 51.4%

Light Distribution

Degrees	Lumens	% Lamp	% Fixture
0-30	308	5.4	10.5
0-40	510	8.9	17.4
0-60	940	16.5	32.1
0-90	1438	25.2	49.1
90-180	1492	26.2	50.9
0-180	2930	51.4	100.0

## ordering information

sample catalog number: AVW232-PMW-UNV-1/2-EB-LENS

**AVW** - **PMW** - **UNV** - **1/2** - **EB** - **LENS**

<p><b>FAMILY</b></p> <p>AVW - Arioso Wall</p>	<p><b>LAMP TYPE/WATTAGE</b></p> <p>14 - 14wT5 (22") 17 - 17wT8 (24") 24HO - 24wT5HO (22") 21 - 21wT5 (34") 25 - 25wT8 (36") 39HO - 39wT5HO (34") 28 - 28wT5 (46") 32 - 32wT8 (48") 54HO - 54wT5HO (46") CF40 - 40wTT5 (24") CF50 - 50wTT5 (24") CF55 - 55wTT5 (24")</p>	<p><b>VOLTAGE</b></p> <p>120 277 347 UNV - Universal voltage, 120-277 volt</p>	<p><b>SHIELDING</b></p> <p>PMW - Perforated metal with white overlay</p>	<p><b>OPTIONS</b></p> <p>1/1 - One 1-lamp ballast (electronic or non-standard) 1/2 - One 2-lamp ballast (electronic or non-standard) CC - Custom color (RAL number or color chip required) CM - Canadian Market DEK - Factory installed decorative ends EB - Electronic ballast, &lt;20% THD EB10I - Electronic ballast, instant start, &lt;10% THD EB10R - Electronic ballast, program rapid start, &lt;10% THD EBD - Electronic dimming ballast E11LP - DEB-11LP emerg. ballast, T8, 450 lumens, UL dry loc.* E7LP - DEB-7LP emerg. ballast, T5/T5HO/T8, 600-700 lumens, UL dry loc.* E5LP - DEB-5LP emerg. ballast, T8, 1375-1400 lumens, UL dry loc.* E6LP - DEB-6LP emerg. ballast, T5/T5HO, 1230 lumens, UL dry loc.* GLR# - Fusing, fast blow (# = number of ballasts) LENS - Uplight w/lens</p>
<p><b>NO. OF LAMPS</b></p> <p>(not included) 1 2</p>				

\*Consult manufacturer's rep. for emergency ballast availability.



## product highlights

Ariosso Wall is an ideal choice as an alternative to a lighting cove, providing excellent perimeter illumination to wash the ceiling and improve the general illumination throughout the space. Used alone, Ariosso Wall can provide low level lighting perfect for small offices, conference spaces and lobbies and stairways; when layered with other Ariosso offerings, Ariosso Wall can provide subtle variations in lighting levels as the application requires.

- Maximum flexibility with 2', 3' & 4' modules.
- Microperforated basket backed with smooth white acrylic eliminates lamp image.
- Die-cast aluminum end caps mount easily with no exposed hardware.
- Standard solid cover on top or optional top lens with additional uplight available.
- ADA compliant with 4" projection.
- Available for individual or row mounting.
- High efficiency lamp/ballast, bi-level switching, dimming and emergency ballasts are offered as standard options.
- Companion to Ariosso Recessed series and wall sconce.

## cross sections

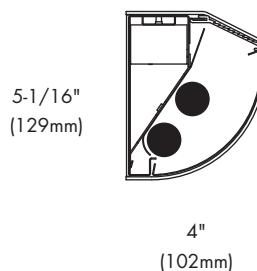

## product availability

Size	Family	Lamps/ Fixture	Lamp Type	Length w/end caps in. (mm)*
2'	AVW	1, 2 1	14, 17, 24HO CF40, CF50, CF55	25-1/2" (648)
3'	AVW	1, 2	21, 25, 39HO	37-1/2" (953)
4'	AVW	1, 2	28, 32, 54HO	49-1/2" (1257)

\*Note: Length without end caps is 24", 36", and 48".





# Arioso 2x2



Recessed

14

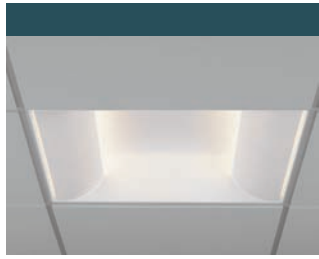

Side Basket

16



Split Basket

18



Acrylic

20



Semi-Recessed

22



Mid-Depth Semi-Recessed

24



Air Handling

26



Louver

32

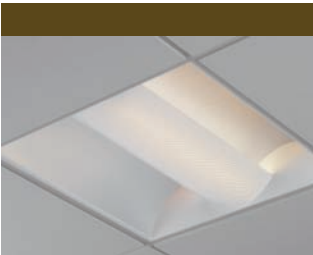

Metal

34

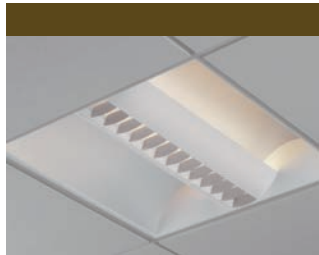

Metal Louver

36

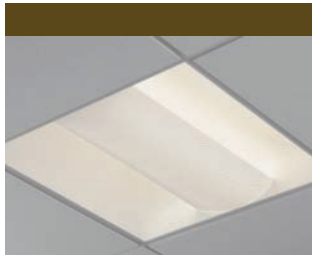

Essence Perf

38

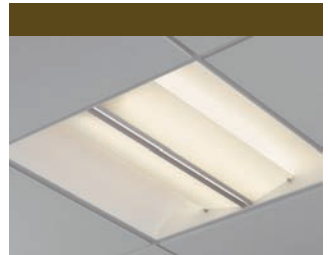

Essence Glass

38

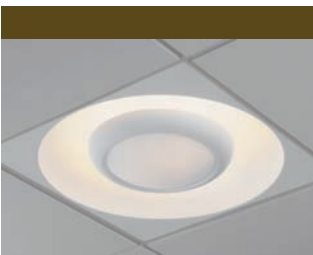

Cloud

40

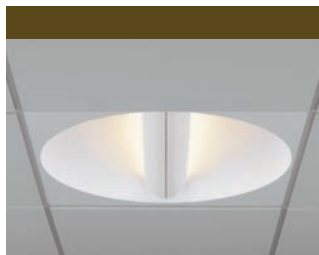

Orb

42



Surface

46



Floating Frame

48

# Arioso 1x1

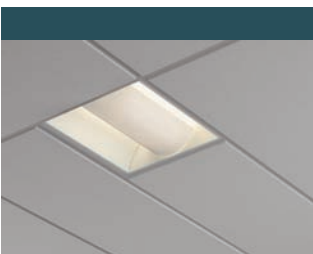

Recessed

14

# Arioso 1x2

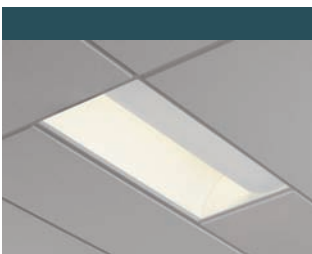

Asymmetric

28

# Color Legend



Arioso Core



Arioso Sensations



Arioso Reliefs

## Arioso 2x4



Recessed

14

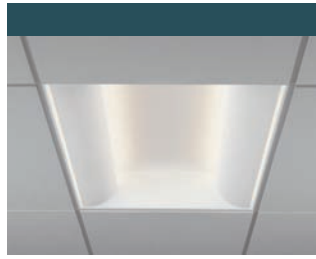

Side Basket

16



Split Basket

18



Acrylic

20



Semi-Recessed

22



Mid-Depth Semi-Recessed

24



Air Handling

26

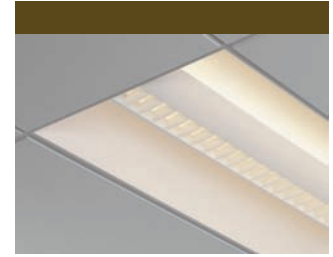

Louver

32



Metal

34

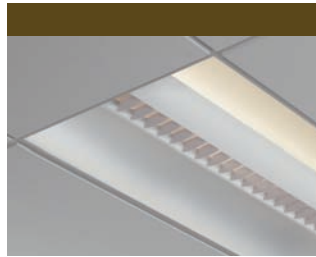

Metal Louver

36



Essence

38



Surface

46

## Arioso 1x4



Recessed

14



Split Basket

18



Semi-Recessed

22

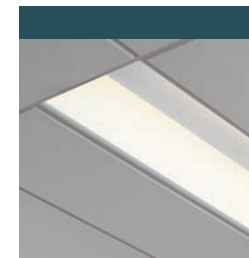

Asymmetric

28

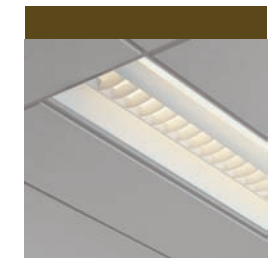

Louver

32

## Arioso Sconces

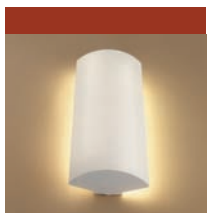

Sconce

50



Split Basket

52



Essence

54



Cloud

56

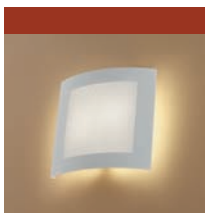

Square

58



Wall

60



Form #: **137.0608CT7.5M**

Day-Brite Lighting is a Philips group brand. All rights reserved 2008.

776 South Green Street • Tupelo, MS 38804  
phone 662.842.7212 • fax 662.841.5501 • [www.daybritelighting.com](http://www.daybritelighting.com)

**CANADIAN DIVISION**

189 Bullock Drive • Markham, Ontario L3P 1W4  
phone 905.294.9570 • fax 905.294.9811



This brochure was printed on FLO recycled paper.

FLO is an environmentally responsible paper containing 10% Post Consumer Waste. FLO is 3rd party certified to come from a well managed forest.