

# Arieta™

## Architectural

## LED Area

## Luminaires

### AR13, AR18

Area lighting for parking  
lots, campuses, office  
complexes, streets, bicycle  
paths, and public parks



# LEOTEK®

[www.leotek.com](http://www.leotek.com)



# High Performance. Elegant Silhouette.

The sleek design and minimal profile of Arieta™ creates an appealing and unobtrusive daytime form.

City of Bellevue, Washington



## Numerous Applications

Arieta™ is available in two housing sizes and a wide range of lumen packages.

This enables Arieta™ to fit a broad range of applications from pedestrian walkways using 15 ft. poles to large parking lots using 40 ft poles.

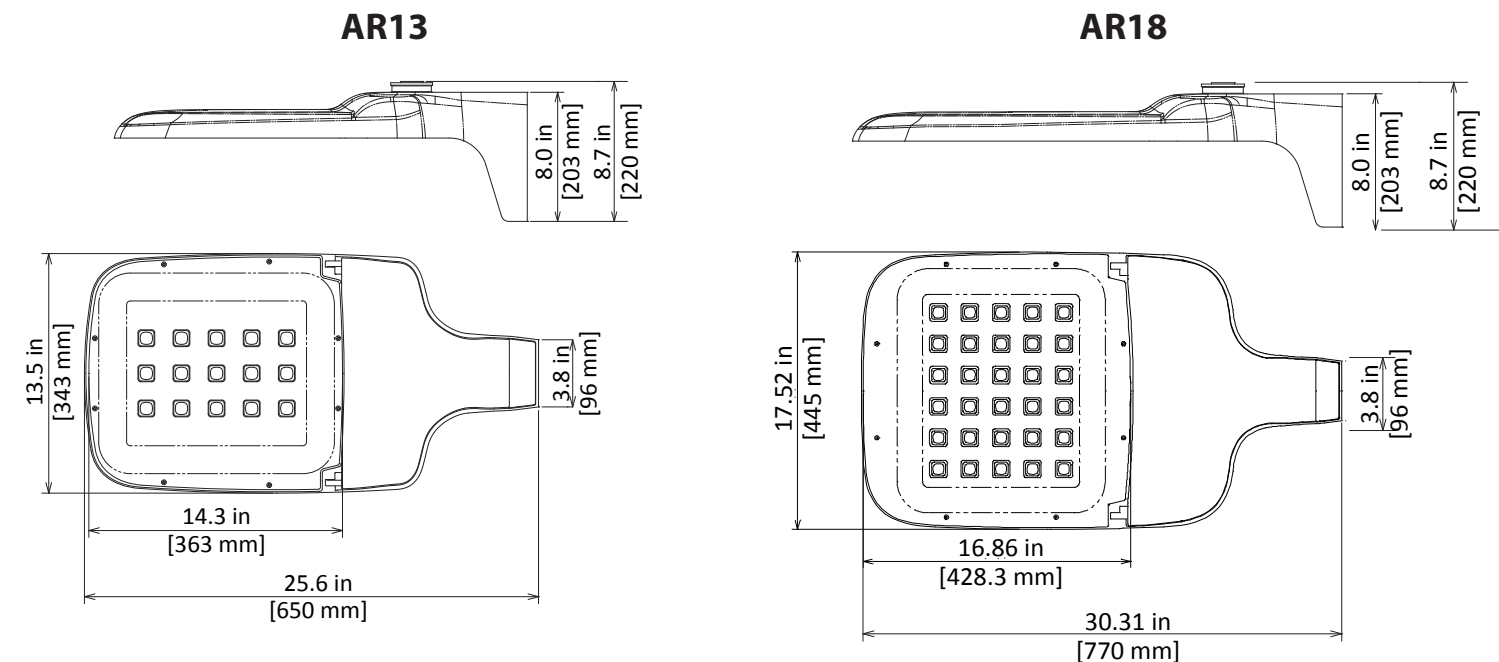

With energy savings of up to 76% over HID sources and reduced maintenance costs, Arieta™ offers the most competitive payback of any architectural LED area luminaire.

Typical HID Replaced	Arieta Product™	Lumens	Luminaire Power	Luminaire Efficacy	Energy Savings
250W MH	AR13-10M2 @ 700mA	10,000 lm	87 W	115 lm/W	68%
400W MH	AR13-20M2 @ 700mA	19,800 lm	166 W	119 lm/W	62%
1000W MH	AR18-30M2 @ 700mA	29,300 lm	262 W	112 lm/W	76%

A comprehensive HID to Arieta replacement chart is available on our website [www.leotek.com](http://www.leotek.com)



Leotek believes that good design integrates simplicity and functionality. The Arieta™ is built with durable high-strength materials and reliable components, and is backed by Leotek's 10-Year Warranty and 20 years of experience building LED lighting products.

### Single-Cast Housing

The single-cast Arieta™ housing is made of corrosion-resistant aluminum and provides a continuous thermal path from the LED light engine to ambient air. This enables passive heat dissipation along the entire length of the luminaire.

This design approach makes it possible to introduce an elegant, low-profile luminaire without compromising efficiency.

All Arieta™ luminaires meet a 5000-hour salt spray specification through the use of low-copper content alloys and a polyester powder coat finish.

### Robust, Efficient Light Engines

The 100,000-hour rated (IP66 Rated) integrated LED light engine design minimizes parts and complexity while offering long life and reliability.

High-uniformity LED optics are constructed of durable optical polycarbonate that is impact and UV resistant to ensure efficient light transmission over the life of the luminaire.

Arieta™ light engines use an array of discrete LEDs. Discrete LEDs are designed to offer better maintained light output than large chip-on-board LEDs. There is less qualitative glare since the LED light sources are distributed, not concentrated in a small area.

### Standard LED Color Temperatures

#### 3000K (Warm White)

Color similar to incandescent lamps. Accepted by the International Dark-Sky Association as dark-sky friendly, but lower efficacy than neutral white LEDs.

#### 4000K (Neutral White)

Most popular option for street land area lighting; offers no compromise in efficacy with color similar to moonlight.

#### 5000K (Cool White)

Cool color with perceived brighter appearance; efficacy is similar to neutral white LEDs.

### Rigorous Testing and Certification Process

Each Arieta™ luminaire is carefully assembled and tested at Leotek's facility in San Jose, California. The light engines are 100% tested prior to assembly. Every luminaire is 100% performance tested for proper light output and wattage after a 2-hour "burn-in" period.

### Control Ready for Wireless Nodes

When Arieta™ luminaires are being installed with a wireless control system, the simplest approach is to specify the control-ready option PCR5-CR or PCR7-CR. If you do not plan on installing wireless nodes immediately, but want to have the option to do so in the future and you want the positive-lock current selector capability to field adjust light levels, then you should specify PCR5 or PCR7

### Surge Protection

Standard maximum protection to 20kV/10kA



### Choice of Standard Finishes

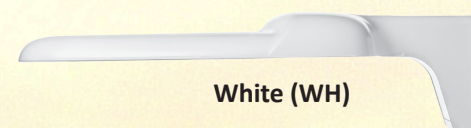

White (WH)



Dark Bronze (DB)



Black (BK)



Natural Aluminum (NA)



Gray (GY)

### Light Level Control Options

The dimmable power supply enables field-adjustable light levels with the standard positive-lock current selector. Continuous dimming is also available on all Arieta™ luminaires using a wireless dimming node (supplied by others).

### Power Supplies

Arieta™ luminaires are designed with power supplies that are rated for 100,000 hours of life with standard 1 - 10V dimming.







# Easy Field-Tuning of Luminaires

Leotek luminaires feature a variety of options to accommodate “field-tuning” of light levels and light distribution. In addition, options are available to facilitate the integration of wireless controls.

## Field-Tuning of Light Levels

Arieta™ luminaires include a standard dimmable 1-10V power supply with a positive-lock LED current selector. This enables end users to easily change light levels in the field if necessary. The positive-lock current selector ensures light levels aren’t changed accidentally during installation.



## Light Trespass Shielding

House Side Shield options are available for light trespass control that can be factory or field-installed.

The House Side Shield cuts the light off ½ mounting height behind the pole to eliminate light trespass.

The shields are easily installed and are flush to the housing, so they add no additional wind loading to the pole and are virtually unnoticeable.



## Four Lighting Distributions

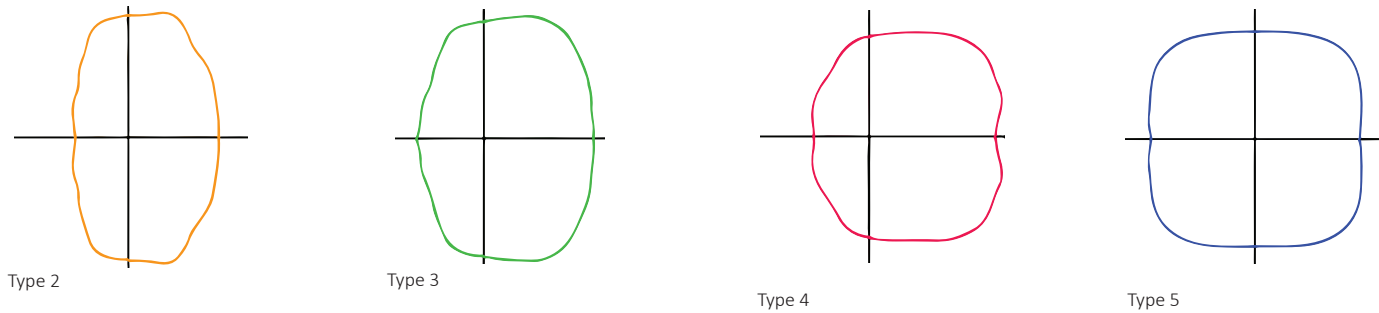

Micro-lens Optics produce IES Type 2, Type 3, Type 4 or Type 5 distributions for Roadway and Area lighting applications. Factory rotated optics can be ordered for special applications.

Dark Sky Friendly with a zero uplight BUG rating (0% total lumens above 90°).

# Luminaire Control Options

## PCR3, PCR5 and PCR7 Options (ANSI C136.41 Compliant)

- Field-adjustable positive-lock current selector to change light output
- All factory drive current settings available
- 1-10V leads factory-wired to current selector with molex style connectors
- Field-changeable connectors quickly enable wireless node dimming, if desired in the future
- Also accepts standard (3-wire) photocell

## PCR5-CR and PCR7-CR Options (ANSI C136.41 Compliant)

- Factory-wired for “control-ready” 1-10V dimming with wireless node (by others)
- Must specify maximum drive current (either 700mA or 1A)
- Also accepts standard (3-wire) photocell

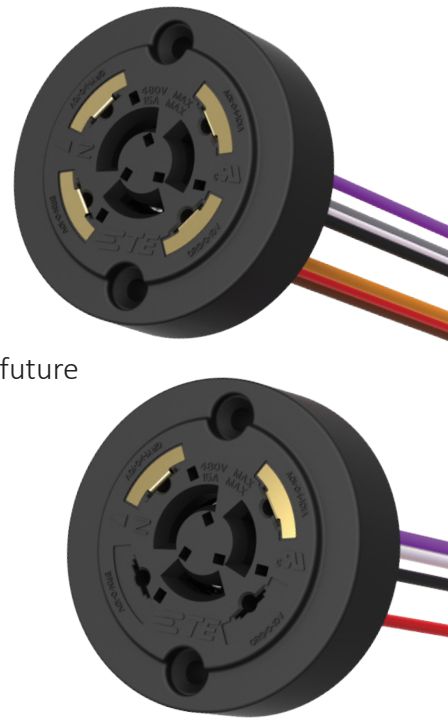

## Optional Photocontrol Receptacle (PCR)

Accepts Standard Photocell



## PCR5, PCR7, PCR5-CR, PCR7-CR Options

Accepts Wireless Control Node or Standard Photocell

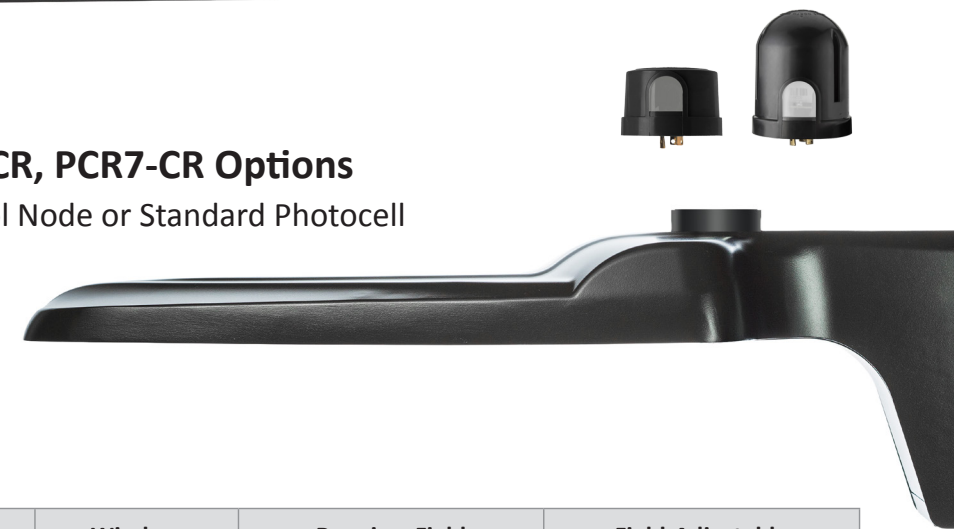

## Comparison Chart

Option Code	Receptacle	Wireless Dimming Node Control-Ready	Requires Field Connections for Wireless Node	Field-Adjustable Drive Current to Change Light Output
PCR	3-Wire	N/A	N/A	Yes
PCR5 <sup>1</sup>	5-Wire	No	Yes	Yes
PCR7 <sup>1</sup>	7-Wire	No	Yes	Yes
PCR5-CR <sup>2</sup>	5-Wire	Yes	No	No
PCR7-CR <sup>2</sup>	7-Wire	Yes	No	No

1. Current selector included to allow field selection of desired current to change light output.  
 2. Furnished “control-ready” at factory for wireless node (by others). Control-ready option is set at luminaire’s maximum drive current (refer to specification sheet).



# Motion Sensor-Ready

Multi-cell, multi-tier Fresnel lens with 360° view detects unobstructed motion.



Two sensor ranges are available

MSL7 - Up to 40' Mounting Height

Lens Coverage Side View

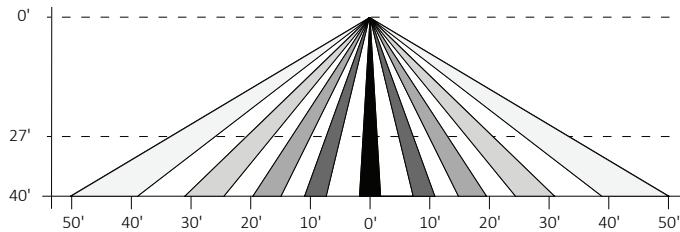

MSL3 - Up to 20' Mounting Height

Lens Coverage Side View

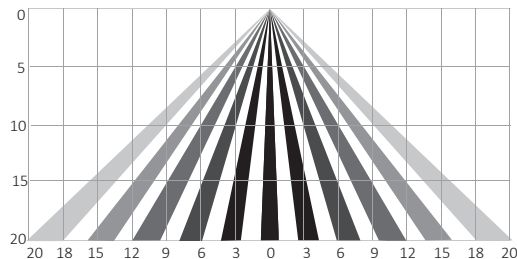

Dimmable power supply is standard: a cost-effective solution for motion sensor controlled dimming

California Title 24 Control compliant

UL and cUL listed, IP66 rated

FSIR-100 configuration tool allows motion sensor to be field-adjusted as required.

For details, search FSIR-100 User Guide at [www.wattstopper.com](http://www.wattstopper.com).

# Part-Night Dimming Controls

Arieta's Part Night Dimming (PND) option enables significant energy savings by automatically dimming the luminaire during early morning hours when infrequent use is expected. Factory programmed dimming profiles automatically take into account seasonal changes based on geographical location by continuously monitoring the nighttime midpoint. This option is fully compatible with photocells and time-clock devices. Available factory programmable PND profiles are detailed on the Specification Data Sheet.

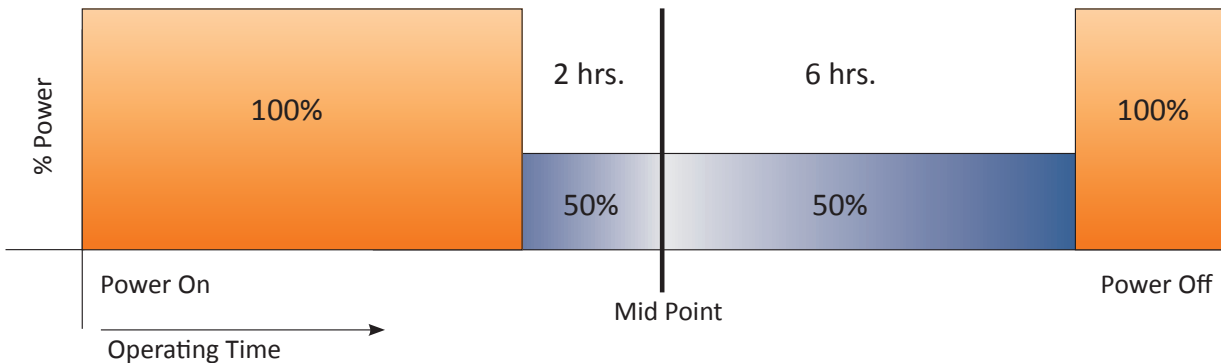

# Universally Retrofittable

The perfect replacement for the shoebox luminaire

## Universal Mounting

Arieta's smartly designed Universal Mount allows a single installer in a bucket truck to easily retrofit an existing HID luminaire in minutes on virtually all existing area lighting poles without drilling additional holes.

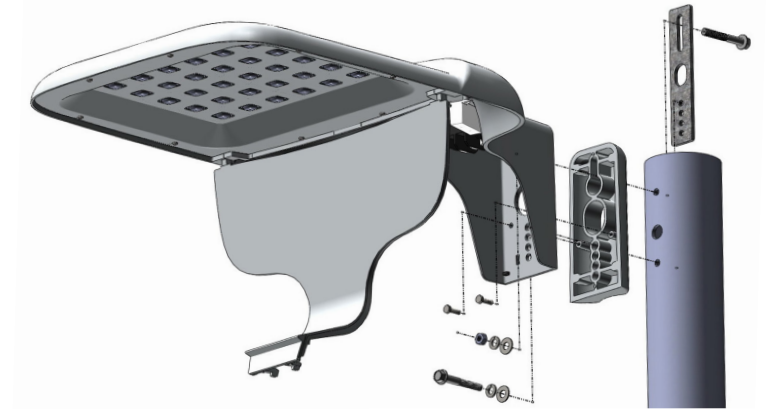

To view installation video visit [www.leotek.com](http://www.leotek.com)

Arieta™ easily mounts to square or round poles. Round Pole Adapter (RPA) required for round poles, as shown.

## Mounting Accessories

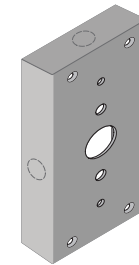

Wall Mounting Plate (WM)

For installation on flat surfaces. Includes side knock-outs to accommodate surface wiring conduit.

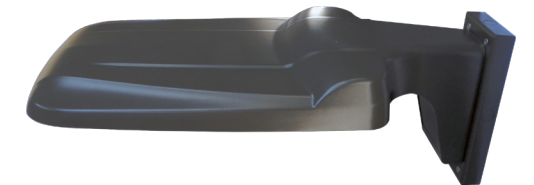

WM – Wall Mounting Plate

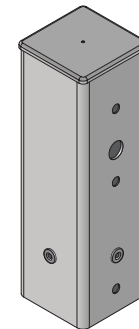

Square Pole Top Fitters (PTF)

4" square fitter for use with 2.38-inch outside diameter tenons, 4-6" tall.



PTF1 – 1 Luminaire



PTF4 – 2, 3 or 4 Luminaires at 90 Degrees



PTF2 – 2 Luminaires at 180 Degrees

\*Accessories available in standard Arieta finishes.



Visit [Leotek.com](http://Leotek.com) to learn more about our innovative LED Lighting products



GreenCobra™

The GreenCobra Series has become the industry standard for many cities, utilities and DOTs throughout North America with hundreds of thousands of units installed and counting. The superior optical performance, innovative mechanical features that facilitate installation and maintenance, and the familiar daytime form all contribute to the GreenCobra's success. Four models deliver the lumen packages and appropriate housing scale for multiple mounting heights: GreenCobra Jr. (GCJ), GreenCobra Midsize (GCM), GreenCobra (GCL) and GreenKingCobra (GC2).



Eseta™

Eseta's subtly distinctive form harmonizes with architecture without altering the building aesthetic. Eseta™ features ultra-high efficiency LED lighting with up to 100 lumens/watt, emergency battery system, two targeted distributions, innovative glare control, and motion sensor compatibility. Cold-weather rated for temperature range rating of -4°F to 140°F (-20°C to +60°C). An appealing and easy choice for retrofit applications.



E-Cobra™

Perfectly suited for street and roadway lighting applications, the E-Cobra™ provides a wide variety of lumen packages and light distributions. It features tool-less entry and removable power door for ease of maintenance, and the patent-pending internal heat management system assures long LED life and minimal lumen depreciation without external heat fins.



Leotek Electronics USA LLC, located in California's Silicon Valley, is celebrating over twenty years as an LED lighting manufacturer, and is a leading supplier of LED street lights worldwide. Globally recognized as a pioneer in light-emitting diode technology, and with millions of LED products installed worldwide, the company has a historical legacy of proven performance. Leotek offers innovative LED lighting products for applications encompassing traffic, transit, street, and area lighting. Leotek street and area lighting products are assembled in the USA.

With ongoing research and development, continuous improvement of existing products, and the introduction of innovative new products, Leotek is committed to developing solid-state technologies that are reliable, long-lasting, and energy efficient.

1955 Lundy Ave., San Jose, CA 95131  408.380.1788

© 2016 Leotek Electronics USA. All Rights Reserved.  
Arieta Brochure\_v081216.  
Specifications subject to change without notice.



To learn more visit [www.leotek.com](http://www.leotek.com) or contact a Leotek lighting agent 408.380.1788