

2D LED LOWBAY FITTING LED Wall Mount Fixture

Model: SLEL-LB-20



S. L. LED Application Ltd.
www.sl-led-application.com

Features

Applications



SAMSUNG Middle Power LED Series 2835 LM281B



- 30 Days ATS self test function
- Maintenance friendly can change individual parts
- Water and dust proof with IP65 standard
- Save energy with sensor detect function
- Save manpower to maintenance
- Save cost by changeable parts

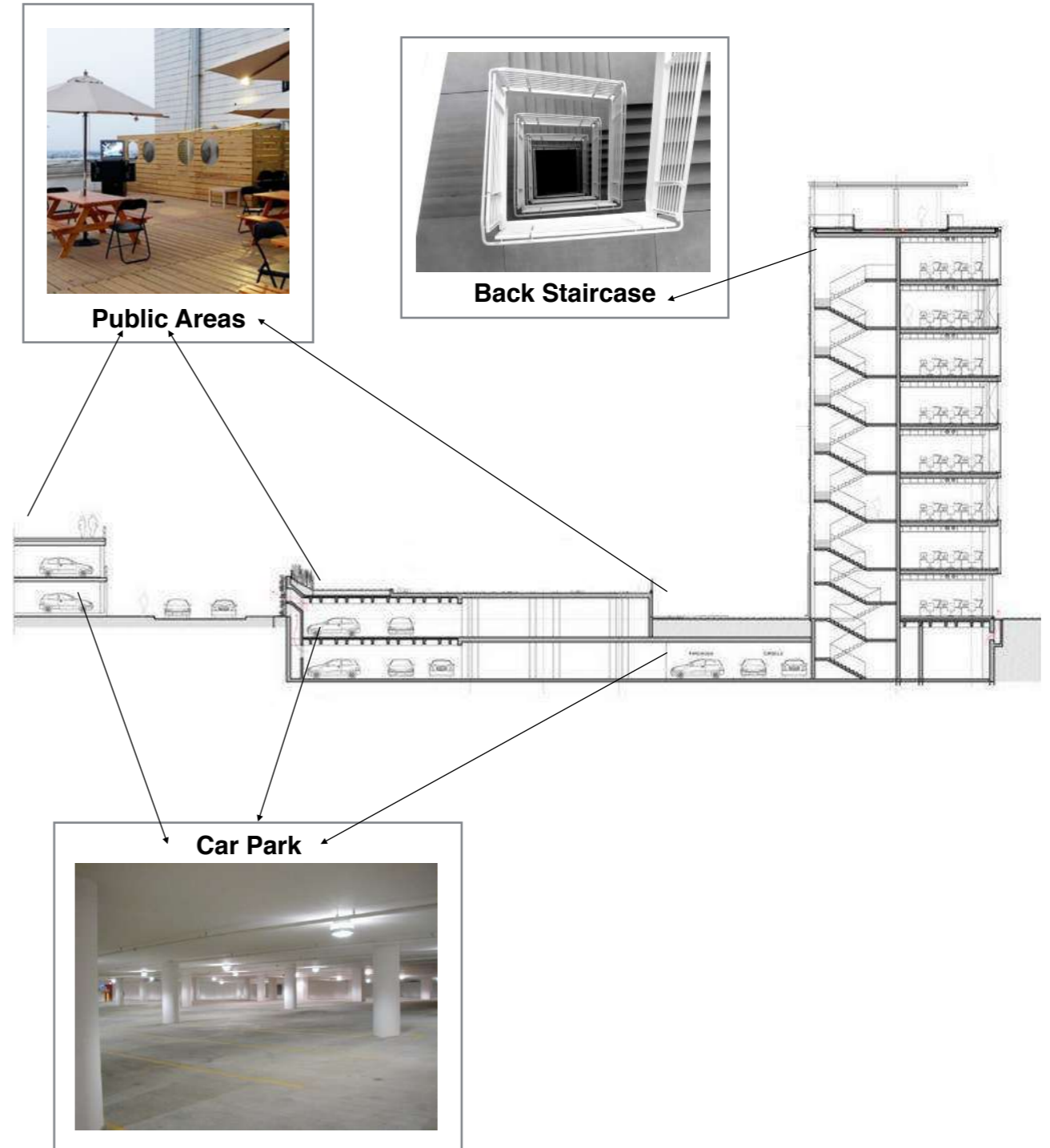
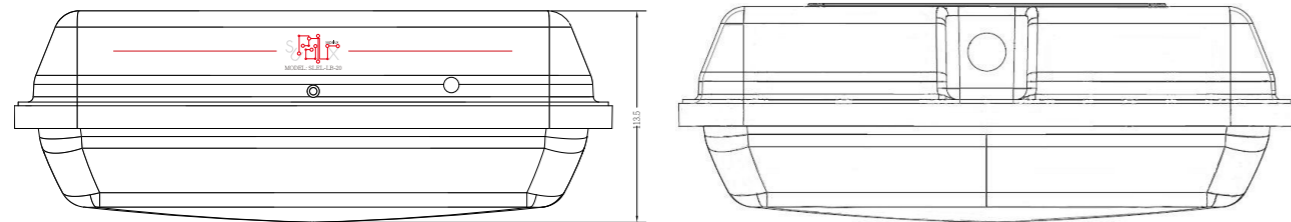



Intelligence Design

Product Explosion Diagram & Product Description

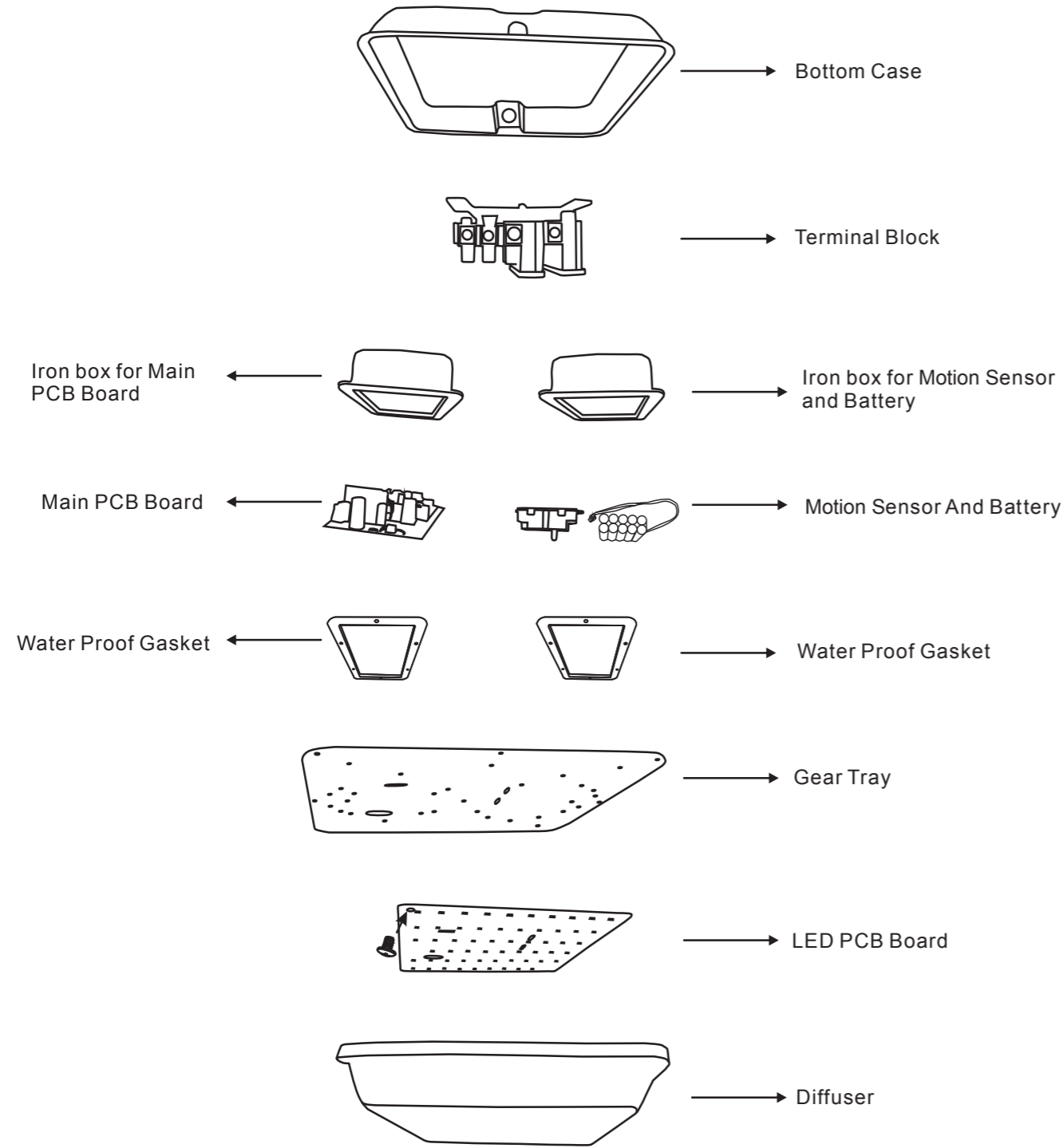

Replaceable and Changeable Parts

- (1) Main PCB Board
- (2) Motion Sensor
- (3) Battery
- (4) LED PCB Board
- (5) Diffuser

LED Wall Mount Fixture



Luminance Intensity

Distribution Diagram

Light Distribution Curve SLEL-LB-20 [Unit:cd]

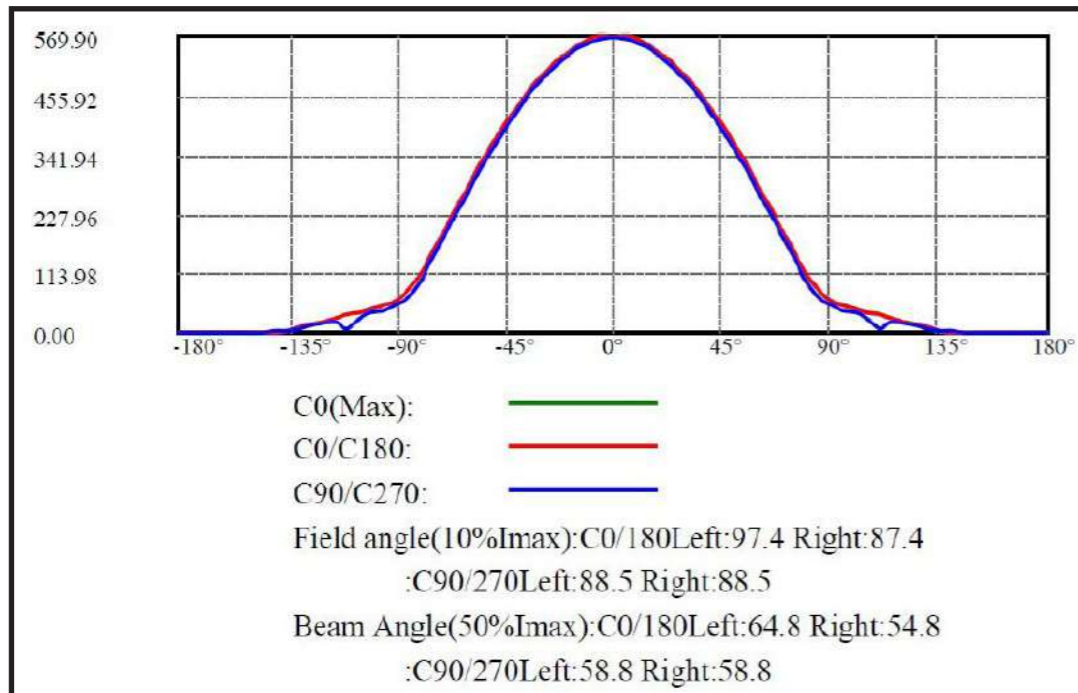
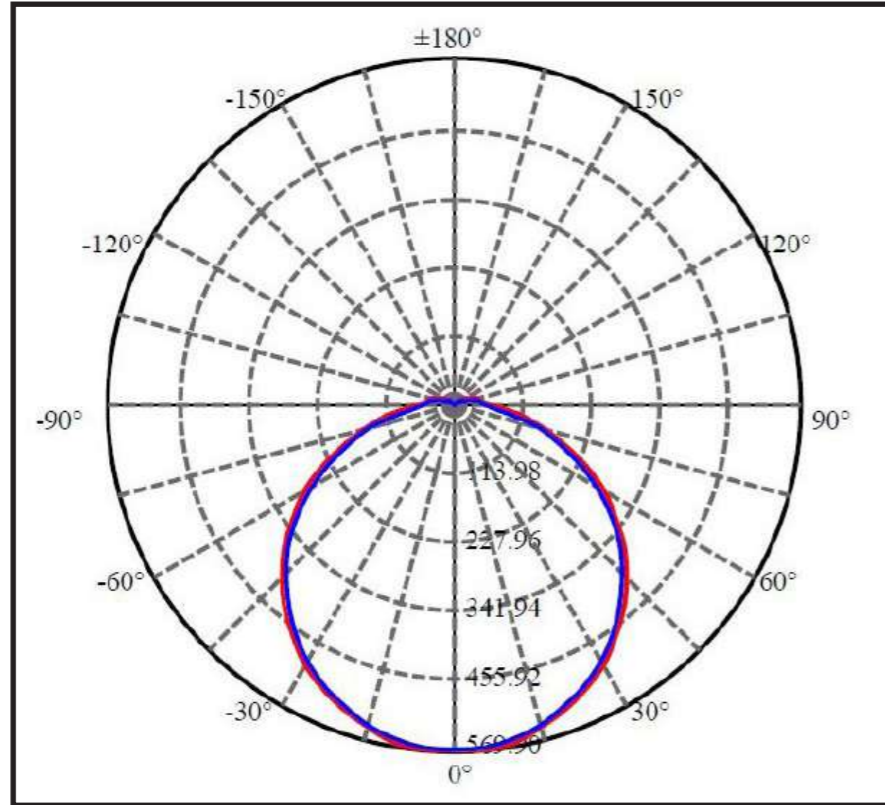

Cone Lux Diagram

SLEL-LB-20

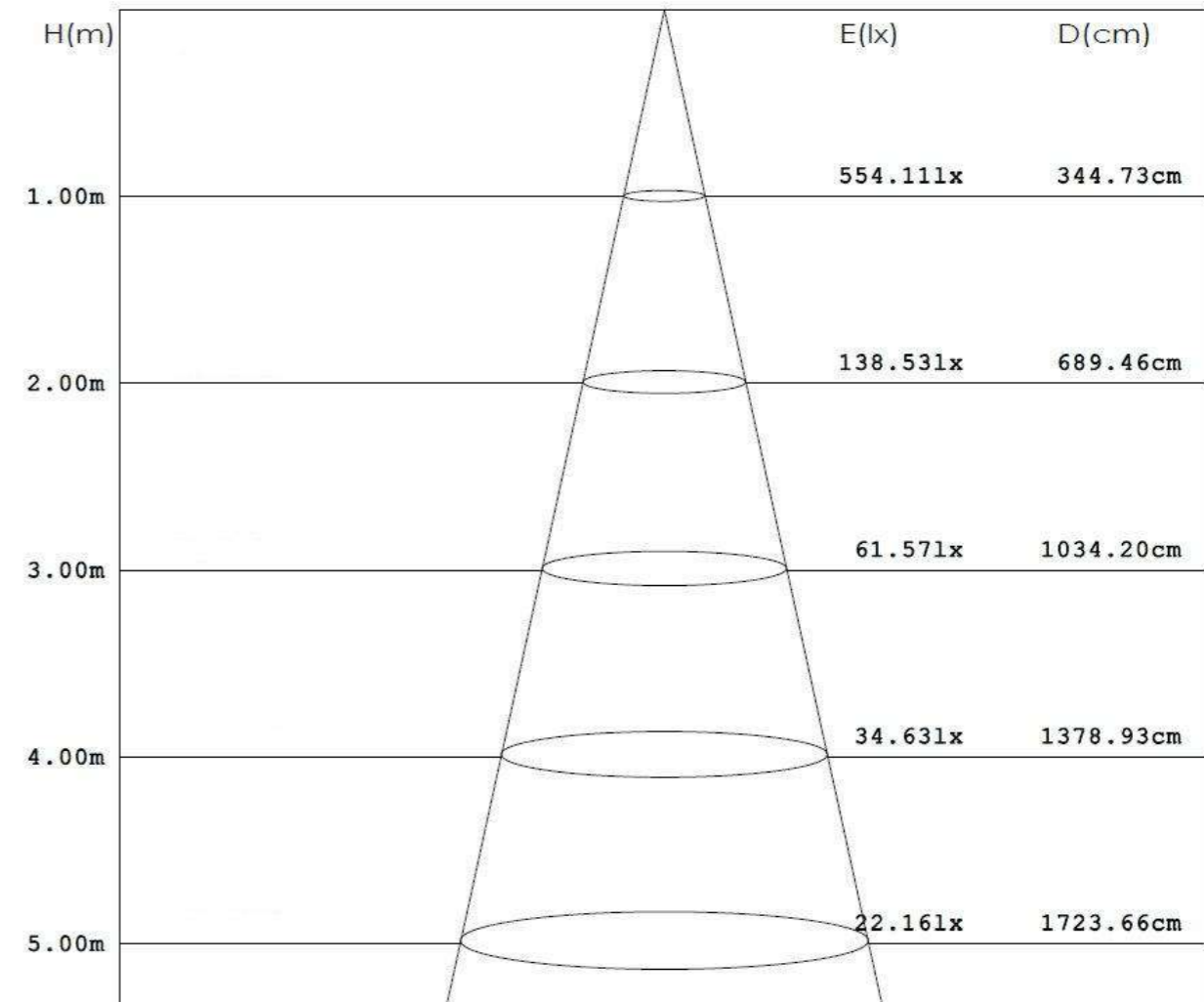

Max , Ave Beam angle 119.8°

Motion Sensor Information

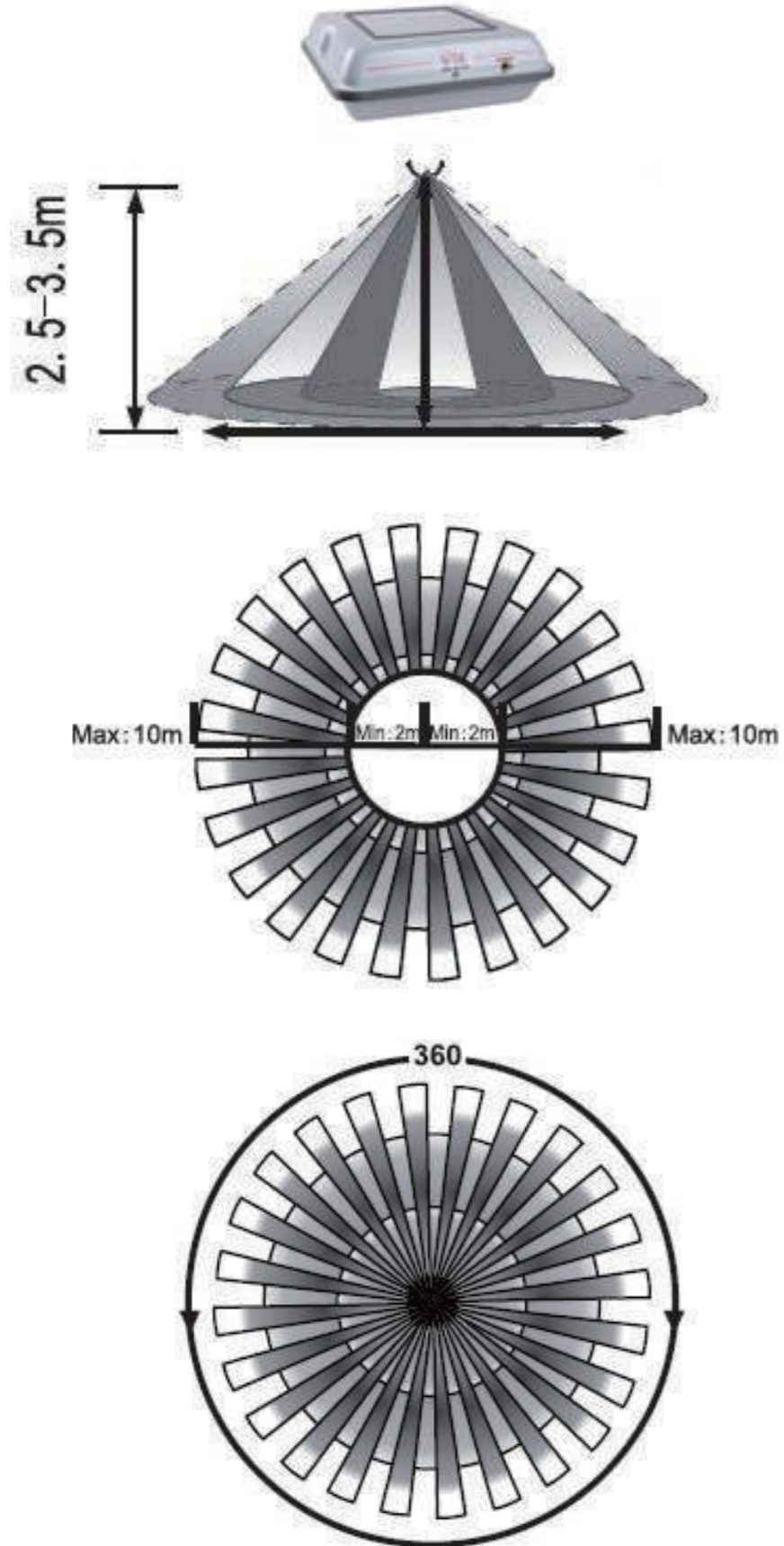

Product Dimension

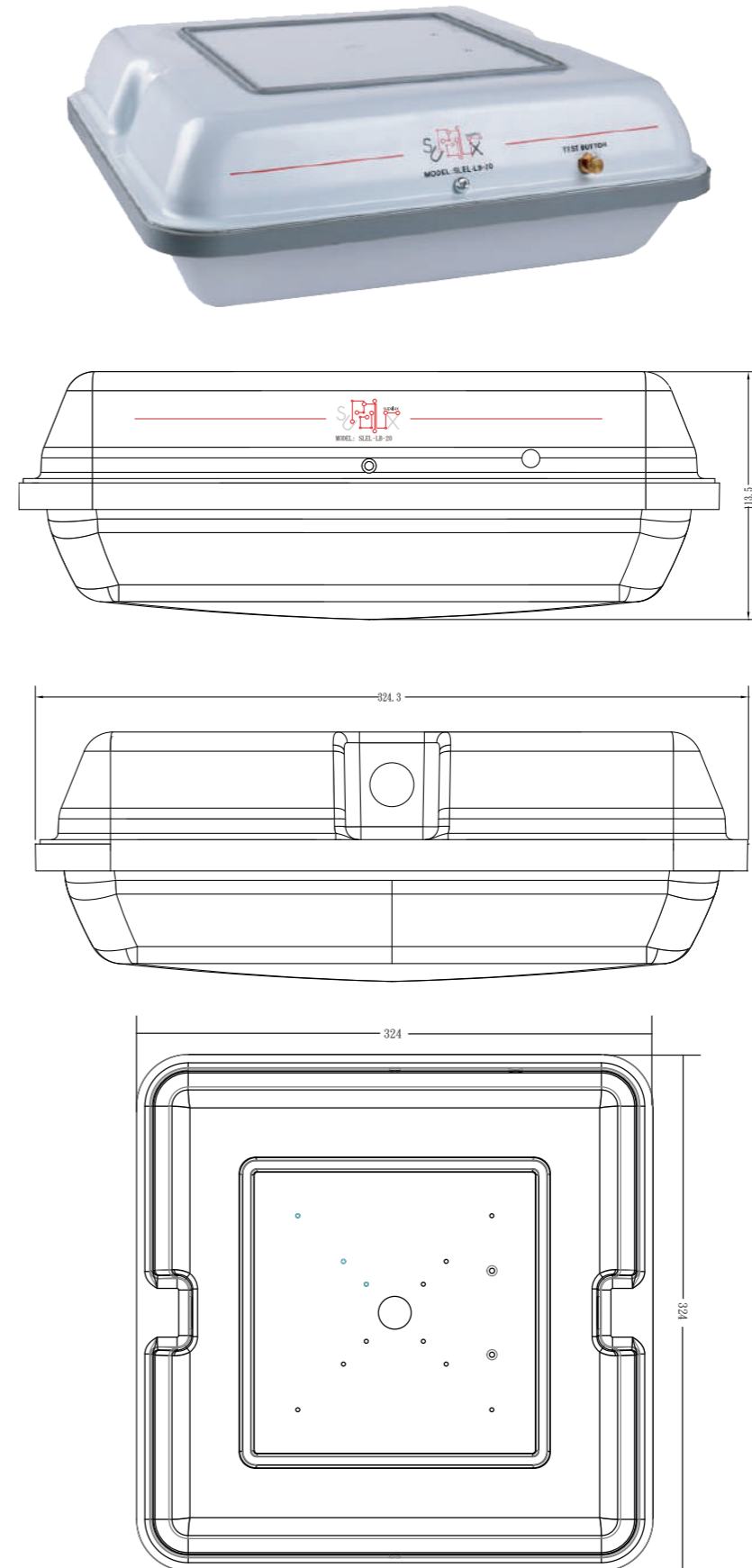



LED Chip LM80

Lifetime Prediction

Test Results Summary:

Summary	I	II	III
Condition	Ts=54.6°C Ta=53.8°C R.H.<65% IF=120mA	Ts=84.3°C Ta=83.7°C R.H.<65% IF=120mA	Ts=104.5°C Ta=104.6°C R.H.<65% IF=120mA
Duration (hour)	10000		
Interval (hour)	0, 1000, 2000, 3000, 4000, 5000, 6000, 7000, 8000, 9000, 10000		
Sample number	20		
Average Lumen Maintenance at 10000 hour	94.20%	91.86%	90.58%
Average Chromaticity Shift u'v' at 10000 hour	0.0042	0.0052	0.0059
Failure	0		
α	7.283E-06	1.140E-05	1.103E-05
β	1.018	1.035	1.009
Calculated L70 (10k) (hours)	51000	34000	33000
Reported L70 (hours)	51000	34000	33000

Equipment Used for Testing:

Equipment	Model	Equipment No.
DC Power Supply	IT6122	BSTNX001
Power meter	WT210	BSTNX001
Spector radio meter	SPEC300	BN067
0.3m Integrating Sphere	--	BSTNX002



General Parameters

Model No.	SLEL-LB-20	SLEL-LB-24	SLEL-LB-30
Power Consumption (W)	20w	24w	30w
Total Lumen Output	> 80 lm/w		
Input Voltage	AC 100V-277V, 50/60Hz		
CRI	80		
CCT	3000k / 4000k / 6000k		
Beam Angle	120 °		
Power Factor	> 0.94		
Working Temperature	-10°C~ 55°C		
IP Rating	IP65		
LED Chip	SAMSUNG		
Product Size (L x W x H)	324 x 324 x 115(mm)		
Product Weight	3.36kg		
Product Standard	RoHS IP65 CE EMC LVD LM79 TM21		
Product Warranty	3 Years limited warranty		

Product Certifications and Standards				
Standard	RoHS	IP65	EMC	LVD
<u>Certificate Standard</u>	IEC 62321	IEC 60529	EN 55015: 2013	IEC 60598-1: 2015
			EN 61547: 2009	IEC 60598-2-1: 1989
			EN 610003-2: 2014	IEC 60598-2-22: 2014
			EN 610003-3: 2013	IEC 62471: 2008
				EMF 62493: 2015
				IEC 62778
				IEC 62031: 2008
				IEC 61347-1: 2015
				IEC 61347-2-13: 2014
				IEC 62384



SPECIFICATION	
Model No.	SLEL-LB-20
CCT	3000K / 4000K / 6000K
Emergency Output	30%
Luminaires Type	Maintained / Non-Maintained Type
Light Source	 SAMSUNG LED CHIPS
Housing	Aluminum
Input Voltage	AC 100V-277V, 50/60Hz
Rechargeable Battery	Ni-MH 12V 1200mAh
Total Power Consumption	20W
Battery Recharge Duration	≤ 12 hours
Emergency Duration	≥3 Hours
Beam Angle	120°
Protection Rating	IP65
Insulation Class	Class one Earthing
Operation Temperature	-10°C~55°C
LED Operating Life	≥50000 Hours
Battery Charge & Discharge Life Span	Approx. 4 year
Outside Features	"Test" switch
Test Button	Press type
LED "On" Indicator	<ul style="list-style-type: none"> ● "Green" LED "ON" Charging ● "Green" LED "OFF" Fully Charge ● "Yellow" LED "Flashing" Battery / Lamp Fault ● "Red , Green" LED "ON" & "Yellow" LED "Flashing" Self-test Fault ● "Red" LED "ON" Main ● "Red" LED "Flashing" indicating self-testing
Self-Test Function	<ul style="list-style-type: none"> • System timer will start to count once the mains power on. • Self-Testing will work automatically on every 30 Days. • Red LED indicator will be flashing during self-testing. • Time schedule for the battery discharging is follow FSD PPA 104(A) 4th Revision as below: - Monthly: Not exceeding one quarter of rated duration
Motion Sensor Induction Range	10M Max
Testing Standard	HKFSD Codes of Practice for minimum service installations and equipments *FSD PPA 104(A) (4th Revision) *BSEN 60598-2-22:2008, BSEN 61347-2-7, *BS 5266-1:2012,Rohs,IP65,CE,EMC,LVD,LM79,TM21



Ordering Option

MODEL NO.	OPTION	SEPCIFICATION
SLEL-LB-20	A	LED FITTING ONLY
SLEL-LB-20	B	LED FITTING WITH EMERGENCY KIT
SLEL-LB-20	C	LED FITTING WITH MOTION SENSOR
SLEL-LB-20	D	LED FITTING WITH EMERGENCY KIT & MOTION SENSOR

Motion Sensor & Setting Mode Option:

OPTION	MOTION SENSOR OPERATION SPECIFICATION WHEN POWER ON
1	100% fully on light mode when detection of moving objects within setting parameter. Time mode for 5 mins, then 100% fully off when detection of objects leave the detection parameter or the object are in steady mode.
2	30% on light mode, standby mode. 100% fully on when detection of moving objects within setting parameter. Time mode for 5 mins until the objects leave the detection parameter or the object are in steady mode.

Package Details

Name	
Carton Size	36X35X15CM
Q.T.Y/Carton	1PC
G.W	4.0KGS

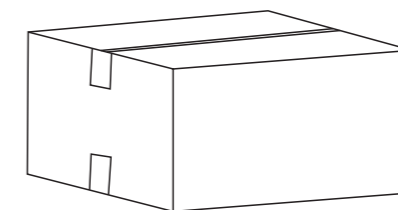
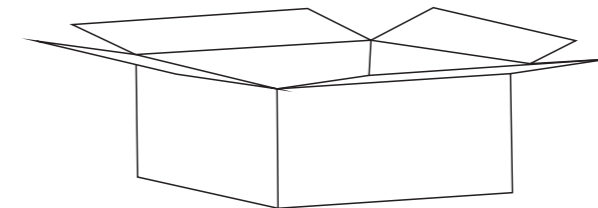
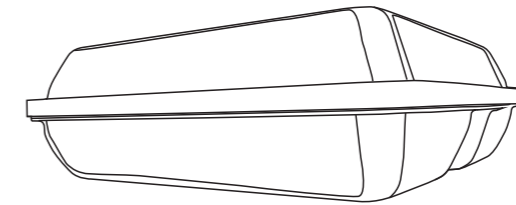

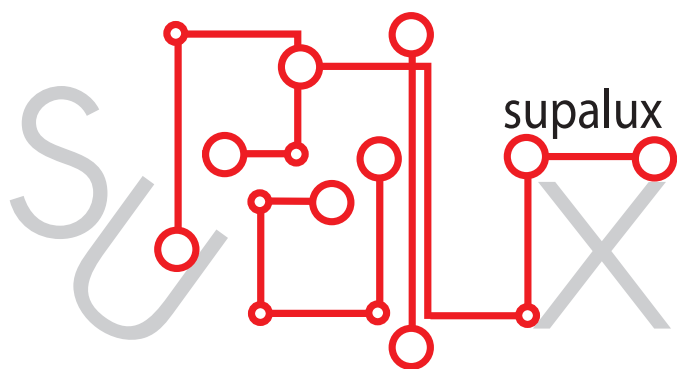

Web Site
<http://www.sl-led-application.com>

Hong Kong Authorized Distributor

Venture Company

Tel
852 - 2871 1119

Fax
852 - 2874 7677

Address
Flat 253-254, 2/F, Sino Industrial Plaza,
9 Kai Cheung Road, Kowloon Bay, Kowloon, HK